

GripperNews

The production process is gripped: FIPA Grippers make it possible!
 Realize your Pick-and-Place-solution with our innovative ideas.

Gripper Mini GR04.090

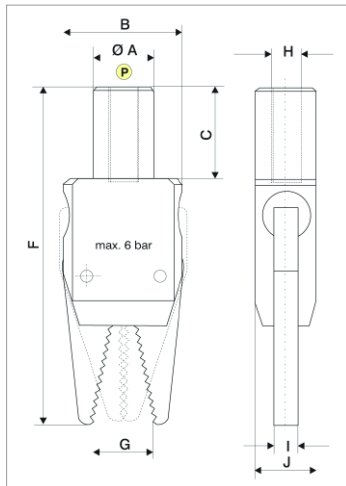

Benefits.

- > The smallest gripper on the market
- > Ideal for very small products, e.g. sprues
- > Very low weight (only 15 g)
- > Large opening of gripper jaws (10 mm)
- > Great holding power (15 N)
- > Ribbed surface of gripper jaws enable safe gripping
- > Very little use of compressed air
- > Clamp-Ø 10 mm is ideal for integration into gripper systems
- > Covered reset spring: sprue cannot get stuck
- > Hard coated surface of gripper and gripper jaws – extremely resistant to wear



Art.Nr.	A	B	C	F	H	I	J	weight
GR04.090	Ø 10	20	15	56	M5	4	10	15 g

Gripper GR04.100 | 101 | 102

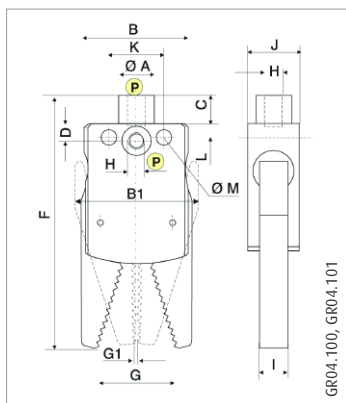

Benefits.

- GR04.100**
- > Low weight (see table)
 - > Large opening of gripper jaws (see table)
 - > High holding power (22 N)
 - > Jagged surface of gripper jaws enable safe gripping
 - > Covered reset spring: sprue cannot get stuck
 - > Hard coated surface of gripper and gripper jaws – extremely resistant to wear
 - > Connection for compressed air optionally on clamp shaft or housing (ideal for cramped spaces)

GR04.101 additional benefits.

- > Polling possibility through sensor

GR04.102 additional benefits.

- > Double action version for quick timing

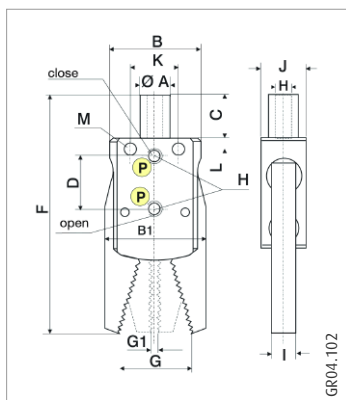

Art.Nr.	A	B	B1	C	F	G	G1	H	I	J	K	L	M	Gewicht
GR04.100	Ø 10	30	35	15	80	20	1,0	M5	8	15	16	4	Ø4,3	50 g
GR04.101	Ø 10	30	35	15	80	20	1,0	M5	8	15	16	4	Ø4,3	50 g
GR04.102	Ø 10	30	35	15	80	23	1,0	M5	8	15	16	4	Ø4,3	50 g

Gripper **GR04.130 A|B|C|D|E**



Benefits.

GR04.130 A

- > Low weight (see table)
- > Large opening of gripper jaws (see table)
- > High holding power (95 N)
- > Jagged surface of gripper jaws enable safe gripping
- > Covered reset spring: sprue cannot get stuck
- > The M17 x 1 thread connection makes it possible to use extension tube GR 06.022
- > Hard coated surface of gripper and gripper jaws – extremely resistant to wear
- > Compressed air coupling G 1/8"

GR04.130 B additional benefits.

- > Because of special geometry of the gripper jaws for instance suited for diagonal sprues or sprues up to 20 mm

GR04.130 C additional benefits.

- > Special gripper jaws can be attached to the gripper

GR04.130 D additional benefits.

- > Polling possibility through sensor

GR04.130 E additional benefits.

- > Polling possibility through sensor
- > Because of special geometry of the gripper jaws for instance suited for diagonal sprues or sprues up to 15 mm

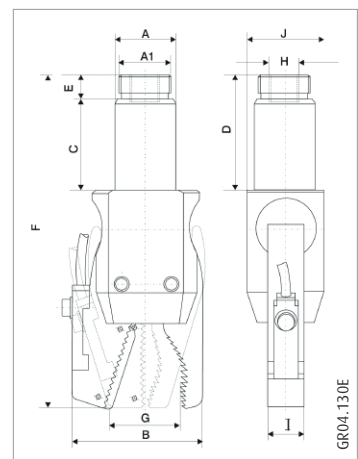
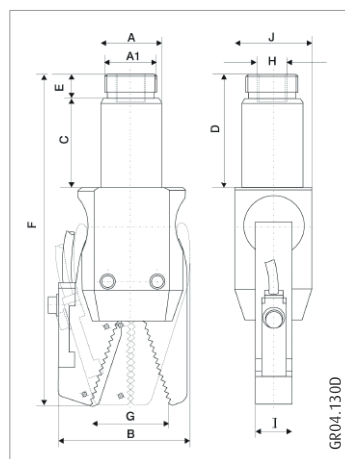
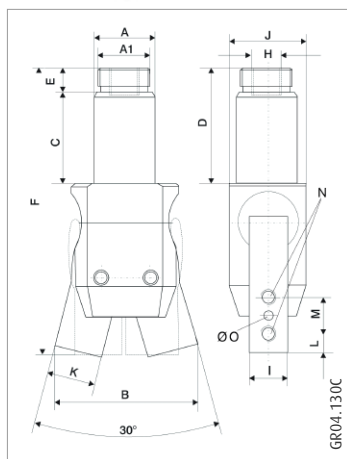
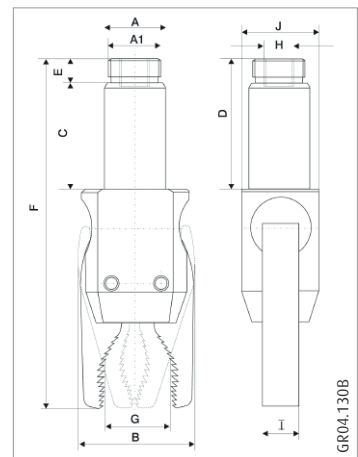
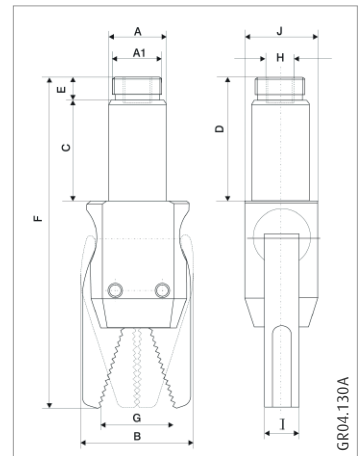

Art.No.	A	A1	B	C	D	E	F	G	H	I	J	K	L	M	N	O	weight
GR04.130A	Ø 20	M17x1	37	35	43	8	115	23	G1/8	12	25						115 g
GR04.130B	Ø 20	M17x1	37	35	43	8	115	22	G1/8	12	25						115 g
GR04.130C	Ø 20	M17x1	46,5	35	43	8	99,5		G1/8	12	25	16,5	6	12	M5	Ø3	110 g
GR04.130D	Ø 20	M17x1	43	35	43	8	115	23	G1/8	12	25						125 g
GR04.130E	Ø 20	M17x1	42	35	43	8	115	22	G1/8	12	25						120 g