

21110 - 21111

Three-jaw drill chucks



Type

Type Prima

With **gear rim** and key, jaws and key hole hardened.

21110

Type

Heavy-duty industry type. With tapered mounting hole in compliance with DIN 238.

Use

For clockwise and counterclockwise operation.
For stationary and manual electric hand drills.

21111

Type

Industrial type

Use

For clockwise and counterclockwise operation.
Mainly for manually operated drilling machines.



21110 - 21111

Clamping-width mm	Inner taper DIN 238	Outside Ø mm	Key size	21110	...	21111	...
0.5 - 4.0	B 10	24.0	S 1	101			
0.5 - 6.5	B 12	29.5	S 1	103			
0.5 - 6.5	B 10	29.5	S 1			103	
0.5 - 8.0	B 10	29.5	S 1			104	
0.5 - 8.0	B 12	29.5	S 1			105	
0.8 - 10.0	B 12	34.5	S 2A			106	

Clamping-width mm	Inner taper DIN 238	Outside Ø mm	Key size	21110	...	21111	...
1.0 - 10.0	B 16	42.8	S 2A	109			
1.5 - 13.0	B 12	42.8	S 2A			107	
1.5 - 13.0	B 16	42.8	S 2A			111	
1.0 - 16.0	B 18	56.5	S 3	113			
3.0 - 16.0	B 16	50.0	S 3			112	
5.0 - 20.0	B 22	65.0	S 4	114			

21112 - 21113

Three-jaw drill chucks



Type

With **gear rim** and key, jaws and key hole hardened.

21112

Type Prima

Type

Industrial type with threaded mounting hole.

Use

For clockwise operation of manually operated electric hand drills and electric impact drills.

Note:

21112 107, 21112 109 and 21112 111 **for clockwise and counterclockwise operation** (through-hole).

21113

Type Prima-Mat

Type

Industrial type with threaded mounting hole and

Eccentric clamping force safety device.

Use

For electric impact drills with higher impact frequency.



21112 - 21113

Clamping width mm	Thread support	Outside Ø mm	Key size	21112	...	21113	...
0.5 - 8.0	3/8 Inch x 24	29.5	S 1	104			
0.8 - 10.0	3/8 Inch x 24	34.5	S 2A	107			
0.8 - 10.0	1/2 Inch x 20	34.5	S 2A	109			
1.5 - 13.0	1/2 Inch x 20	42.8	S 2A	110			

Clamping width mm	Thread support	Outside Ø mm	Key size	21112	...	21113	...
1.5 - 13.0	1/2 Inch x 20	42.8	S 2A	111			
1.5 - 13.0	1/2 Inch x 20	42.8	S 2AT			101	
3.0 - 16.0	5/8 Inch x 16	50.0	S 3T			102	
3.0 - 16.0	M 18 x 2.5	50.0	S 3T			103	

21115

Spare Keys

Use

For drill chucks with gear rim.

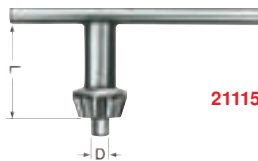

21115



21115 204

Size	D mm	L mm	21115	...
S 1	4	30	201	
S 2A	6	41	202	
S 2AT	6	42	204	

Size	D mm	L mm	21115	...
S 3	8	50	206	
S 3T	8	51	207	
S 4	9	55	208	

21118

Precision Drill Chucks with Gripping Force Retention

Type

Thanks to its special construction suitable for highest torque values (chucking forces). Strict quality control **guarantees a true-running accuracy of 0.05 mm**. Thanks to clamping force amplification the chucking force is doubled.

Use

Particularly suitable for machining centres, NC and CNC machines. **For clockwise and counterclockwise operation.**



21118

Clamping range mm	Internal taper DIN 238	Outside Ø mm	Torque kp/cm	21118	...
0 - 13	B 16	51.5	400	101	



Drill chucks

21120

Quick-Action Three-Jaw Drill Chucks

Type

Industrial type Self-chucking, keyless. For clamping and unclamping by hand. **Only for clockwise operation.**

21120



Clamping width mm	Internal taper DIN 238	Outside Ø mm	Length mm	21120	...
1 - 10	B 12	36.1	76.2		103
1 - 16	B 16	50.9	114.4		105
1 - 16	B 18	51.0	114.8		107

21121 - 21123

Quick-Action Three-Jaw Drill Chucks



Type Supra

Type

Self-chucking, keyless. For clamping and unclamping by hand. Chuck tightens automatically during drilling. **Only for clockwise operation.**

21121

Type

Heavy-duty industry type, with tapered mounting hole in compliance with DIN 238.

Use

For upright drilling machines.

Note:

B18 V shortened by 7 mm.

21122

Type

Lightweight Industrial type, with tapered mounting hole in compliance with DIN 238.

Use

Mainly for manually operated drilling machines.

Note:

B16 V shortened by 2.5 mm.

21123

Type

Standard-duty type, with threaded mounting hole.

Use

For electric hand drills.

21121



Clamping width mm	Internal taper DIN 238	Threaded mounting hole	Outside Ø mm	Length mm	21121	...	21122	...	21123	...
0 - 6.5	B 10	–	32.0	65.6		102				
0 - 6.5	B 12	–	32.0	65.6		103				
0 - 8.0	B 12	–	35.8	73.4				104		
0 - 10.0	B 12	–	40.2	86.1		105				
0 - 10.0	B 16	–	40.2	89.1		106				
0.5 - 10.0	–	1/2 inch x 20	35.8	73.7						306
0.5 - 10.0	–	3/8 inch x 24	35.8	73.7						307
1.0 - 13.0	–	1/2 inch x 20	46.0	101.5						308
1.0 - 13.0	B 16	–	46.0	101.5		107				
1.0 - 13.0	B 16 V	–	40.2	82.3				108		
3.0 - 16.0	B 16 V	–	46.0	106.0				109		
3.0 - 16.0	B 18 V	–	51.0	106.8		111				
3.0 - 16.0	–	5/8 inch x 16	46.0	97.5						313

21125

Quick-Action Three-Jaw Drill Chucks



Type Supra ST

Type

Self-chucking, keyless. Chuck tightens automatically in proportion to cutting force. Gripping force retains even under heavy-duty conditions. With clamping force retention.

Use

For clockwise and counterclockwise operation.

Note:

B16 V shortened by 2.5 mm.

21125



Clamping width mm	Internal taper DIN 238	Threaded mounting hole	Outside Ø mm	Length mm	21125	...
0.5 - 10	B 12	–	40.0	75.7		301
0.5 - 10	–	1/2 inch x 20	40.0	73.7		302
1.0 - 13	–	1/2 inch x 20	42.8	83.3		303
1.0 - 13	B 16 V	–	42.8	89.3		304

21126

Quick-Action Three-Jaw Drill Chucks



Type Spiro

Type

Precision type, self-chucking, keyless. Pointed sleeve shape, high true-running accuracy, hardened wear parts.

Use

Thanks to automatic re-chucking during drilling, particularly suitable for high rotational speed applications on electric hand drills, upright drilling machines and special drilling units.

21126 303-304

Type

Additionally with gripping force retention.

Use

For clockwise and counterclockwise operation.

21126 101



Note:

B18 V shortened by 7 mm.

Clamping width mm	Internal taper DIN 238	Outside Ø mm	Length mm	21126	...
0 - 4.0	B 10	28	53.3		101
0 - 6.5	B 10	35	68.6		102
0 - 6.5	B 12	35	68.6		103
0 - 8.0	B 12	38	76.9		104
0 - 10.0	B 12	43	90.1		105
0 - 10.0	B 16	43	90.1		106
1 - 13.0	B 16	50	102.5		108
3 - 16.0	B 16	55	106.8		109
3 - 16.0	B 18 V	55	106.8		110
0 - 10 ST	B 16	43	88.5		303
1 - 13 ST	B 16	43	100.3		304

21127 - 21128

Keyless Drill Chucks (Plastics)



Type

force transmission with fine thread, **chucking sleeve made of plastics**, holding fixture made of steel, high true-running accuracy. With hexagonal end for mounting onto the spindle.

Use

For clockwise and counterclockwise operation. for rechargeable battery drills and electric hand drills.

21127

Type

Type Extra, through-hole, with holding ring.

21128

Type

Type Extra RV, with radial locking, through-hole, with holding ring, impact-proof. Chucking capacity 1.5-13 mm jaws with carbide chucking bevel.

21127 - 21128



Clamping width mm	Thread support	Outside Ø mm	max. machine power/W No. 21127 / No. 21128	21127	...	21128	...
1.0 - 10	3/8 inch x 24	42.7	450 / 550		101		101
1.0 - 10	1/2 inch x 20	42.7	450 / 550		102		102
1.5 - 13	3/8 inch x 24	42.7	550 / 1000		103		103
1.5 - 13	1/2 inch x 20	42.7	550 / 1000		104		104

21130

Keyless Drill Chucks (Metal)



Type

Type Extra-RV, with radial locking, **chucking sleeve made of Metal**, with self-start protection and hexagonal end for mounting and removing from the spindle.

Use

For clockwise and counterclockwise operation. For hand drills with rechargeable battery and electric screwdrivers and hand drills.

21130 101-102

Type

Through-hole.

21130 103

Type

Through-hole. Jaws with carbide chucking bevel.

21130 104

Type

No through-hole.

Jaws with carbide chucking bevel.

21130 101

21130 103

Clamping width mm	Threaded mounting hole	Outside Ø mm	max. machine power W	21130	...
1.0 - 10	3/8 inch x 24	42.7	550		101
1.0 - 10	1/2 inch x 20	42.7	550		102
1.5 - 13	1/2 inch x 20	42.7	1100		103
1.5 - 13	1/2 inch x 20	42.7	1100		104



21151 - 21152

High-Performance Three-Jaw Drill Chucks SBF

ALBRECHT

Präzisions Spannfutter

Type

Keyless, clamping and unclamping by hand, chuck tightens automatically during drilling. **Only for clockwise operation.** All wear parts are case-hardened, ground and replaceable. 100 % concentricity test with different taper plug-diameters at different measuring heads based on DIN ISO 10888.

21151

Type

Type SBF Super-drill chuck, Standard type.

Note:

B 18 = inside taper shortened by 7 mm.

21151 201

Type

with vernier for presetting.

21152

Type

Type NCBF Special type, with clamping guard.

Use

for quick-braking spindles of NC, CNC machines, etc.

Note:

B 18 = inside taper shortened by 7 mm.



21151

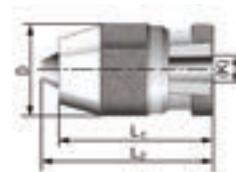

21152

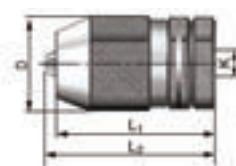

Clamping width mm	Internal taper DIN ISO 239 B	D mm	L ₁ mm	L ₂ mm	21151	...	21152	...
0 - 1,5	B 6	19	35,0	37,5		201		
0 - 3,0	B 10	24	44,0	47,5		202		
0 - 6,5	B 10	34	61,5	68,0		205		
0 - 6,5	B 12	34	61,5	68,0		206		
0 - 10,0	B 12	43	80,0	91,0		208		
0 - 10,0	B 16	43	80,0	91,0		209		
1 - 13,0	B 16	50	90,5	103,0		210		102
3 - 16,0	B 16	56	95,5	109,0		211		
3 - 16,0	B 18	56	95,5	109,0		212		104

21156 - 21157

Micro/Mini-Universal drilling and milling chuck

ATORN®

Type

- Cylindrical extensions in 2 sizes
- Can be balanced for speeds of up to 60,000 rpm

- High holding forces
- High concentricity precision

Advantages:

- Small interference contour
- Safe and fast handling

Use

For milling and drilling in precision mechanical and electrical sector, horology industry, medical products etc.

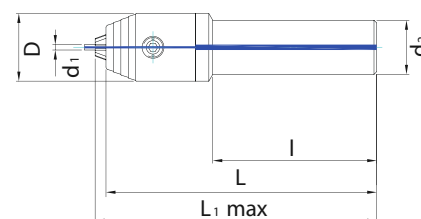

Micro-Universal							
Shank d2 mm	L mm	L ₁ max. mm	Clamping width mm	D mm	I mm	21156	...
16	80	83	0.2 - 3.4	19	50		101
16	100	103	0.2 - 3.4	19	70		102
16	160	163	0.2 - 3.4	19	130		103
20	80	83	0.2 - 3.4	19	52		104
20	100	103	0.2 - 3.4	19	72		105
20	160	163	0.2 - 3.4	19	132		106

Mini-Universal							
Shank d2 mm	L mm	L ₁ max. mm	Clamping width mm	D mm	I mm	21157	...
16	100	104	0.2 - 6.4	25	60		101
16	150	154	0.2 - 6.4	25	110		102
16	200	204	0.2 - 6.4	25	160		103
20	100	104	0.2 - 6.4	25	60		104
20	150	154	0.2 - 6.4	25	110		105
20	200	204	0.2 - 6.4	25	160		106



21156



21157

21154

AMC drill chuck extensions with cylindrical shank

ALBRECHT

Präzisions Spannfutter

Type

Very slim for machining areas with difficult access.

Use

For clamping in all precision chucks.
For clamping smallest of tools.

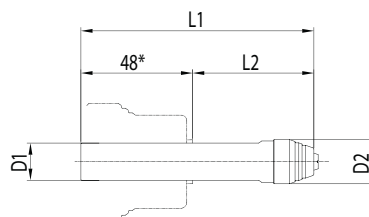

Clamping range mm	D1 mm	D2 mm	L1 mm	L2 mm	21154	...
0.2 - 1.5	10	20	76	34		101
1.5 - 3.0	10	20	76	34		102
0.2 - 1.5	16	20	100	52		103

Clamping range mm	D1 mm	D2 mm	L1 mm	L2 mm	21154	...
1.5 - 3.0	16	20	160	112		104
0.2 - 1.5	16	20	100	52		105
1.5 - 3.0	10	20	160	112		106



21154

DIN
6535
HA

21155

Fine Drilling Aids

ALBRECHT

Präzisions Spannfutter

Type

With centring pivot B 6 for drill chuck
cat.-no. 21151 201, fine drilling aid without drill
chuck, drilling depth = 20 mm. A spring-loaded
system returns the chuck to the starting position.

Use

For highly accurate drilling of very small holes
by hand, also suited for large machines.

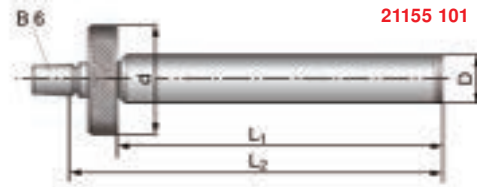

21155 101

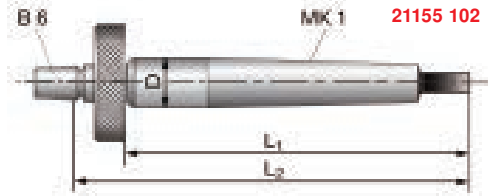

21155 102

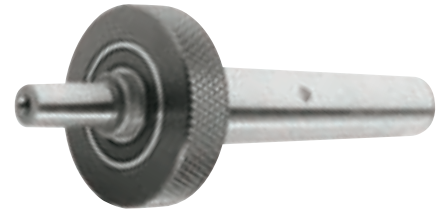

Shank	Ø D mm	Ø d mm	L ₁ mm	L ₂ mm	21155	...
13 mm Ø	13	30	66	80		101
MT 1	12	30	82	96		102

21160

Chuck-Ejector Forks

ALBRECHT

Präzisions Spannfutter

Use

For easy separation of the chuck from its mount.
Prevents damage to spindle or chuck.

21160

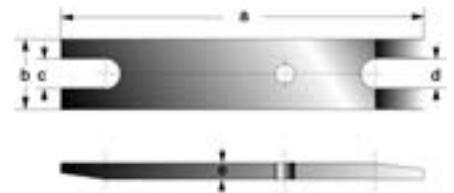

for B taper	a mm	b mm	c mm	d mm	e mm	21160	...
B 6	120	20	7.0	–	8		101
B 10, B 12	170	30	11.0	13.0	10		102
B 16, B 18	210	40	16.7	18.7	12		103



21170

Plug-in journals

Type

With taper in compliance with DIN 238, for mounting
of chucks. Hardened and ground.

21170

MT/drill chuck Taper	21170	...
1/B 10		201
1/B 12		202
1/B 16		203
2/B 10		210
2/B 12		211
2/B 16		212
2/B 18		213

MT/drill chuck Taper	21170	...
3/B 12		220
3/B 16		221
3/B 18		222
3/B 22		223
4/B 16		231
4/B 18		232
5/B 18		242



21177

Plug-in journals

Type

With mounting taper in compliance with DIN ISO
239 B, with **straight shank**. Precision guiding with
a true-running accuracy small equal to 2 µm.

21177

Mounting taper	Ø x Length mm	21177	...
B 12	10 x 50		101
B 16	12 x 60		102
B 16	16 x 50		103
B 18	16 x 70		104

