

Distance Couplings I Installation

Installation:

The split-hub design allows for easy assembly. Further simplification during installation is provided because one half of the split hub is screwed onto the pipe. This allows resting the coupling on the two shaft ends. The second half of the split-hub can then be mounted to the coupling by screwing it on from below with the specified tightening torque. This feature makes a “one man assembly” possible even with extremely long couplings. During maintenance, EKZ/ WDS/WDE couplings can be exchanged without disassembling the drive or output units.

Formula for length determination:

$$L = A + t_1 + t_2 \quad [\text{mm}]$$

A = shaft separation ± 1
t = plug in depth ± 1
(see data sheets)

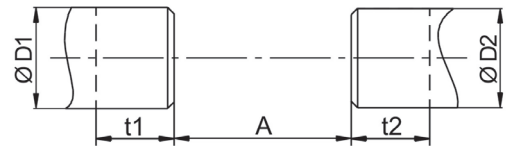

Series EKHZ

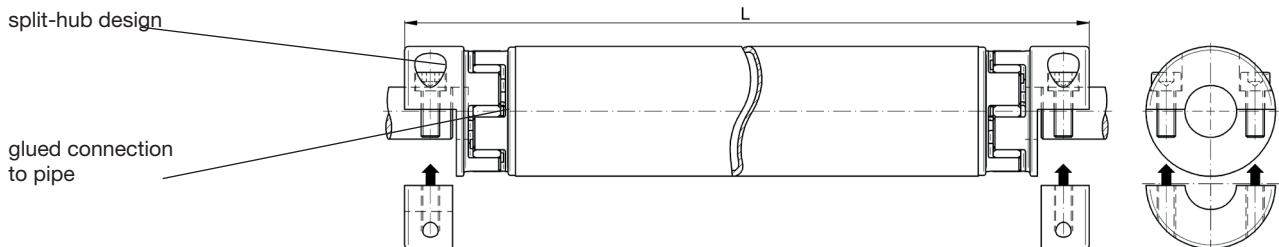

Series WDS

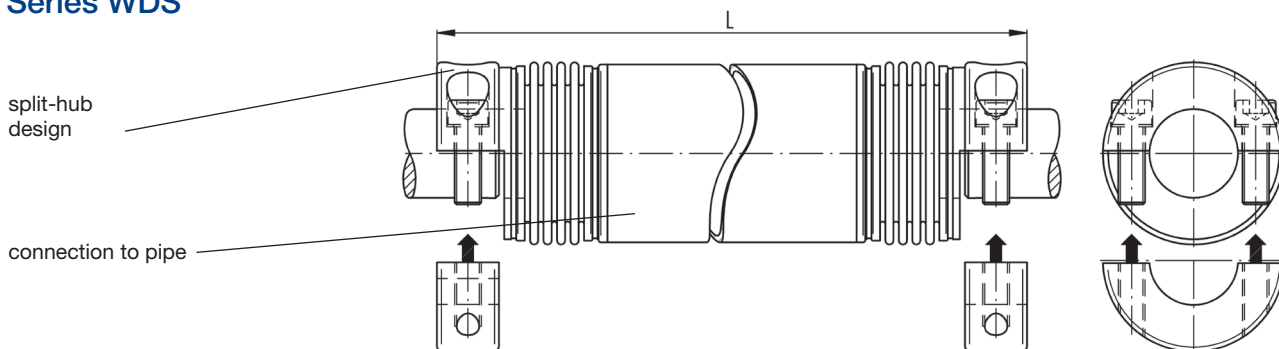

Series WDE / WD-VA

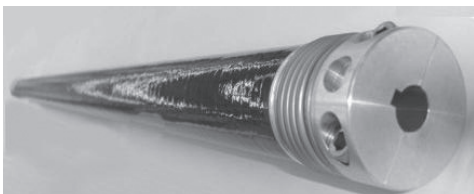
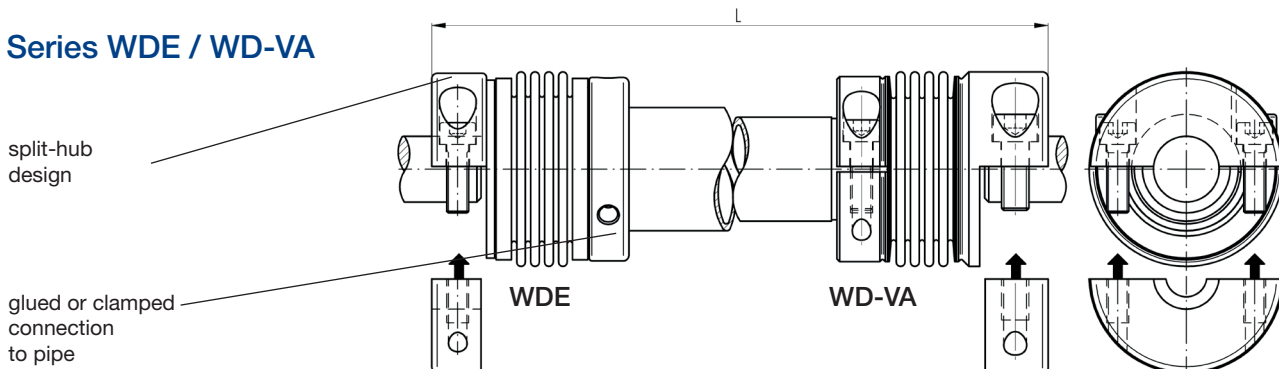

Note: The intermediate pipe can be delivered in different materials and section thicknesses, as well as in straightened and balanced quality for high speeds. At high speeds and concurrent long pipe length, a customized and optimized intermediate pipe made from CFC will be used (see picture to the left).