

MACHINE MODEL

CUBO 400 NC BOX

Automatic bandsaw with CNC, 7" touch screen

Short description

CUBO 400 NC BOX is an automatic sawing machine belonging to the innovative CUBO SERIES. The sawing machine is a reliable ,safe and easy to use work tool due to the 7 " touch screen display with the possibility of managing the cutting process remotely via INDUSTRY 4.0 READY.



Cutting capacity at 0 °	Round: 310mm - Square: 280mm - Rectangle: 400x250mm0mm
Cutting capacity at 45 ° left	Round: 280mm - Square: 270mm - Rectangle: 300x200mm0mm
Cutting capacity at 60 ° left	Round: 210mm - Square: 200mm - Rectangle: 200x200mm0mm
Capacity with beam cutting device	Max: 300x160mm; Min. 85x10mm
Cutting capacity at 0 ° for full (C45)	250mm
Blade size lama	4020x34x1.1mm
Blade motor	2.2KW
Blade speedlla lama	18-100m/min
Minimum cuttable length in autom. cycle	15mm
Advance carriage stroke	515mm
Advance carriage motore	0,75KW
Minimal waste	80mm
Height of the work surfaceo	890mm
Weight	990kg
Dimensions	1850x2200x1990mm

Features



CUBO SERIES

CUBO is the line of automatic saws developed to optimize the user experience thanks to the introduction of various stylistic and functional innovations. Ease of use and operator safety during the cutting process make it the ideal work tool for any work environment.



Touch screen: innovative and intuitive

Through the 7-inch touch screen display (with simple and intuitive graphics to optimize the user experience, it is possible to set and control all the machine parameters; the interface allows you to set cutting projects with different quantities and lengths on the same bar and to view any errors during the cutting process.



Numerical control and cutting management

It allows to store up to 99 cutting programs by automatically calculating the thickness of the blade, the total number of pieces to be cut, setting the cutting lengths and managing the automatic cutting cycle..

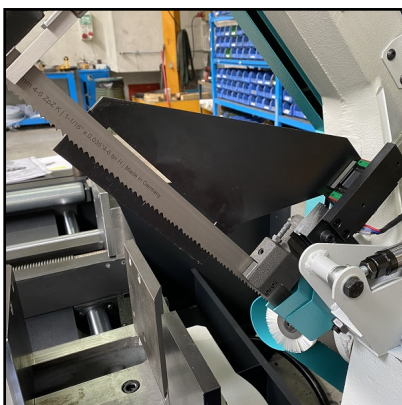

Mechanical feeler device

CUBO 400 NC BOX is equipped with a mechanical device for the automatic detection of the material and the cutting start point, optimizing the cutting process and the setting of the first cut. The management of the end of the cut is instead guaranteed by a microswitch.



Security and accessibility

CUBO 400 NC BOX has an integrated protection system on all sides of the machine to ensure maximum operator safety during cutting. The protection system does not prevent complete accessibility to all internal parts (movable and not) of the machine in case of maintenance.



Advance carriage

Feeder movements on chrome bars high-precision of the positioning due to the incremental feeding on recirculating ball screw by self-braking electric motor with inverter .



Speed variator

All CUBO SERIES automatic sawing machines (in the BOX and FLAT versions) are equipped with an inverter speed variator as standard.



Cleaning the blade

To keep the blade clean and prevent material chips from compromising the quality of the cut, the IMET semi-automatic and automatic saws are fitted as standard with a motorized blade cleaning brush with nylon teeth.



Industry 4.0 Ready - SAWFACTORY (Optional)

OPTIONAL

All CUBO Series automatic saws can be connected to the company network via modem: the dedicated software SAWFACTORY is also available for remote service, assistance, programming and remote management of the cutting process. The software allows to transfer data and programs from the PC (where the program is created) to the machine via USB. Discover SAWFACTORY: <https://bit.ly/2RuxHuX>

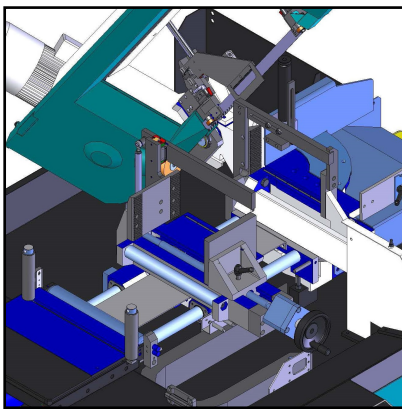

Bundle cutting device (Optional)

OPTIONAL

The CUBO automatic band saws in the BOX version can be used with the bundle cutting device. The bundle cut can only be used for 0° cutting. Single piece capacity with mounted device: 350x160mm max, 55x10mm min. Cutting capacity for bundle is: max 300x160mm, minimum 85x10mm. The device can be disassembled using the 2 screws on the fixed vice and the 2 on the carriage vice and disconnecting the hydraulic tubes using the quick couplings systems.



Minimal lubrication system (Optional)

OPTIONAL

It is possible to request for any machine the minimal lubrication which eliminates the dispersion of coolant typical in the use of emulsifiable oil, the duration of the blade is not compromised in any way. Tank capacity: 1.3 liters.



Motorized chip conveyor (Optional)

OPTIONAL

It's available for all the CUBO SERIES automatic bandsaw an optional motorized chip conveyor placed laterally (on the loading side) of the machine. The chip conveyor allows to optimize the machine efficiency by removing remainings and chips while cutting.

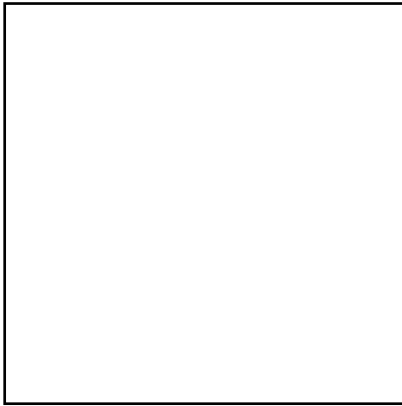

Automatic sawframe rotation (Optional)

OPTIONAL

CUBO 400 NC (Flat and Box) are compatible with the automatic sawframe rotation device. The system has mechanical stops with 2 positions and allows to optimize user workflow with mitre cutting on a same bare in automatic cycle. Link: <https://youtu.be/wZAJswt6x3Y>



Pressure reducer (Optional)

OPTIONAL

Two pressure reducers in kit for hydraulic vices are available for CUBO 350 NC BOX.



Laser ray (Optional)

OPTIONAL

To optimize your workflow, a laser ray is available to locate and mark the cut line during the process.

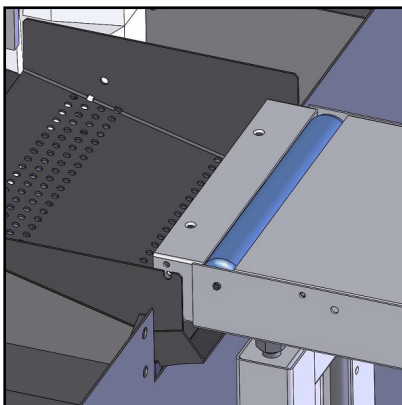

Connection for loading side (Optional)

OPTIONAL

Connection element for roller table, loading side.



Loading/unloading table with free rolls (optional)

OPTIONAL

Roller table compatible for both the loading side and the unloading side.



Loading/unloading roller table with free rolls (Optional)

OPTIONAL

Following element for loading/unloading roller table with free rolls with 1 leg.



Pair of vertical rollers (Optional)

OPTIONAL

Pair of vertical steel containment rollers. Maximum 2 pairs for each 1,5m element; to be used without roller cover.