

51001

Hexagon socket wrench set



Design

The new benchmark for ergonomics, power transmission and sensitivity!

HHW-ERGONIC high-performance lever reversible ratchet:

- With patented **ERGONIC** three-component handle with soft zone for increased comfort
- Fine toothing (72 teeth)
- 5° return angle for confined spaces
- Increased switching mechanism via DIN (> 100 Nm)
- Socket wrench with pushbutton release safety lock
- Robust and extremely slip resistant StrongBox for daily use
- Organisation system: Hard foam insert for a secure hold of the tools
- Incl. bit holder and connector 1/4 inch x E 6.3 for using the socket wrench with a cordless screwdriver (not suitable for impact!)

... Perfect and reliable without compromise!



Ergonomic handle with 3 components



Patented soft zone



Increased switching mechanism with 72-tooth fine toothing



51001

Set contents	
○	13 hex inserts Sizes 4/4.5/5/5.5/6/7/8/9/10/11/12/13/14 mm
✳	5 bits for TX® screws T 10/15/20/25/30
⬡	3 bits for hexagon socket screws Sizes 4/5/6 mm
⊖	2 bits for slotted screws 4.5 x 0.6/5.5 x 1.0 mm
⊕	3 bits for Phillips-head screws PH 1/2/3
⊕	2 bits for Phillips-head screws PZ 1/2
	1 ERGONIC reversible ratchet 150 mm, three-component handle (art. no. 51124 100)
	1 ERGONIC Stubby with three-component handle
	2 extensions 50/100 mm
	1 cardan joint
	1 adapter E 6.3 x 1/4-inch (50 mm)
	1 adapter 1/4 inch SQ x 1/4 inch hex
	1 bit holder E 6.3 x 58 mm

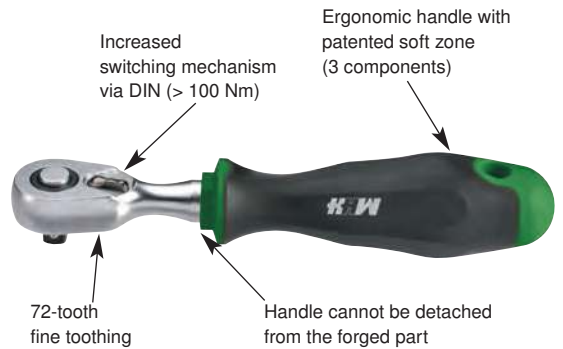

Set contents	Design	51001	...
36 pieces	in shock-resistant, non-slip plastic storage boxes (230 x 130 x 56 mm) with foam inserts		101

51002

Hexagon socket wrench set



Quality Chromium-vanadium steel.

Design

All tools are packed tightly so they cannot move around.

Set contents	
○	13 hexagonal inserts with energy profile Sizes 4/4.5/5/5.5/6/7/8/9/10/11/12/13/14 mm
1 of each	reversible ratchet, handle with sliding piece, cardan joint
2	extensions 50/105 mm

Set contents	Design	51002	...
18 pieces	in a sheet steel box with foam inserts		101



51002



Hand tools

Socket wrench sets

51022

Socket wrench set TRIPLEplus

1/4"

ATORN®
Design

High-gloss, chrome-plated.

Applications

Universal screw system for hexagon, bi-hexagon and E-TX screws and nuts.

Also fits on all common inch sizes.

Quality

Chromium-vanadium steel.

mm	hex	bi-hex	inch	★ E-TX
4.0	x	x	5/32	E 5
4.5	x	x	-	E 6
5.0	x	x	3/16	-
5.5	x	x	-	-
6.0	x	x	-	E 8
7.0	x	x	9/32	-
8.0	x	x	5/16	E 10
9.0	x	x	11/32	-
10.0	x	x	3/8	E 12
11.0	x	x	7/16	E 14
12.0	x	x	15/32	E 16
13.0	x	x	1/2	-
14.0	x	x	9/16	E 18

Set contents

13	inserts	Sizes 4/4.5/5/5.5/6/7/8/9/10/11/12/13/14 mm
7	bits for TX® screws	T 10/15/20/25/27/30/40
2	bits for Phillips-head screws	PZ 1/2
2	bits for Phillips-head screws	PH 1/2
6	bits for hexagon socket screws	Sizes 3/4/5/6/7/8 mm
5	bits for XZN multi-point screws	M 4/5/6/8/10
1	reversible ratchet	(140 mm)
1	drive handle	with plastic handle
1	extension	100 mm
1	cardan joint	
1	adapter	1/4 inch □ / 1/4 inch ○ (art. no. 52938 101)

Set contents	Design	51022	...
40 pieces	in the ABS plastic storage boxes		101

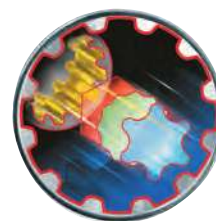
51022

51023

Hexagon socket wrench sets

1/4"
ATORN®
Design

All tools are packed tightly so they cannot move around.

Quality

Chromium-vanadium steel.

51023 101
Set contents 51023 101

12	hexagon inserts with energy profile	Sizes 4/4.5/5/5.5/6/7/8/9/10/11/12/13 mm
5	inserts for hexagon socket screws	Sizes 3/4/5/6/8 mm
2	inserts for Phillips-head screws	PH 1/2
2	inserts for Phillips-head screws	PZ 1/2
3	inserts for slotted screws	0.8 x 4/1.0 x 5.5/1.2 x 6.5 mm
1 of each	reversible ratchet, handle with sliding piece, cardan joint	
1	extension	50 mm

Set contents 51023 102

13	hex inserts with energy profile	Sizes 4/4.5/5/5.5/6/7/8/9/10/11/12/13 mm
4	hex inserts long version with energy profile	Sizes 8/10/11/13 mm
5	inserts for hexagon socket screws	Sizes 8/10/11/13 mm
3	inserts for Phillips-head screws	PH 1/2/3
3	inserts for Phillips-head screws	PZ 1/2/3
3	inserts for slotted screws	4/5.5/6.5 mm
6	inserts for internal TX® screws	T 10/15/20/25/30/40
1 of each	reversible ratchet, handle with sliding piece, cardan joint	
2	extensions	50/105 mm

Set contents	Design	51023	...
28 pieces	in a sheet steel box with foam insert		101
42 pieces	in a sheet steel box with foam insert		102

51023 102

51025

Hexagon socket wrench set



Quality

Chromium-vanadium steel.

51025

Set contents	
○	11 hex inserts Sizes 4/4.5/5/5.5/6/7/8/9/10/11/13 mm
●	6 inserts for hexagon socket screws Sizes 3/4/5/6/8/10 mm
⊖	3 inserts for slotted screws 4/4.5/5 mm
⊕	4 inserts for Phillips-head screws PH 1/2/3/4
	3 hexagon pin wrenches for hexagon socket screws Sizes 1.5/2/2.5 mm
	1 reversible ratchet
	1 handle with sliding piece
	1 drive handle with plastic handle
	1 cardan joint
	2 extensions 50/100 mm
	1 quick turn wheel

Set contents	Design	51025	...
34 pieces	in a plastic storage box		301



Hand tools

51029

Hexagon socket wrench set



Quality

Chromium vanadium.

51029 101

Design

Matt chrome-plated Plastic case made from impact-resistant, oil- and heat-resistant polyethylene (HDPE), 35 x 165 x 85 mm.

Set contents 51029 101	
○	12 hex inserts Sizes 4/4.5/5/5.5/6/7/8/9/10/11/12/13 mm
●	2 inserts for hexagon socket screws Sizes 5/6 mm
⊕	2 inserts for Phillips-head screws PH 2/2
⊛	6 inserts for TX® screws T 10/15/20/25/30/40
	1 reversible ratchet
	1 swivelling extension 100 mm
	1 bit holder with clip 1/4 inch mount

Set contents 51029 102	
○	12 hex inserts Sizes 1/8/5/32/3/16/7/32/1/4/9/32/5/16/11/32/3/8/7/16/1/2/9/16 inch
●	2 inserts for hexagon socket screws Sizes 5/6 mm
⊕	2 inserts for Phillips-head screws PH 2/2
⊛	6 inserts for TX® screws T 10/15/20/25/30/40
	1 reversible ratchet
	1 swivelling extension 100 mm
	1 bit holder with clip 1/4 inch mount

Set contents	Design	mm	...	inch	...
25 pieces	in plastic case	51029		51029	
25 pieces	in plastic case		101		102 NEW



51029 102



Socket wrench sets

51038

Hexagon socket wrench sets



Design

Chrome-plated.

Quality

Chrome alloy steel.



51038 101

Set contents 51038 101	
○	13 hex inserts with AS drive profile Sizes 3.5/4/4.5/5/5.5/6/7/8/9/10/11/12/13 mm
●	4 inserts for hexagon socket screws Sizes 3/4/5/6 mm
	1 reversible ratchet
	1 drive handle with plastic handle
	1 handle with sliding piece
	1 extension 150 mm
	1 cardan joint



Set contents 51038 104	
○	11 hex inserts with AS drive profile Sizes 5/5.5/6/7/8/9/10/11/12/13/14 mm
●	5 inserts for hexagon socket screws Sizes 3/4/5/6/8 mm
⊖	3 inserts for slotted screws 0.6 x 3.5/1.0 x 5.5/1.2 x 8.0 mm
⊕	4 inserts for Phillips-head screws PH 1/2/3/4
	1 reversible ratchet
	1 drive handle with plastic handle
	1 handle with sliding piece
	2 extensions 54/150 mm
	1 cardan joint



51038 104



Set contents 51038 107	
○	10 hex inserts with AS drive profile Sizes 5/5.5/6/7/8/9/10/11/12/13 mm
●	5 inserts for hexagon socket screws Sizes 3/4/5/6/8 mm
✳	9 inserts for internal TX® screws T8/9/10/15/20/25/27/30/40
✳	6 inserts for external TX® screws E4/5/6/7/8/10
	1 reversible ratchet
	1 drive handle with plastic handle
	1 handle with sliding piece
	2 extensions 54/150 mm
	1 cardan joint



51038 107



Set contents	Design	51038	...
22 pieces	in a robust, stackable ABS plastic box		101
29 pieces	in a robust, stackable ABS plastic box		104
36 pieces	in a robust, stackable ABS plastic box		107

51039

Hex and bi-hex socket wrench set



Design

Chrome-plated.

Quality

Chrome alloy steel.

51039

Set contents	
1/4" ○	8 hex inserts with AS drive profile Sizes 4/4.5/5/5.5/6/7/8/9 mm
●	5 bits for hexagon socket screws Sizes 3/4/5/6/8 mm
⊖	6 bits for slotted screws 0.5x3/0.6x3.5/0.8x4/1x5.5/1.2x6.5/1.6x8 mm
⊕	3 bits for Phillips-head screws PH 1/2/3
✳	1 bit for Phillips-head screws PZ 2
	1 reversible ratchet
	1 drive handle with plastic handle
	1 extension 150 mm
	1 cardan joint
	1 bit holder with hexagon socket 1/4 inch
3/8" ○	12 bi-hex inserts with AS drive profile Sizes 10/11/12/13/14/15/16/17/18/19/21/22 mm
○	1 hex insert with AS drive profile Sizes 16 mm 5/8 inch with rubber insert for spark plugs
	1 reversible ratchet
	1 handle with sliding piece
	2 extensions 76/240 mm
	1 cardan joint
	1 adapter 3/8 inch □ x 1/4 inch ■
	1 bit holder with hexagon socket 5/16 inch



Set contents	Design	51039	...
48 pieces	in a robust, stackable ABS plastic box		201

51045

Hexagon socket wrench set HINOX

1/4"



Design

All tools are packed tightly so they cannot move around. Up to 20% higher torque values in the HINOX range (static load). Stainless steel with the same hardness provides higher strength values than standard material (31 CrV 3). Higher safety when using, reduced risk of injury.

Up to three times longer service life in dynamic continuous load comparisons.

Eco-friendly production without surface coating. No allergic reactions from chemical coatings. Much longer service life than comparable competitive products (stainless steel rather than coating). Weather-resistant use in outdoor areas.

Quality

Stainless steel/HINOX.



51045

Set contents	Design	51045	...
24 pieces	in SmartCase		101

Set contents

	13	hex inserts with traction profile	Sizes 4/4.5/5/5.5/6/7/8/9/10/11/12/13/14 mm
	5	inserts for hexagon socket screws	Sizes 3/4/5/6/8 mm
	1 of each	reversible ratchet, handle with sliding piece, drive handle, cardan joint	
	2	extensions	55/147 mm

51040

Hexagon socket wrench set

1/4"



Design

In SmartCase 185 x 153 x 52 mm. In Safety insert system, 2-component soft foam insert. All tools are packed tightly so they cannot move around.

Quality

Chromium-vanadium steel.
Screwdriver socket wrench inserts
CVD-TiN-coated.



51040

Set contents	Design	51040	...
30 pieces	in SmartCase		201

Set contents

	12	hex inserts with traction profile	Sizes 4/5/5.5/6/7/8/9/10/11/12/13/14 mm
	5	inserts for hexagon socket screws	Sizes 3/4/5/6/8 mm
	3	inserts for slotted screws	0.6x3.5/1.0x5.5/1.2x8.0 mm
	2	inserts for Phillips-head screws PH	1/2
	2	inserts for Phillips-head screws PZ	1/2
	1 of each	reversible ratchet, handle with sliding piece, drive handle, cardan joint	
	2	extensions	55/147 mm

51041

Hexagon socket wrench set

1/4"



Design

In SmartCase 185 x 153 x 52 mm. In Safety insert system, 2-component soft foam insert. All tools are packed tightly so they cannot move around.

Quality

Chromium-vanadium steel.
Screwdriver socket wrench inserts
CVD-TiN-coated.



51041

Set contents	Design	51041	...
33 pieces	in SmartCase		101

Set contents

	11	hex inserts with traction profile	Sizes 5/5.5/6/7/8/9/10/11/12/13/14 mm
	5	inserts for external TX® screws	E 5/6/7/8/10
	4	inserts for hexagon socket screws	Sizes 3/4/5/6 mm
	5	inserts for internal TX® screws	T 10/15/20/25/30
	1	insert for slotted screws	1.0x5.5 mm
	1	insert for Phillips-head screws PH	2
	1	reversible ratchet, drive handle, cardan joint	
	3	extensions	55/101.5 (swivel)/147 mm

51035

Hexagon socket wrench set

1/4"



Design

In SmartCase 185 x 153 x 52 mm. In safety insert system, 2-component soft foam insert. All tools are packed tightly so they cannot move around.

Quality

Chromium-vanadium steel.



51035

Set contents	Design	51035	...
36 pieces	in SmartCase		101

Set contents

	10	hex inserts with traction profile	Sizes 5.5/6/7/8/9/10/11/12/13/14 mm
	5	bits for hexagon socket screws	Sizes 3/4/5/6/7 mm
	3	bits for slotted screws	0.6x4.5/1.2x6.5/1.2x8 mm
	3	bits for Phillips-head screws PH	1/2/3
	3	bits for Phillips-head screws PZ	1/2/3
	7	bits for RESIS TX® with bore	T 10/15/20/25/27/30/40
	1	reversible ratchet, drive handle	
	1	adapter	1/4 inch □ x 1/4 inch ○
	2	extensions	55/101.5 mm

Socket wrench sets

51036

Hexagon socket wrench set



Quality
Chromium-vanadium steel.

Design

- Ergonomic design
- Comfortable handling thanks to ready-to-use operating tools

Set contents

- 10 hex inserts with traction profile sizes 5.5 x 6/7/8/9/10/11/12/13/14 mm
- 5 bits for hexagon socket screws Sizes 3/4/5/6/7 mm
- 3 bits for slotted screws 0.6x4.5/1.2x6.5/1.2x8 mm
- 3 bits for Phillips-head screws PH 1/2/3
- 3 bits for Phillips-head screws PZ 1/2/3
- 7 bits for RESIS TX® with bore T 10/15/20/25/27/30/40
- 1 of each reversible ratchet, drive handle, cardan joint
- 2 extensions 55 mm/101.5 mm
- 2 adapters 1/4 inch □ x 1/4 inch ○ and 1/4 inch ■ x 1/4 inch ●



51036



Set contents

Design

51036

...

38 pieces

in SmartCase (52 x 98 x 180 mm)

101

51043

Hexagon socket wrench set



Quality
Chromium-vanadium steel.

Design

- In plastic box with two-colour foam insert. Tools positioned firmly and safely in the foam insert.
- Prevents individual parts from falling out and being lost.

Set contents

- 10 hex inserts Sizes 5.5/6/7/8/9/10/11/12/13/14 mm
- 1 reversible ratchet
- 2 extensions 55/100 mm
- 1 drive handle
- 1 cardan joint
- 1 adapter 1/4 inch square drive x 1/4 inch hexagon socket
- 5 bits for hexagon socket screws Sizes 3/4/5/6/7 mm
- 3 bits for slotted screws 4.5/6.5/8.0 mm
- 3 bits for Phillips-head screws PH 1/2/3
- 3 bits for Phillips-head screws PZ 1/2/3
- 7 bits for RESIS TX® with bore T 10/15/20/25/27/30/40



51043

Set contents

Design

51043

...

37 pieces

in a plastic storage box

201

51052

Hexagon socket wrench set



Design

- With lever reversible ratchet, steerable
- 7 switching levels using flex-stop variomatic.

Set contents

- 1 lever reversible ratchet
- 12 hex inserts Sizes 4/4.5/5/5.5/6/7/8/9/10/11/12/13 mm
- 7 TX® inserts with bore T 10/15/20/25/27/30/40
- 1 insert for slotted screws 5.5 mm
- 1 insert for Phillips-head screws PH 2
- 1 insert for Phillips-head screws PZ 2
- 3 inserts for hexagon socket screws Sizes 4/5/6 mm
- 1 cardan joint
- 1 magnet seeker
- 2 extensions 50/100 mm
- 1 Minimus tube for double blades
- 1 Minimus double blade for slotted screws 2.5/3.5 mm
- 1 Minimus double blade for Phillips-head screws PH 0/1
- 1 1/4 inch bit coupling with magnetic mount
- 1 machine adapter 1/4 inch ■ x 1/4 inch ● length 50 mm
- 1 Minimus removable handle



51052

Set contents

Design

51052

...

36 pieces

in all-steel cassette

401

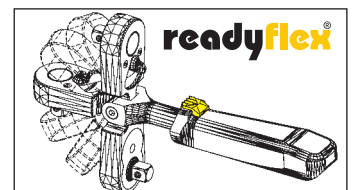



51137 099

Design

- Zyklop Mini 1 bit ratchet tool, die-forged steel version

- Zyklop Mini 2 nut ratchet tool, die-forged steel version

Applications

For extremely rapid screwing even in very cramped spaces.



51137 099

**Set contents 51137 099**

	1	Zyklop Mini 1 bit ratchet tool
	1	Zyklop Mini 2 ratchet tool
○	9	Zyklop socket wrench inserts Sizes 4/5/5.5/6/7/8/10/12/13 x 18 mm
	1	bit holder 1/4 inch x 78 mm
●	4	bits for hex socket screws Hex-Plus 3/4/5/6 x 25 mm
+	2	bits for Phillips-head screws PH 1/2 x 25 mm
+	2	bits for Phillips-head screws PZ 1/2 x 25 mm
★	6	bits for TX® screws T 10/15/20/25/30/40 x 25 mm
○	1	connector 1/4 inch hex x 1/4 inch square

51137 100

Design

- With forged solid metal ratchet with 72 teeth for extremely high robustness and long service life
- Ultra-slim design for work even in very tight spaces

Quality

Chrome molybdenum ratchet.



51137 100



TAKE IT EASY TOOL FINDER

Set contents 51137 100

	1	Zyklop metal reversible ratchet
○	9	Zyklop socket wrench inserts Sizes 5/5.5/6/7/8/10/11/12/13 x 23 mm
	1	Zyklop extension with rapid-turning sleeve 150 mm
	1	Zyklop wobble extension 52 mm
●	4	bits for hex socket screws Hex-Plus 3/4/5/6 x 25 mm
+	3	bits for Phillips-head screws PH 1/2/3 x 25 mm
+	2	bits for Phillips-head screws PZ 1/2 x 25 mm
★	6	bits for TX® screws T 10/15/20/25/27/30 x 25 mm
○	1	connector with quick-change chuck 1/4 inch hex x 1/4 inch square

51137 102

Design

The Wera Zyklop ratchet gives you 6 tools in one:

1. Fine-tooth ratchet
2. Joint ratchet
3. Angled ratchet
4. Ratchet with safety lock
5. Power ratchet
6. Screwdriver.



51137 102



TAKE IT EASY TOOL FINDER

Set contents 51137 102

	1	Zyklop Speed ratchet
○	9	Zyklop socket wrench inserts Sizes 5/5.5/6/7/8/10/11/12/13 x 23 mm
	1	Zyklop extension with rapid-turning sleeve 150 mm
	1	Zyklop wobble extension 52 mm
●	4	bits for hex socket screws Hex-Plus 3/4/5/6 x 25 mm
+	3	bits for Phillips-head screws PH 1/2/3 x 25 mm
+	2	bits for Phillips-head screws PZ 1/2 x 25 mm
★	6	bits for TX® screws T 10/15/20/25/27/30 x 25 mm
○	1	connector with quick-change chuck 1/4 inch hex x 1/4 inch square

51137 103

Design

- All-in Zyklop Speed ratchet set, with holding function, 1/4-inch drive, metric
- 42 pieces 1/4-inch socket wrench set in a rugged fabric box

- Zyklop Speed ratchet with freely movable ratchet head with 5 defined positions
- Fine toothing with 72 teeth and 5° return angle
- Take it Easy tool finder: end-to-end colour coding by size



51137 103



HOLDING FUNCTION



TAKE IT EASY TOOL FINDER

Set contents 51137 103

	1	Zyklop Speed ratchet
○	13	Zyklop socket wrench inserts Sizes 4/4.5/5/5.5/6/7/8/9/10/11/12/13/14 x 23 mm
	1	Zyklop extension with rapid-turning sleeve 150 mm
	1	Zyklop wobble extension 56 mm
●	2	bits for hexagon socket screws Hex-Plus 2/2.5 x 28 mm
●	2	bits for hexagon socket screws with holding function Hex-Plus 3/4/5/6/7/8 x 28 mm
⊖	2	bits for slotted screws 0.8 x 5.5/1.2 x 6.5 mm
+	3	bits for Phillips-head screws PH 1/2/3 x 28 mm
+	3	bits for Phillips-head screws PZ 1/2/3 x 28 mm
★	9	bits for TX® screws T 8/9/10/15/20/25/27/30/40 x 28 mm
	1	nut removal tool 14 x 43 mm

Set contents	Design	51137	...
27 pieces	in a rugged fabric box	099	
28 pieces	in a rugged fabric box	100	
28 pieces	in a rugged fabric box	102	
42 pieces	in a rugged fabric box	103	NEW

51054

Zyklop hexagon socket wrench set

1/4"



Design

- Fitting diagram and practical foam insert makes it easier to sort missing tools
- Zyklop Speed ratchet with freely movable ratchet head with 5 defined positions (0°/15°/90°)
- Fine toothing with 72 teeth and 5° return angle

- 0° position can be used as a conventional screwdriver
- Socket wrench with **Take it Easy tool finder**
- Minimal weight and volume for improved mobility

NEW



Hand tools

Set contents

- 1 Zyklop Speed ratchet
- 13 Zyklop socket wrench inserts Sizes 4/4.5/5/5.5/6/7/8/9/10/11/12/13/14 x 23 mm
- 1 Zyklop T-handle 110 mm
- 1 Zyklop wobble extension 56 mm
- 1 Zyklop cardan joint 35.5 mm
- 1 Zyklop connector 37 mm
- 1 Zyklop extension flexible-lock with rapid-turning sleeve, short 75 mm
- 1 Zyklop extension flexible-lock with rapid-turning sleeve, long 150 mm
- 5 bits for hexagon socket screws Hex-Plus 3/4/5/6/8 x 25 mm
- 3 bits for slotted screws 0.6 x 4.5/1.0 x 5.5/1.2 x 8.0 mm
- 3 bits for Phillips-head screws PH 1/2/3 x 25 mm
- 3 bits for Phillips-head screws PZ 1/2/3 x 25 mm
- 8 bits for TX® screws with hole T 8/9/10/15/20/25/30/40 x 25 mm



Set contents	Design	51054	...
42 pieces	in a sturdy tool case		101

51056

Connector strip, magnetic (empty)

1/4"



Design

Square drive suitable for 13 socket wrench inserts nominal size of 6.3 (1/4 inch). **2 additional square drive adapters for ratchets, sliding handles, extensions etc.** Strong magnet allows secure attachment of the strip to metal objects. Additional holes in the strip allow mounting on non-metallic objects and walls.

By turning through 90°, the inserts on the square are securely locked by the ball. Turning by 90° in the opposite direction unlocks the inserts so they can be removed. **Supplied without tools.**



51056

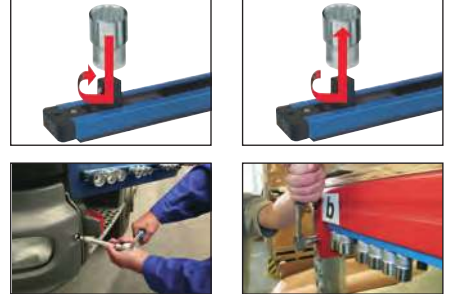

For inserts Units	Length mm	Width mm	Weight g	51056	...
13	380	33	350		101

51059 - 51063

Hexagon socket wrench inserts DIN 3124/ISO 2725

1/4"

Design

- Chromium-plated
- Die-forged

Quality

Chromium-vanadium steel.

51059



- With side hole
- With energy profile

51061



51062



- With AS drive profile

Quality

HPQ steel.

51063



- With traction profile

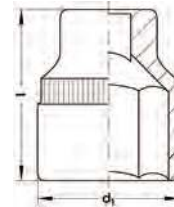

51059



51061



51062



51063



51063 L



Sizes mm	l approx. mm	d ₁ approx. mm	ATORN®		GEDORE®		STAHLWILLE®		HAZET®	
			51059	...	51061	...	51062	...	51063	...
3.5	25	6.0							102	
4	25	6.8		103		103			103	403
L 4	50	6.7		104						
4.5	25	7.2		105		105				405
L 4.5	50	7.0		106		106				
5	25	8.1		107		107		107		407
L 5	50	7.9		108						
5.5	25	8.6		109		109		109		409
L 5.5	50	8.5		110						
6	25	9.2		111		111		111		411
L 6	50	9.2		112						412
7	25	10.8		113		113		113		413
L 7	50	11.0		114		114				414
8	25	11.7		115		115		115		415
L 8	50	12.0		116		116				416
9	25	13.0		117		117		117		417
L 9	50	13.0		118						418
10	25	14.3		119		119		119		419
L 10	50	14.5		120		120				420
11	25	15.8		121		121		121		421
L 11	50	15.5		122		122				422
12	25	17.0		123		123		123		423
L 12	50	17.0		124		124				424
13	25	17.9		125		125		125		425
L 13	50	18.0		126		126				426
14	25	19.3		127		127		127		427
L 14	50	19.5		128						

Socket wrench inserts

51064

Hexagon socket wrench inserts



NEW



51064 200-201

Design

- Nut set on a robust textile belt
- Smooth rotation mechanism for secure fit and easy removal of the tools
- With **Take it Easy tool finder**:
Colour coding by size

Usage

Suitable for mounting on a wall, shelf, workshop trolley and Wera 2go system.

51064 200

Design

- Nuts with holding function for screws/nuts

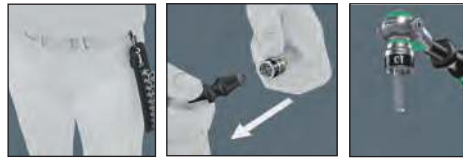

51064 200 with holding function



51064 201 without holding function



Set contents 51064 200

- 9 Zyklop socket wrench inserts Sizes 4/ 4.5/5/5.5/6/7/8/10/13 x 23 mm
- 1 nut removal tool 14 x 43 mm

Set contents 51064 201

- 9 Zyklop socket wrench inserts Sizes 4/ 4.5/5/5.5/6/7/8/10/13 x 23 mm

Set contents	Design	51064	...
10 pieces	with holding function	200	
9 pieces	without holding function	201	

51064 101



51064 102



51064 103



51064 104



51064 105



51064 106



51064 107



51064 109



51064 112



with holding function

Size mm	51064	...
4	101	
4.5	102	
5	103	
5.5	104	
6	105	
7	106	
8	107	

with holding function

Size mm	51064	...
9	108	
10	109	
11	110	
12	111	
13	112	
14	113	



51064 001-013

Design

- Knurling at the rear end for strong grip during manual operation
- With ball-securing groove

Applications

For manual and machine operation, not suitable for impact.

51064 001



51064 002



51064 003



51064 004



51064 005



51064 006



51064 007



51064 008



51064 009



51064 010



without holding function

Size mm	51064	...
4	001	
4.5	002	
5	003	
5.5	004	
6	005	
7	006	
8	007	

without holding function

Size mm	51064	...
9	008	
10	009	
11	010	
12	011	
13	012	
14	013	

51064 011



51064 012



51064 013



51073

Bi-hex socket wrench inserts (inch) DIN 3124/ISO 2725

1/4"



51073



Quality
Chromo extra.

Design

American inch sizes. High-performance inserts, thin-walled, with dynamic drive profile. Nickel and chrome plated, mirror polished.

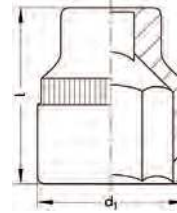

Width	l	d ₁	51073	...
Inch	mm	mm		
3/16	22.2	7.7		101
7/32	22.2	8.5		102
1/4	22.2	9.3		103
9/32	22.2	10.5		104
5/16	22.2	11.5		105
11/32	22.2	12.6		106
3/8	22.2	13.8		107
7/16	22.2	15.4		108
1/2	22.2	17.5		109
9/16	23.0	18.8		110

51079

Long bi-hex socket wrench inserts (inch) ISO 2725-1

1/4"



51079



Quality
Chromo extra.

Design

Long, American inch dimensions. High-performance inserts, thin-walled, with dynamic drive profile. Nickel and chrome plated, mirror polished.

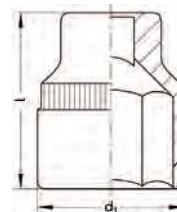

Width	l	d ₁	51079	...
Inch	mm	mm		
3/16	50.6	7.7		101
7/32	50.6	8.5		102
1/4	50.6	9.3		103
9/32	50.6	10.5		104
5/16	50.6	11.5		105
11/32	50.6	12.6		106
3/8	50.6	14.1		107
7/16	50.6	15.4		108
1/2	50.6	17.5		109
9/16	50.6	18.8		110

51074 - 51078

Screwdriver bits

1/4"

51074

ATORN®

Design

Chrome-plated sleeves, blades made of special steel, bronzed.

Quality

Chromium-vanadium steel.

51078

HAZET®

Quality

CVD-TiN coating for longer service life.



51074 102-104



51078 101-106



51074 201-203



51078 201-203



51074 301-303



51078 301-303

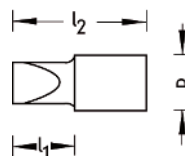

Blade thickness x width mm	Size PH	Size PZ	l ₁ mm	l ₂ mm	d mm	ATORN®		HAZET®	
						51074	...	51078	...
⊖ 0.8 x 4.0			18	37	12.0		102		
⊖ 1.0 x 5.5			18	37	12.0		103		
⊖ 1.2 x 6.5			18	37	12.0		104		
⊖ 0.6 x 3.5			16	28	12.0				101
⊖ 0.8 x 4.0			16	28	12.0				102
⊖ 1.0 x 5.5			16	28	12.0				103
⊖ 1.2 x 8.0			16	28	12.0				105
⊖ 1.6 x 10.0			16	28	12.0				106
	⊕ PH 1		18	37	12.0		201		
	⊕ PH 2		18	37	12.0		202		
	⊕ PH 3		18	37	12.0		203		
	⊕ PH 1		16	28	12.0				201
	⊕ PH 2		16	28	12.0				202
	⊕ PH 3		16	28	12.0				203
		⊕ PZ 1	18	37	12.0		301		
		⊕ PZ 2	18	37	12.0		302		
		⊕ PZ 3	18	37	12.0		303		
		⊕ PZ 1	16	28	12.0				301
		⊕ PZ 2	16	28	12.0				302
		⊕ PZ 3	16	28	12.0				303

Hand tools

51075

Screwdriver bits

1/4"



Wera
SA A TOOL FOR YOU

Design

- With ball-securing groove
- Knurling at the rear end for strong grip during manual operation
- **Take it Easy** tool finder:
With output colour-coding
yellow = slot
red = PH
black = PZ

Applications

For manual and machine operation
(not suitable for impact)

Quality

Chromium-vanadium steel,
brushed chromium-plated.

NEW

51075 103



51075 202



51075 302



Blade thickness x width mm	Size PH	Size PZ	51075	...
⊖ 0.8 x 5.5				101
⊖ 1.0 x 5.5				103
⊖ 1.2 x 6.5				104
	⊕ PH 1			201
	⊕ PH 2			202
	⊕ PH 3			203
		⊕ PZ 1		301
		⊕ PZ 2		302
		⊕ PZ 3		303

51082 - 51090

Hexagon screwdriver bits

1/4"



Design
Chrome-plated, die-forged.

51082
ATORN®
Quality
Chromium-vanadium steel.

51086
GEDORE®
Quality
Vanadium special steel.

51088
STAHLWILLE®
Quality
Chrome alloy steel.

51090
HAZET®
Quality
CVD-TiN coating for longer service life.

Size mm	Length mm	ATORN®		GEDORE®		STAHLWILLE®		HAZET®	
		51082	...	51086	...	51088	...	51090	...
3	28								
3	37		101			101		102	201
L 3	55							103	
4	28					102		104	202
4	37		102						
L 4	55							105	
5	28					103		106	203
5	37		103						
L 5	55							107	
6	28					104		108	204
6	37		104						
L 6	55							109	
8	28					105		110	205
8	37		105						



Hand tools

51098

Hex and TX® screwdriver set

1/4"



ATORN®

Quality
Chromium-vanadium steel.

Design
All tools are packed tightly so they cannot move around.

Note:
TX® profile gauge, see art. no. 37930.

Set contents		Design	51098	...
5	inserts for hexagon socket screws Sizes 3/4/5/6/8 mm			
9	inserts for internal TX® screws T 8/9/10/15/20/25/27/30/40			
1	lever reversible ratchet, with 2-component handle 150 mm			
2	extensions 50/105 mm			
17 pieces	in a sheet steel box with foam insert			201

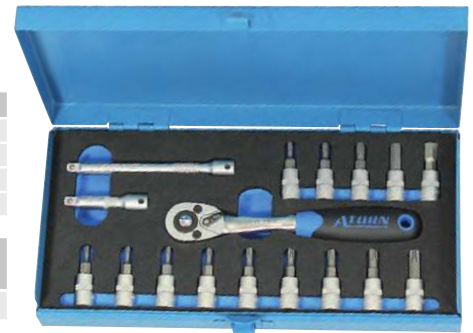

51099

TX® set

1/4"



ATORN®

Quality
Chromium-vanadium steel.

Design
All tools are packed tightly so they cannot move around.

Note:
TX® profile gauge, see art. no. 37930.

Set contents		Design	51099	...
6	inserts for external TX® screws E 4/5/6/7/8/10			
9	inserts for internal TX® screws T 8/9/10/15/20/25/27/30/40			
1	lever reversible ratchet, with 2-component handle 150 mm			
2	extensions 50/105 mm			
18 pieces	in a sheet steel box with foam inserts			101

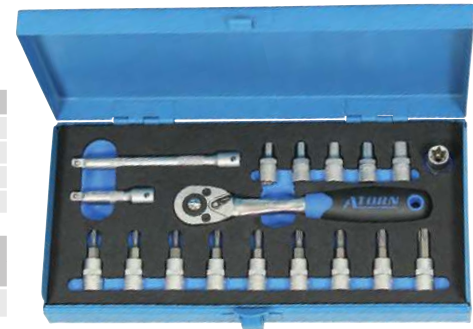

51097

TX® set



GEDORE

WERKZEUGE FÜR'S LEBEN

Quality

Vanadium special steel.

Note:

TX® profile gauge, see art. no. 37930.

51097



Set contents	
6	inserts for external TX® E 4/5/6/7/8/10
9	inserts for internal TX® T 8/9/10/15/20/25/27/30/40

Set contents	Design	51097	...
15 pieces	in a plastic storage box		101

51100

TX® screwdriver bits



Wera
SEIT 1924

51100 400

Design

- Bit nut set on a robust textile belt
- Bit nuts with the benefits of Wera bit technology
- Bit nuts with holding function for screws
- Smooth rotation mechanism for secure fit and easy removal of the tools

Applications

Suitable for mounting on a wall, shelf, workshop trolley and Wera 2go system.

51100 401

Design

- Compact and highly robust fabric box.
- Low weight, low volume
- Bit nuts (non-impact) for manual or machine operation
- The function holds screws securely on the tool
- With **Take it Easy** tool finder colour coding by size
- Knurling on the rear nut end for strong grip during manual operation

NEW



51100 400

Set contents 51100 400	
9	inserts for internal TX® T 8/9/10/15/20/25/27/30/40

Set contents 51100 401	
4	inserts for internal TX® T 25/27/30/40

Set contents	Design	51100	...
9 pieces	in textile belt		400
4 pieces	in fabric box		401



51100 401

51100 205



Individual	short
Size	51100
T	...
8	201
9	202
10	203
15	204
20	205

Individual	short
Size	51100
T	...
25	206
27	207
30	208
40	209

Individual	long
Size	51100
T	...
25	301
27	302

Individual	long
Size	51100
T	...
30	303
40	304



51100 302

51093 - 51096

TX® screwdriver bits



Applications

For internal TX® screws.

Note:

TX® profile gauge, see art. no. 37930.

51093



Design

Chrome-plated.

Quality

Chromium-vanadium steel.

51094



Design

Chrome-plated.

Quality

Vanadium special steel.

51096



Quality

CVD-TIN coating for longer service life.

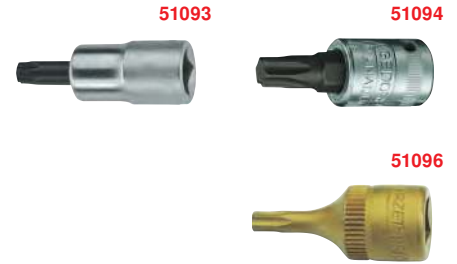

Size	ATORN®	GEDORE®	HAZET®
T	51093	51094	51096
8	101	101	101
9	102	102	102
10	103	103	103
15	104	104	104
20	105	105	105

Size	ATORN®	GEDORE®	HAZET®
T	51093	51094	51096
25	106	106	106
27	107	107	107
30	108	108	108
40	109	109	109

51104 - 51105

TX® socket wrench inserts



Design

Chrome-plated.

Applications

For external TX® screws.

Quality

Vanadium steel.

51104



51105



Note:

TX® profile gauge, see art. no. 37930.

Size	Length approx. mm	ATORN®	HAZET®
E		51104	51105
4	25	101	101
5	25	102	102
6	25	103	103
7	25	104	104

Size	Length approx. mm	ATORN®	HAZET®
E		51104	51105
8	25	105	105
10	25	106	106
11	25	107	107



51114 - 51120

Reversible ratchets DIN 3122/ISO 3315



Design

Chrome-plated and polished. Extremely robust ratchet with rotary head for clockwise/anti-clockwise rotation and ergonomic plastic handle.

Quality

Chromium-vanadium steel.

51114



Finely toothed (72 teeth, 5° rotating angle), with ball lock.

51116



Finely toothed (60 teeth, 6° rotating angle). Fast switching with one-handed operation. With 2-component handle.

Quality

Chrome alloy steel.

51117



Finely toothed (72 teeth, 5° angle of rotation), allows even extremely obscured screwed connections to be manipulated. Large, reversal knob on the top makes it easier to reverse the ratchet. Deep-seated reversal knob protects against unintentional reversal. Coated fine-cast cover plate and reversal knob for tough operating conditions. Inductively hardened internal toothing ensures high stress resistance and long service life. Robust housing with forged, ergonomic handle. Anti-slip 2-component grip for optimal handling.

51120



Finely toothed (72 teeth, 5° rotating angle). The contact surface makes it possible to press on the ratchet head, without having to use the switch. Fast switching with one-handed operation.

Total length mm	GEDORE®	STAHLWILLE®	HAZET®	FACOM®
	51114	51116	51117	51120
117				201
118			201	
119				101
129	101			



Hand tools

Reversible ratchets

51124

Reversible ratchet DIN 3122/ISO 3315

1/4"



Design

- The new standard for ergonomics, power transmission and sensitivity
- Patented three-component grip technology **ERGONIC®** flexibly adapts to the user's hand
- The grip and hand interlock, the force required decreases and higher torques are achieved
- The flexibility of the material also increases sensitivity and thus enables the precise use of force

Advantage

- Fine toothing, 72 teeth
- 5° return angle for confined spaces
- Short design
- Pushbutton release
- Three-component grip technology **ERGONIC®**

Total length	51124	...
mm	150	100



51124



51126 - 51133

Reversible ratchets DIN 3122/ISO 3315

1/4"

Design

Chrome-plated, extremely robust ratchet with switchable clockwise/anti-clockwise rotation and ergonomic plastic handle.

Quality

Chromium-vanadium steel.

51126 201



With lever reverse and quick release pushbutton. Finely toothed, 72 teeth. Anti-slip 2-component handle with hanging hole.

51129 101



With lever reverse, lock-in centre position and ball lock. Oval head. 24 teeth, 15° angle of rotation.

51129 102



With lever reverse, pushbutton release and ball lock. Finely toothed, 40 teeth, 9° angle of rotation. Anti-slip 2-component handle with hanging hole.

51130 201



With lever reverse, 22 teeth. With 2-component handle.

Quality

Chrome alloy steel.

51130 203



With lever reverse, quick release safety lock and 2-component handle, 80 teeth, working angle of just 4.5°.

Quality

Chrome alloy steel.

51130 205



With lever reverse, quick release safety lock and 2-component handle, 80 teeth, working angle of just 4.5°.

Quality

Chrome-alloy steel, chrome-plated.

51132 100



With lever reverse, 2-component handle, especially compact design, 20 teeth.

Quality

Chrome-plated surface, polished.

51132 101



With lever reverse.

51132 102



With lever reverse, safety connection and quick release pushbutton, 20 teeth.

51133 101



With lever reverse. 72 teeth, 5° return angle. Nickel and chrome plated, mirror polished. With 2-component handle



51126



51129 101



51129 102



51130 201



51130 203



51130 205



51132 100



51132 101



51132 102



51133 101

	ATORN®		GEDORE®		STAHLWILLE®		HAZET®		BAHCO®	
Total length	51126	...	51129	...	51130	...	51132	...	51133	...
mm										
95									100	
115									101	
115									102	
117							201			
117							203			
127					101					
129					102					
130										101
145		201								
153							205	NEW		



51136

Zyklus metal ratchet

1/4"



Design

- Forged **solid metal ratchet** for extremely high robustness and long service life
- With ball lock
- Slim design for work even in very tight spaces
- Fine toothing with 72 teeth for a return angle of just 5°
- Reversing lever for easy switching of direction
- With secure nut locking function

Quality

Chrome molybdenum.

Extremely slim.
Long lever.



The ball locking mechanism ensures the nuts and accessories fit securely, thus ensuring reliable safety during screwing.



51136 100

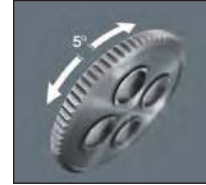

The finely toothed reversible ratchet with 72 teeth has a small return angle of just 5°. The small stroke enables fast and precise working in all installation positions.



Thanks to the reversing lever, it is possible to change direction quickly and easily.

Total length	51136	...
mm		
141	100	

51136

Zyklus Speed ratchet



Zyklus

1/4"



Design

- Flywheel mass design and handy rapid-turning sleeve for high working speed
- Freely tilting ratchet head
- Defined position at 0°, 90° to the left and right as well as 15° from 90° inwards
- Can be used in 0° position like a conventional screwdriver
- Pushbutton release
- Anti-clockwise/clockwise switch
- Finely toothed
- Small return angle of 5°
- Multi-component power grip for effortless work



The ratchet head can be swivelled freely and can be unlocked in any position using the slide switch on both sides.



The nut locking accelerates the insertion or removal of the inserts and extensions. The ball locking mechanism ensures the nuts and accessories fit securely, thus ensuring reliable safety during screwing. A short press on the release button and the tool can be moved to all defined positions.



The flywheel mass construction speeds up the screwing process.



The Zyklus ratchet can be switched quickly and easily to left/right motion in any position using the knurling wheel.



51136 101

Total length	51136	...
mm		
152	101	

51138

Removable reversible ratchet

1/4"

ATORN®

Design

- Ratcheting/clamping function
- Finely toothed, 72 teeth
- 5° return angle for confined spaces
- Anti-clockwise/clockwise direction switching using lever with pushbutton release

Applications

Lever reversible ratchet for manually operated socket wrench inserts and connectors

Quality

Chromium-vanadium steel, matt chromium-plated.



51138

Adjustment range	51138	...
mm		
150 - 250		201

51134

T-handle reversible ratchet

1/4"

HAZET®

Design

With quickly-detachable safety connector.

Applications

Combined the advantages of a T-handle socket wrench and a reversible ratchet. Both powerful and precision work possible.



51134

Total length	51134	...
mm		
100		101



51140 - 51145

Drive elements

1/4"

Design

Chrome-plated, die-forged.

Quality

Chromium-vanadium steel.

51140

ATORN®

51140 302

ATORN®

Drive handle

Design

With ball lock and 2-component handle.

Applications

For hand-operated socket wrench inserts with 1/4-inch square drive in accordance with DIN 3120, ISO 1174.

51143

STAHLWILLE®

51143 102

STAHLWILLE®

Drive handle

Design

With 2-component handle.

Quality

Chrome alloy steel.

51145

STAHLWILLE®

Design

With quick release safety lock.

Quality

Chrome alloy steel.

51144

HAZET®



51140 201



51145 101



51140 302



51143 102



51143 107



	51140	...	51143	...	51145	...	51144	...
Handle with sliding piece		201		101		101		
Drive handle		302		102				
Cardan joint		204		104		104		104
Adapter 1/4 inch <input type="checkbox"/> x 3/8 inch <input checked="" type="checkbox"/>		205		105				105
Adapter 1/4 inch <input type="checkbox"/> x 1/2 inch <input checked="" type="checkbox"/>				106				
FixGRIP adapter 1/4 inch <input type="checkbox"/> x 3/8 inch <input checked="" type="checkbox"/>				107				

51153 - 51164

Extensions

1/4"

Design
Chrome-plated, die-forged.
Quality
Chromium-vanadium steel.



51156
GEDORE
WERKZEUGE FÜR'S LEBEN

51159 100

51157
STAHLWILLE

51156 201

Quality
Chrome alloy steel.



51164 101

51157 105
STAHLWILLE

51157 102

Flexible extension
Loads of up to 5 Nm. Only for clockwise tightening.

51159
HAZET

51153 103

51162
FACOM

51156 202

51164
STAHLWILLE
With quick release safety lock.
Quality
Chrome alloy steel.

51159 102

51164 102

51162 104



51157 105

	ATORN®		GEDORE		STAHLWILLE		HAZET		FACOM		STAHLWILLE	
Length mm	51153	...	51156	...	51157	...	51159	...	51162	...	51164	...
25									100			
55		101		201		101		101				101
100		102				102				102		
150		103		202		103		102				102
250										104		
356												103
402								105				
152						105						

51165

Extensions with lock

1/4"



Design
Chrome-plated, polished.
Applications
The locking mechanism prevents the socket wrench from accidentally falling out.
Quality
Vanadium steel.

Length mm	51165	...
100		201
250		203

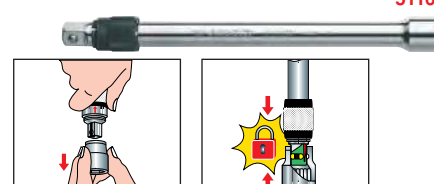

51165

51167

Cardan extensions

1/4"



Design
With ball lock.
Applications
The extension enables swivelling up to 15°.

Length mm	51167	...
55		101
97		102
148		103



51167

51168

Swivel extensions

1/4"



Design
Chrome-plated, polished.
Applications
With ball-shaped, conical square drive. Allows a swivel angle of 8° to each side.
Quality
Chromium-vanadium steel.

Length mm	51168	...
25.0		101
101.5		102

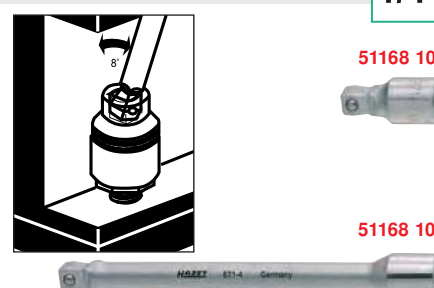

51168 101

51168 102

Socket wrench sets

51173 Hexagon socket wrench set

3/8"



ATORN®

Quality
Chromium-vanadium steel.

Design

All tools are packed tightly so they cannot move around.

Set contents	
○ 17	hex inserts with energy profile Sizes 6/7/8/9/10/11/12/13/14/15/16/17/18/19/20/21/22 mm
1	adapter 1/2 inch x 3/8 inch
1	reversible ratchet
1	cardan joint
3	extensions 50/75/150 mm

Set contents	Design	51173	...
23 pieces	in a sheet steel box with foam insert		101



51173

51178 Hexagon socket wrench set

3/8"



GEDORE®
WERKZEUGE FÜR'S LEBEN

Quality
Vanadium 31CrV3.

Design

With tempered hex UD inserts.

Set contents	
○ 12	hex inserts with UD profile Sizes 6/7/8/9/10/11/13/14/15/16/17/19 mm
1	lever reversible ratchet
1	handle with sliding piece
1	cardan joint
2	extensions 125/250 mm

Set contents	Design	51178	...
17 pieces	in a sheet steel box		101



51178

51184 Hexagon socket wrench sets

3/8"



BAHCO

Quality
Chromium vanadium.

Set contents 51184 102	
○ 12	hex inserts with dynamic drive profile Sizes 10/11/12/13/14/15/16/17/18/19/20/22 mm
○ 2	hex inserts with dynamic drive profile for spark plugs Sizes 16/21 mm
1	reversible ratchet, 60 teeth
1	cardan joint
2	extensions 75/150 mm
1	bit holder 3/8 inch x 1/4 inch
⊖ 3	bits for slotted screws 4/5.5/7 mm
⊕ 4	bits for Phillips-head screws PH 1/2/3/4
⬤ 6	bits for hexagon socket screws Sizes 3/4/5/6/7/8 mm
1	drive handle
1	bit holder, 1/4 inch x 1/4 inch

Set contents 51184 103	
○ 12	hex inserts with dynamic drive profile Sizes 1/4/5/16/11/32/3/8/7/16/1/2/9/16/5/8/11/16 / 3/4 / 13/16 / 7/8 inch
○ 2	hex inserts with dynamic drive profile for spark plugs Sizes 16/21 mm (5/8 and 13/16 inch)
1	reversible ratchet, 60 teeth
1	cardan joint
2	extensions 75/150 mm
1	bit holder 3/8 inch x 1/4 inch
⊖ 3	bits for slotted screws 4/5.5/7 mm
⊕ 4	bits for Phillips-head screws PH 1/2/3/4
⬤ 6	bits for hexagon socket screws Sizes 3/4/5/6/7/8 mm
1	drive handle
1	bit holder 1/4 inch x 1/4 inch

Set contents	Design	mm	...	inch	...
34 pieces	in plastic case	51184	...	51184	...
34 pieces	in plastic case		102		103 NEW

DYNAMIC-DRIVE™

51184 102



51184 103



103 NEW

Hand tools

51174

Zyklop metal hexagon socket wrench set

3/8"



Design

- With forged solid metal ratchet with 72 teeth for extremely high robustness and long service life

- Ultra-slim design for work even in very tight spaces
- In a robust, foldable fabric bag for safe storage

Quality

Chrome molybdenum.

51174 100



Set contents

- 9 hex inserts Sizes 8/10/12/13/15/16/17/18/19 mm
- 5 bits for hexagon socket screws Hex-Plus Sizes 3/4/5/6/8 mm
- ⊕ 3 bits for Phillips-head screws PH 1/2/3
- ⊕ 2 bits for Phillips-head screws PZ 1/2
- ⊛ 6 bits for internal TX® screws T 15/20/25/27/30/40
- 1 Zyklop metal ratchet with reversing lever
- 1 Zyklop connector 1/4 inch hex x 3/8 inch square
- 1 Zyklop extension with rapid-turning sleeve 200 mm
- 1 Zyklop wobble extension 76 mm

Set contents

Design

51174

...

29 pieces

in a robust, foldable fabric bag

100

51174

Zyklop metal hexagon socket wrench set

3/8"



Design

- Zyklop metal ratchet with reversing lever
- Extremely slim, long handle for optimum power transmission
- Fine toothing with 72 teeth and 5° return angle
- Hexagon head nuts with holding function for screws and nuts

- With Take it Easy tool finder colour coding by size
- Compact set arrangement ensures that a large number of tools takes up a minimum amount of space
- High degree of robustness and durability thanks to the innovative textile box
- Additional surface protection from textile outer material
- Minimal weight and volume for improved mobility

51174 101



NEW

Set contents

- 9 hex inserts Sizes 8/10/12/13/15/16/17/18/19 x 29 mm
- 1 Zyklop metal ratchet with reversing lever
- 1 Zyklop extension with rapid-turning sleeve 200 mm
- 1 Zyklop wobble extension 76 mm
- 1 nut removal tool 43 x 14 mm

Set contents

Design

51174

...

13 pieces

in a robust fabric box

101

51176

Zyklop Speed socket wrench set

3/8"



Design

- Zyklop Speed ratchet with freely movable ratchet head with 5 defined fixed positions (0°/15°/90°)
- Fine toothing with 72 teeth and 5° return angle
- 0° position can be used as a conventional screwdriver
- Socket wrench with Take it Easy tool finder

- The fitting diagram in the lid and the practical foam insert make it easier to sort the missing tools
- Minimal weight and volume for improved mobility

51176

NEW



Set contents

- 1 Zyklop Speed ratchet
- 18 Zyklop socket wrench inserts Sizes 6/7/8/9/10/11/12/13/14/15/16/17/18/19/20/21/22/24 mm
- 1 Zyklop T-handle 165 mm
- 1 Zyklop wobble extension 76 mm
- 1 Zyklop cardan joint 50 mm
- 1 Zyklop connector 44 mm
- 1 Zyklop flexible-lock extension with rapid-turning sleeve, short 125 mm
- 1 Zyklop flexible-lock extension with rapid-turning sleeve, long 200 mm
- 6 bits for hexagon socket screws Hex-Plus 3/4/5/6/8/10 x 25 mm
- ⊖ 1 bit for slotted screws 1.0x 5.5x25 mm
- ⊕ 2 bits for Phillips-head screws PH 2/3 x 25 mm
- ⊕ 2 bits for Phillips-head screws PZ 2/3 x 25 mm
- ⊛ 7 bits for TX® screws with hole T 10/15/20/25/27/30/40 x 25 mm

Set contents

Design

51176

...

43 pieces

in a sturdy tool case

100



51180

Hexagon socket wrench set



Design
Chrome-plated.

Quality
Chrome-alloy steel.

51180



Set contents	
○ 14	inserts with AS drive profile Sizes 8/9/10/11/12/13/14/15/16/17/18/19/21/22 mm
1	reversible ratchet
1	handle with sliding piece
1	cardan joint
2	extensions 76/240 mm
Set contents	Design 51180 ...
19 pieces	in a robust, stackable ABS plastic box 102

51187

Hexagon socket wrench set



Design
In SmartCase 355 x 235 x 65 mm. In Safety insert system, 2-component soft foam insert. All tools are packed tightly so they cannot move around.

Quality
Chromium-vanadium steel.
Screwdriver socket wrench inserts
CVD-TiN-coated.

51187



Set contents	
Ⓜ 16	hex inserts with traction profile Sizes 6/7/8/9/10/11/12/13/14/15/16/17/18/19/21/22 mm
⊖	3 inserts for slotted screws 1.0 x 5.5/1.2 x 8.0/1.6 x 10.0 mm
⊕	3 inserts for Phillips-head screws PH 1/2/3
⦿	4 inserts for hexagon socket screws Sizes 4/5/6/8 mm
1	reversible ratchet
1	handle with sliding piece
1	cardan joint
3	extensions 74/126/254 mm
Set contents	Design 51187 ...
32 pieces	in the Smart Case with soft foam 101

51175

Hexagon socket wrench set



Design
In SmartCase 355 x 235 x 65 mm. In Safety insert system, 2-component soft foam insert. All tools are packed tightly so they cannot move around.

Quality
Chromium-vanadium steel.

51175



Set contents	
1/4" Ⓜ 12	hex inserts with traction profile Sizes 4/4.5/5/5.5/6/7/8/9/10/11/12/13 mm
⦿	5 bits for hexagon socket screws Sizes 3/4/5/6/8 mm
⊖	4 bits for slotted screws 0.5 x 4/0.6 x 4.5/0.8 x 5.5/1.0 x 6 mm
⊕	2 bits for Phillips-head screws PH 1/2
⊕	2 bits for Phillips-head screws PZ 1/2
1	adapter 1/4 inch (hollow) x 1/4 inch hex (hollow)
1	reversible ratchet
1	drive handle with plastic handle
1	cardan joint
1	extension 101.5 mm
3/8" Ⓜ 12	hex inserts with traction profile Sizes 10/11/12/13/14/15/16/17/18/19/21/22 mm
1	adapter 3/8 inch (hollow) x 1/4 inch hex (hollow)
1	reversible ratchet
1	cardan joint
1	extension 150 mm
Set contents	Design 51175 ...
46 pieces	in SmartCase with soft foam insert 201

51186

Bi-hexagon socket wrench set



Design

Chrome-plated.

Quality

Chrome alloy steel.

51186



Set contents			
○	11	bi-hex inserts with AS drive profile	Sizes 8/10/11/12/13/14/15/16/17/18/19 mm
○	1	bi-hex insert with AS drive profile	Sizes 16 mm 5/8 inch with rubber insert for spark plugs
●	7	inserts for hexagon socket screws	Sizes 3/4/5/6/7/8/10 mm
	1	reversible ratchet	
	1	handle with sliding piece	
	1	cardan joint	
	2	extensions	76/240 mm
Set contents	Design	51186	...
24 pieces	in a robust, stackable ABS plastic box		101

51189

Hex and bi-hex socket wrench set



Design

Metal case 578 x 235 x 88 mm.
In plastic insert.

Quality

Chromium-vanadium steel.

Screwdriver socket wrench inserts
CVD-TiN-coated.

51189



Set contents			
Ⓜ	3	hex inserts with traction profile	Sizes 6/7/8 mm
Ⓜ	14	bi-hex inserts with traction profile	Sizes 9/10/11/12/13/14/15/16/17/18/19/20/21/22 mm
Ⓜ	14	bi-hex inserts with long traction profile	Sizes 9/10/11/12/13/14/15/16/17/18/19/20/21/22 mm
⊖	3	inserts for slotted screws	1.0 x 5.5/1.2 x 8.0/1.6 x 10.0 mm
⊕	3	inserts for Phillips-head screws PH	2/3/4
●	9	inserts for hexagon socket screws	Sizes 3/4/5/6/7/8/9/10/12 mm
	1	reversible ratchet	
	1	multi-angle ratchet	
	1	drive handle	
	1	handle with sliding piece	
	1	cardan joint	
	4	extensions	74/150/202/304 mm
	1	flexible extension	210 mm
	1	adapter	1/4 inch ■ x 3/8 inch □
Set contents	Design	51189	...
57 pieces	in metal case with plastic insert		201

51218

Connector strip, magnetic (empty)



Design

Square drive suitable for 14 socket wrench inserts nominal size of 10 (3/8 inch). **2 additional square drive adapters for ratchets, sliding handles, extensions etc.** Strong magnet allows secure attachment of the strip to metal objects. Additional holes in the strip allow mounting on non-metallic objects and walls.

By turning through 90°, the inserts on the square are securely locked by the ball. Turning by 90° in the opposite direction unlocks the inserts so they can be removed.

Supplied without tools.

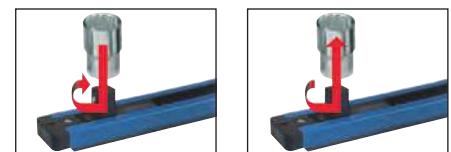

For inserts	Length	Width	Weight	51218	...
Units	mm	mm	g		
14	480	33	450		101

Socket wrench inserts

51222 - 51226

Hexagon socket wrench inserts DIN 3124/ISO 2725



Design

- Chromium-plated
- Die-forged

Quality

Chromium-vanadium steel.

51222



- With side hole
- With energy profile

51223



- With UD profile

Quality

31 Cr V3.

51224



- With AS drive profile

Quality

Chrome alloy steel.

51226



- With traction profile

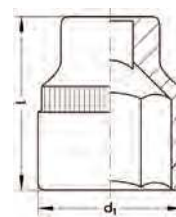

51222



51223



51224



51226



Sizes mm	l approx. mm	d ₁ approx. mm	ATORN®		GEDORE®		STAHLWILLE®		HAZET®	
			51222	...	51223	...	51224	...	51226	...
6	26	9.7		101		201				301
7	26	10.5		102		202				302
8	26	12.0		103		203		203		303
9	26	13.2		104		204				304
10	27	14.5		105		205		205		305
11	27	15.8		106		206		206		306
12	28	17.0		107		207		207		307
13	29	18.3		108		208		208		308
14	29	19.5		109		209		209		309
15	30	20.8		110		210		210		310
16	30	22.0		111		211		211		311
17	30	23.3		112		212		212		312
18	31	24.5		113		213		213		313
19	31	26.0		114		214		214		314
20	32	27.0		115						315
21	32	28.5		116		216				316
22	33	29.5		117		217		217		317

51229 - 51232

Bi-hexagon socket wrench inserts DIN 3124/ISO 2725



Design

Chrome-plated, die-forged.

51229



- With UD profile.

Quality

31 Cr V3.

51232



- With traction profile

Quality

Chromium-vanadium steel.

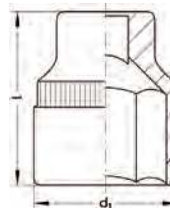

51229



51232



Sizes mm	l approx. mm	d ₁ approx. mm	GEDORE®		HAZET®	
			51229	...	51232	...
6	28	9.7	098			
7	28	11.0	099			
8	28	12.1	100			
9	24	13.0	101			101
10	25	14.5	102			102
11	27	16.0	103			103
12	27	17.0	104			104
13	28	18.5	105			105
14	28	19.5	106			106

Sizes mm	l approx. mm	d ₁ approx. mm	GEDORE®		HAZET®	
			51229	...	51232	...
15	29	21.0		107		107
16	29	28.0		108		108
17	30	23.5		109		109
18	30	24.5		110		110
19	31	26.5		111		111
20	31	27.0				112
21	31	28.5				113
22	32	29.5		114		114

51234 - 51235

Long bi-hex socket wrench inserts



Applications

For deep-seated screws and protruding pins.

Note:

Art. no. 51235 214-215 correspond to DIN 3124/ISO 2725.

51234



Design

Chrome-plated, with AS drive profile

Quality

HPQ steel.



51234



51235

51235



Design

Chrome plated, die-forged and polished.

With traction profile

Quality

Chromium-vanadium steel.

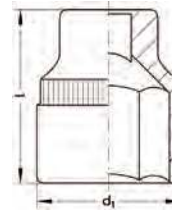

Sizes mm	l approx. mm	d ₁ approx. mm	51234		51235	
		
10	54	14.4	202	...	202	...
11	54	15.7	203	...	203	...
12	54	17.0	204	...	204	...
13	54	18.3	205	...	205	...
14	57	19.5	206	...	206	...
15	60	20.6	207	...	207	...
16	60	21.8	208	...	208	...

Sizes mm	l approx. mm	d ₁ approx. mm	51234		51235	
		
17	62	23.0	209	...	209	...
18	65	24.3	210	...	210	...
19	65	25.5	211	...	211	...
20	68	26.6	212	...
21	68	28.0	214	...
22	68	29.4	215	...

51238

Universal socket wrench insert gripper



Design

Replaces all hexagonal socket wrench inserts between sizes 7 and 19 mm.

The 54 steel pins automatically adapt to every nut or external-headed screw.

An exclusive round pin design protects screw heads from damage.

Each pin has a spring with a solid back stop to give the screw or nut a precise hold.

Applications

This universal tool handles the following connections reliably:

- Triangular profiles
- Square profiles
- Hex profiles
- TX® profiles
- Wing nuts
- Hook screws
- Eyelet screws
- Other polygon screws and nuts
- Imperial connectors

Quality

Alloyed steel housing.



51238



Length mm	Ø mm	51238 €	...
53.5	25.4	44.50	401

51241

Jointed socket wrench inserts



Design

Short, chrome-plated. With traction profile

Applications

For hard-to-reach screw connections.

Quality

Chromium-vanadium steel.

Note:

Also available as a set.
Please contact us for information!

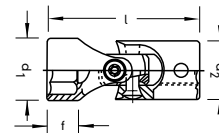

51241

Sizes mm	l mm	d ₁ mm	d ₂ mm	f mm	51241	...
10	43	13.8	19	6.8	201	...
11	43	15.0	19	6.8	202	...
12	44	16.6	19	7.3	203	...
13	44	17.8	19	7.3	204	...
14	45	19.0	19	9.3	205	...

Sizes mm	l mm	d ₁ mm	d ₂ mm	f mm	51241	...
15	45	20.4	19	9.3	206	...
16	46	22.0	19	9.2	207	...
17	46	22.8	19	9.2	208	...
18	47	24.5	19	10.2	209	...
19	48	25.2	19	11.2	210	...

Hand tools

Socket wrench inserts | Screwdriver bits

51236

Bi-hex socket wrench inserts (inch) ISO 2725-1



Quality
Chromo extra.

Design

American inch sizes. High-performance inserts, thin-walled, with dynamic drive profile. Nickel and chrome plated, mirror polished.

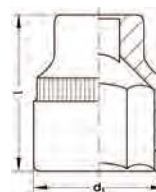

51236

Width Inch	l mm	d ₁ mm	51236	...
1/4	25.8	10.0		101
5/16	25.8	11.4		102
3/8	25.8	14.3		103
7/16	25.8	15.7		104
1/2	25.8	18.0		105
17/32	25.8	18.8		106
9/16	27.4	19.6		107

Sizes Inch	l mm	d ₁ mm	51236	...
19/32	27.8	20.4		108
5/8	28.3	21.1		109
11/16	28.8	23.6		110
3/4	30.2	25.1		111
13/16	31.3	26.7		112
7/8	32.5	29.1		113

51237

Long bi-hex socket wrench inserts (inch) ISO 2725-1



Quality
Chromo extra.

Design

Long, American inch dimensions. High-performance inserts, thin-walled, with dynamic drive profile. Nickel and chrome plated, mirror polished.

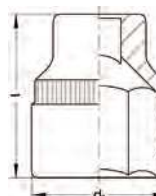

51237

Width Inch	l mm	d ₁ mm	51237	...
1/4	56	10.0		101
5/16	56	11.4		102
3/8	56	14.3		104
7/16	56	15.7		105
1/2	60	18.0		106
9/16	60	19.6		107

Sizes Inch	l mm	d ₁ mm	51237	...
19/32	60	20.4		108
5/8	60	21.1		109
11/16	60	23.6		110
3/4	60	25.2		111
13/16	60	26.7		112

51244

Screwdriver bits



WERKZEUGE FÜR'S LEBEN

Design

Chrome-plated sleeves, blades made of special steel, bronzed. Square drive C10 DIN 3120, ISO 1174. With ball-securing groove.

Quality

Vanadium special steel.



51244 201-203

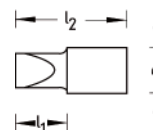

51244 301-303



Blade thickness x width mm	l ₁ mm	l ₂ mm	d mm	51244	...
1.0 x 5.5	27	55	17.5		201
1.2 x 8.0	27	55	17.5		202
1.6 x 10.0	23	55	17.5		203

Size	l ₁ mm	l ₂ mm	d mm	51244	...
PH 1	27	55	17.5		301
PH 2	23	55	17.5		302
PH 3	23	55	17.5		303

51246 - 51250

Hexagon screwdriver bits DIN 3120/ISO 1174

3/8"



Design

Chrome-plated.

Quality

Made of chrome-vanadium special steel.

51246



With ball retaining groove and side hole.

51247



With ball-securing groove.

51248



Chrome alloy steel.

51250



Long version.
Chrome-plated sleeve,
CVD-TiN-coated blade.

51246



51247



51248



51250

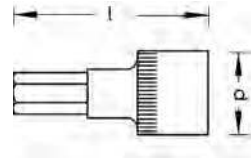

Sizes	l	d	ATORN®	GEDORE®	STAHLWILLE®	HAZET®
mm	approx. mm	approx. mm	51246	...	51247	...
3	43.5	17.5	101			101
L 3	50.0	17.0				301
4	52.0	17.5	102		202	102
L 4	55.0	17.0				302
5	52.0	17.5	103		203	103
L 5	60.0	17.0				303
6	52.0	17.5	104		204	104
L 6	65.0	17.0				304
7	52.0	18.0	105			105
L 7	70.0	19.0				305
8	52.0	18.0	106		206	106
L 8	75.0	19.0				306
9	52.0	19.0	107			
L 9	80.0	19.0				307
10	52.0	19.0	108		208	108
L 10	85.0	19.0				308
12	52.0	19.0	109			
L 12	90.0	19.0				309

51256

Hex screwdriver bits (inch)

3/8"



Design

Chrome-plated sleeve, CVD-TiN coated blade.

Quality

Chromium-vanadium steel sleeve.

51256

Sizes	l	d	51256	...
Inch	mm	mm		
1/8	50	17	301	
5/32	55	17	302	
3/16	60	17	303	
7/32	65	17	304	

Sizes	l	d	51256	...
Inch	mm	mm		
1/4	70	19	305	
5/16	75	19	306	
3/8	80	19	307	

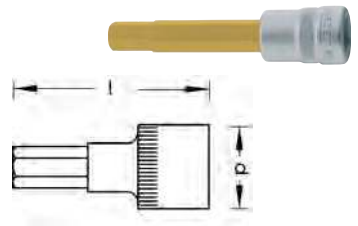

51254

Long hex ball-head screwdriver bits

3/8"



Design

Chrome-plated, with ball retaining groove. Allows a swivel angle of approximately 15–20°.

Quality

Chrome vanadium special steel, bronzed.

51254

Sizes	l	d	51254	...
mm	mm	mm		
4 L	132	17.5	100	
5 L	132	17.5	101	
6 L	132	17.5	102	

Sizes	l	d	51254	...
mm	mm	mm		
8 L	134	17.5	104	
10 L	134	19.0	105	

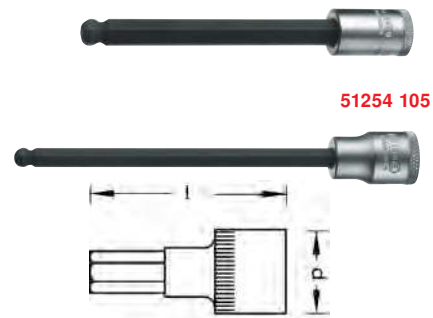

51254 105

51253

Hex ball-head screwdriver bits

3/8"



Design

Chrome-plated sleeve, CVD-TiN coated blade. Allows a swivel angle of 20°.

Quality

Chromium-vanadium steel sleeve.

51253

Sizes	l	d	51253	...
mm	mm	mm		
5	116	17	201	
6	116	17	202	
7	116	19	203	

Sizes	l	d	51253	...
mm	mm	mm		
8	116	19	204	
10	116	19	205	

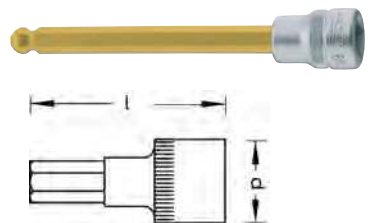

Hand tools

51257 TX® set

GEDORE
WERKZEUGE FÜR'S LEBEN

Quality
Vanadium special steel.

Note:
TX® profile gauge, see art. no. 37930.

Set contents	
✚	8 inserts for external TX® E 5/6/7/8/10/11/12/14
✚	7 inserts for internal TX® T 20/25/27/30/40/45/50

Set contents	Design	51257	...
15 pieces	in a plastic storage box		101



51258 - 51261 TX® screwdriver bits

Design
Chrome-plated.
Applications
For internal TX® screws.

Note:
TX® profile gauge, see art. no. 37930.

51258
ATORN[®]

51259
GEDORE[®]
Vanadium special steel.

51261
HAZET[®]
CVD-TiN-coated blade.
Chromium-vanadium steel sleeve.



Size	Length	ATORN [®]	...	GEDORE [®]	...	HAZET [®]	...
T	approx. mm	51258	...	51259	...	51261	...
15	43.5						101
20	43.5						102
20	47.0	101					
20	49.0			201			
25	43.5						103
25	47.0	102					
25	49.0			202			
27	43.5						104
27	47.0	103					
27	49.0			203			
30	43.5						105

Size	Length	ATORN [®]	...	GEDORE [®]	...	HAZET [®]	...
T	approx. mm	51258	...	51259	...	51261	...
30	47.0						104
30	49.0						204
40	43.5						106
40	47.0	105					
40	49.0			205			
45	43.5						107
45	47.0	106					
45	49.0			206			
50	44.5						108
50	47.0	107					
50	49.0			207			

51263 - 51264 TX® socket wrench inserts

Design
Chrome-plated.
Applications
For external TX® screws.

Note:
TX® profile gauge, see art. no. 37930.

51264
ATORN[®]
Chromium-vanadium steel.

51263
HAZET[®]
Chromium-vanadium steel.



Size	Length	ATORN [®]	...	HAZET [®]	...
E	approx. mm	51264	...	51263	...
5	28			101	201
6	28			102	202
7	28			103	203
8	28			104	204

Size	Length	ATORN [®]	...	HAZET [®]	...
E	approx. mm	51264	...	51263	...
10	28			105	205
11	28			106	206
12	28			107	207
14	28			108	208

51265 XZN screwdriver bits

HAZET[®]

Design
Chrome-plated sleeve, CVD-TiN coated blade.

Applications
For serrated socket screws (XZN).
Quality
Chromium-vanadium steel sleeve.



Size	Length	51265	...
M	mm		
5	40		201
6	40		202
8	41		203

Size	Length	51265	...
M	mm		
L 8	88		204
10	42		205
L 10	89		206

51275 - 51279

Reversible ratchets DIN 3122/ISO 3315

3/8"

Design

- Chromium-plated
- Extremely robust ratchet with rotary head for clockwise/anti-clockwise rotation
- Ergonomic plastic handle

Quality

Chromium-vanadium steel.

51275



Design

- Fine toothing (72 teeth, 5° angle of rotation)
- Ground
- Ball lock

51276



Design

- Finely toothing (60 teeth, 6° angle of rotation)
- Ideal for working in confined spaces
- With 2-component handle

Quality

Chrome alloy steel.

51277



Design

- Finely toothing (72 teeth, 5° angle of rotation)
- Deep-seated reversal knob protects against unintentional reversal
- Inductively hardened inner toothing for long service life
- With 2-component handle

Quality

Chrome-plated, polished head

51279



Design

- Finely toothing (72 teeth, 5° angle of rotation)
- The contact surface makes it possible to press on the ratchet head without having to use the switch
- Fast switching with one-handed operation



51275



51276



51277



51279

	GEDORE	...	STAHLWILLE	...	HAZET	...	FACOM	...
Total length mm	51275		51276		51277		51279	
175								101
186							102	
194					101			
200			101					

51284 - 51288

Reversible ratchets DIN 3122/ISO 3315

3/8"

Design

Chrome-plated, extremely robust ratchet with reversible clockwise/anti-clockwise rotation and ergonomic plastic handle.

Quality

Chromium-vanadium steel.

51286 101



With lever reverse and quick release pushbutton. Finely toothing, 72 teeth. Anti-slip 2-component handle with hanging hole.

51284 102



With lever reverse and pushbutton release, teardrop-shaped head for the narrowest screw positions, slip-resistant 2-component handle with hanging hole. Fine toothing with 60 teeth.

Quality

31 Cr V3.

51285 101



With lever reverse, 30 teeth.

Quality

Chrome alloy steel.

51285 103



Design

With lever reverse, quick-release safety lock and 2-component handle, 80 teeth.

Quality

Chrome alloy steel.

51287 101



With lever reverse, polished, with 30 teeth.

51287 102



With lever reverse, polished, with 30 teeth. Also with safety connection and quick release pushbutton.

51288 201



With lever reverse, nickel and chrome plated. Rounded and highly polished surfaces without any sharp edges. 80 teeth, 4.5° return angle. 2 claws that retain 7 teeth in contact with the gear at all times for maximum strength. Exceeds the torque requirements pursuant to ISO and ASME. With warm, comfortable 2-component handle, slip-resistant and with larger grip width.

Quality

Vanadium extra, precision forged and heat treated.



51286 101



51284 102



51285 101



51285 103



51287 101



51287 102



51288 201

	ATORN	...	GEDORE	...	STAHLWILLE	...	HAZET	...	BAHCO	...
Total length mm	51286		51284		51285		51287		51288	
190		101								
193							101			
193							103			
199								101		
199								102		
200				102						
205										201

Hand tools

51289

One-handed reversible ratchet DIN 3120/ISO 1174

3/8"



Design

Nickel and chrome plated, mirror polished. Smooth one-handed switching ring on the ratchet handle changes the direction of rotation with a short turn (clockwise/anti-clockwise). Integrated quick-action rotary disc on the square makes it easier to loosen and tighten screw connections. Unlocking device of

the ball catch ensures easier and faster changing of socket wrench inserts at the push of a button without effort. **Small tooth pitch (72 teeth)**, 5° return angle. Two-component plastic handle with hanging hole.

Quality
Vanadium extra.



51289 101

Total length	51289	...
mm		
215		101



51290

Jointed reversible ratchet

3/8"



Design

With lever reverse. Chrome-plated and polished.

Extremely robust ratchet with switchable clockwise and anti-clockwise rotation, movable ratchet head and ergonomic plastic handle.

Quality
Chromium-vanadium steel.



51290

Total length	51290	...
mm		
218		101

51293

Zyklop metal ratchet

3/8"



Design

- Forged **solid metal ratchet** for extremely high robustness and long service life
- With ball lock
- Slim design for work even in very tight spaces
- Fine tothing with 72 teeth for a return angle of just 5°
- Reversing lever for easy switching of direction
- With secure nut locking function

Quality

Chrome molybdenum.

Extremely slim. Long lever.



51293

Total length	51293	...
mm		
222		100



The ball locking mechanism ensures the nuts and accessories fit securely, thus ensuring reliable safety during screwing.



The finely toothed reversible ratchet with 72 teeth has a small return angle of just 5°. The small stroke enables fast and precise working in all installation positions.

Thanks to the reversing lever, it is possible to change direction quickly and easily.

51294

Zyklop Speed ratchet



3/8"



Design

- Flywheel mass design and handy rapid-turning sleeve for high working speed
- Freely tilting ratchet head
- Defined position at 0°, 90° to the left and right as well as 15° from 90° inwards
- Can be used in 0° position like a conventional screwdriver
- Pushbutton release
- Anti-clockwise/clockwise switch
- Finely toothed
- Small return angle of 5°
- Multi-component power grip for effortless work



The ratchet head can be swivelled freely and can be unlocked in any position using the slide switch on both sides.

The nut locking accelerates the insertion or removal of the inserts and extensions. The ball locking mechanism ensures the nuts and accessories fit securely, thus ensuring reliable safety during screwing. A short press on the release button and the tool can be moved to all defined positions.



The flywheel mass construction speeds up the screwing process.

The Zyklop ratchet can be switched quickly and easily to left/right motion in any position using the knurling wheel.



51294

Total length	51294	...
mm		
199		101

Hand tools

51299 - 51304

Drive elements

3/8"

Design
Chrome-plated, die-forged.
Quality
Chromium-vanadium steel.

51299
ATORN®

51300
GEDORE

51301
STÄHWILLE
Quality
Chrome alloy steel.

51302
STÄHWILLE
With quick release safety lock.
Quality
Chrome alloy steel.

51303
HAZET

51304
Drive handle



51300 201



51302 101



51304 102



	51299	...	51300	...	51301	...	51302	...	51303	...	51304	...
Handle with sliding piece			101		201		101		101			
Drive handle											102	
Cardan joint			103		203		103		103		103	
Adapter 3/8 inch □ x 1/4 inch ■			104		204		104		204			
Adapter 3/8 inch □ x 1/2 inch ■			105		205		105		205			
FixGRIP adapter 3/8 inch □ x 1/2 inch ■							106					

51308 - 51314

Extensions

3/8"

Design
Chrome-plated, die-forged.

51308
ATORN®
Chromium-vanadium steel.

51309
GEDORE
Vanadium 31CrV3.

51310
STÄHWILLE
Chrome alloy steel.

51312
HAZET
Chromium-vanadium steel.

51312 201
HAZET
Flexible extension
Shaft bronzed.

51314
STÄHWILLE
With quick release safety lock.
Chrome alloy steel.



51310 102



51314 101



51308 104



51312 104



51312 201



51309 103

Length mm	ATORN® 51308	...	GEDORE 51309	...	STÄHWILLE 51310	...	HAZET 51312	...	STÄHWILLE 51314	...
36							101			
50	100									
75	101		101		102		102		101	
125	103		102		103		103			
150	104						104			
160									102	
180			110							
202							105			
210							201			
240					105				103	
250	105		103				106			
304							107			
508							108			
711							109			

51315 Swivel extensions

3/8"



Design
Chrome-plated, polished.
Applications
With ball-shaped, conical square drive. Allows a swivel angle of 8° to each side.

Quality
Chromium-vanadium steel.

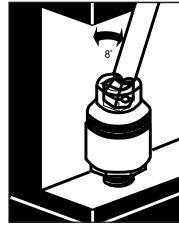

Overall length	51315	...
mm		
36		201
74		202
254		203

51316 Cardan extensions

3/8"



Design
With ball lock.

Applications
The extension enables swivelling up to 15°.

Length	51316	...
mm		
76		101
125		102
250		103



51318 Open bi-hex box wrench (crowfoot wrench)

3/8"



Design
Chrome-plated, with square drive.

Applications
Specially designed for working in hard-to-reach places.
Quality
Chromium-vanadium steel.

Size	51318	...	Size	51318	...
mm			mm		
16		101	21		105
17		102	22		106
18		103	24		107
19		104	27		109



51319 Adjustable wrench (crowfoot wrench)

51319



Design
- Opening width adjustable up to 29 mm (1 1/8 inch)
- Adjustment of the back width by simple movement of the side adjusting nut
- Lasered measuring scale in mm and inches

- Significantly exceeds the torque requirements for 3/8 inch turning tools adjustable wrenches of the same opening sizes
- ISO 1174 and DIN 3120
- Chrome-plated and high-gloss polished, high-quality surface
Quality
High-performance alloy steel.

Span width	51319	...
mm		
29		101
Span width		
inch		
1,1/8		



51320

Hexagon socket wrench set

1/2"

ATORN®

Design

In a sheet steel box with foam insert.
All tools are packed tightly so they cannot move around.

Quality
Chromium-vanadium steel.

Set contents	Design	51320	...
19 pieces	in a sheet steel box		101

Set contents	
○ 14	hex inserts with energy profile Sizes 10/11/12/13/14/15/16/17/19/22/24/27/30/32 mm
1	reversible ratchet
1	handle with sliding piece
1	cardan joint
2	extensions 125/250 mm



51320

51321

Hexagon socket wrench set

1/2"

ATORN®

Design

In a sheet steel box with foam insert. All tools are packed tightly so they cannot move around.

Quality

Chromium-vanadium steel.

Set contents	Design	51321	...
22 pieces	in a sheet steel box		101

Set contents	
○ 15	hex inserts with energy profile Sizes 10/11/12/13/14/15/16/17/18/19/22/24/27/30/32 mm
○ 2	hex inserts with energy profile for spark plugs Sizes 16/21 mm
1	reversible ratchet
1	cardan joint
1	adapter 1/2 x 3/8 inch
2	extensions 125/250 mm



51321

51328

Hexagon socket wrench set

1/2"

GEDORE®
WERKZEUGE FÜR'S LEBEN

Design

- Forged, tempered, hand-operated
hex UD profile socket wrench inserts
- Robust lever reversible ratchet with pushbutton release
- In GEDORIT blue sheet steel box
(290 x 132 x 55 mm)

Quality
Actuating tools made from GEDORE vanadium steel 31CrV3

Set contents	Design	51328	...
13 pieces	in a sheet steel box		201

Set contents	
○ 11	inserts with UD profile Sizes 10/12/13/14/15/16/17/18/19/22/24 mm
1	reversible ratchet
1	extension 125 mm



51328

51327

Hexagon socket wrench sets

1/2"

BAHCO

Design

- With dynamic drive profile
- Plastic case made from impact-resistant, oil- and heat-resistant polyethylene (HDPE),
35 x 165 x 85 mm

Quality
High-performance alloy steel, matt chrome-plated. Chromium vanadium.

Set contents	Design	51327	...
24 pieces, mm	in plastic case		101
24 pieces, inch	in plastic case		102

Set contents 51327 101	
○ 18	hex inserts with dynamic drive profile Sizes 10/11/12/13/14/15/16/17/18/ 19/20/21/22/23/24/27/30/32 mm
1	reversible ratchet, 60 teeth, 6° return angle
1	cardan joint
2	extensions 125/250 mm
1	T-sliding adapter
1	multi-angle ratchet, 250 mm

Set contents 51327 102	
○ 15	hex inserts with dynamic drive profile Sizes 3/8/7/16/1/2/9/16/5/8/11/16/3/4/13/16/ 7/8/15/16/1/1. 1/16/1. 1/8/1. 3/16/ 1. 1/4 inch
○ 2	hex inserts with dynamic drive profile for spark plugs Sizes 16/21 mm (5/8 and 13/16 inch)
1	reversible ratchet, 60 teeth, 6° return angle
1	cardan joint
2	extensions 125/250 mm (5 and 10 inches)
1	T-sliding adapter
1	multi-angle ratchet 250 mm (10 inches)
1	removable plastic sorting box with three compartments and lid

NEW

51327 101



51327 102

Socket wrench sets

51341

Hex socket wrench set



Design
With quick-release system
(single-handed safety lock).

Quality
Chrome alloy steel.



51341



Set contents

- 16 inserts with AS drive profile
Sizes 10/11/12/13/14/15/16/17/18/19/21/22/24/27/30/32 mm
- 1 reversible ratchet
- 1 handle with sliding piece
- 1 cardan joint
- 3 extensions 75/130/255 mm

Set contents	Design	51341	...
22 pieces	in a robust, stackable ABS plastic box	201	

51337

Bi-hexagon socket wrench sets



Design
Chrome-plated.
Quality
Chrome alloy steel.



51337 107



Set contents 51337 107

- 16 inserts with AS drive profile Sizes 10/11/12/13/14/15/16/17/18/19/21/22/24/27/30/32 mm
- 1 reversible ratchet
- 1 handle with sliding piece
- 1 cardan joint
- 3 extensions 75/130/255 mm

Set contents 51337 109

- 22 inserts with AS drive profile Sizes 8/9/10/11/12/13/14/15/16/17/18/19/20/21/22/23/24/26/27/28/30/32 mm
- 1 reversible ratchet
- 1 handle with sliding piece
- 1 cardan joint
- 3 extensions 75/130/255 mm

Set contents	Design	51337	...
22 pieces	in a robust, stackable ABS plastic box	107	
28 pieces	in a robust, stackable ABS plastic box	109	

51337 109



51338 - 51339

Hex and bi-hex socket wrench sets



Design
In SmartCase 355 x 235 x 65 mm. In safety insert system. 2-component soft foam insert. All tools are packed tightly so they cannot move around.

Quality
Chromium-vanadium steel.



51338



51339

1/2"

Set contents

- 20 inserts with traction profile
Sizes 10/11/12/13/14/15/16/17/18/19/20/21/22/23/24/26/27/28/30/32 mm
- 1 reversible ratchet
- 1 handle with sliding piece
- 1 cardan joint
- 2 extensions 123/248 mm

Set contents	Design	Hex 51338	...	Bi-hex 51339	...
25 pieces	in SmartCase with soft foam insert	101		101	



51348

Hexagon socket wrench set

1/2"

**ATORN®**Quality
Chromium-vanadium steel.

51348

Design

All tools are packed tightly so they cannot move around.

Set contents

- 18 hex inserts with energy profile
Sizes 10/11/12/13/14/15/16/17/18/19/20/21/22/23/24/27/30/32 mm
- 5 inserts for hexagon socket screws Sizes 7/8/10/12/14 mm
- ⊕ 2 inserts for Phillips-head screws PH 3/4
- ⊗ 5 inserts for internal TX® screws T 30/40/45/55/60
- 1 adapter 3/8 inch x 1/2 inch
- 1 reversible ratchet
- 1 cardan joint



Set contents	Design	51348	...
35 pieces	in a sheet steel box with foam inserts		101

51349

Hexagon socket wrench set

1/4"

1/2"

**ATORN®**Quality
Chromium-vanadium steel.

51349

Design

All tools are packed tightly so they cannot move around.

Set contents

- 1/4" ○ 5 hex inserts with energy profile Sizes 5.5/7/8/10/13 mm
- 3 inserts for hexagon socket screws Sizes 3/4/5 mm
- 1 of each reversible ratchet, handle with sliding piece, cardan joint
- 2 extensions 50/105 mm
- 1/2" ○ 11 hex inserts with energy profile Sizes 10/13/16/17/18/19/22/24/27/30/32 mm
- 6 inserts for hexagon socket screws Sizes 6/8/10/12/14/17 mm
- 1 of each reversible ratchet, handle with sliding piece, cardan joint
- 2 extensions 125/250 mm



Set contents	Design	51349	...
35 pieces	in a sheet steel box with foam insert		201

51357

Socket wrench set

1/4"

1/2"



Applications

For opening hex, bi-hex, inch and E-TX profiles.

Quality

Chromium-vanadium steel.

51357

Set contents

- | | |
|--|--|
| <ul style="list-style-type: none"> 1/4" 13 inserts
Sizes 4/4.5/5/5.5/6/7/8/9/10/
11 / 12 / 13 / 14 mm ● 4 bits for hexagon socket screws
Sizes 3/4/5/6 mm ⊖ 3 bits for slotted screws 4/5.5/7 mm ⊕ 2 bits for Phillips-head screws PH 1/2 ⊕ 2 bits for Phillips-head screws PZ 1/2 ⊗ 6 bits for TX® screws
T 8/10/15/20/25/30 1 reversible ratchet 1 handle with sliding piece 1 drive handle with plastic handle 1 cardan joint 1 flexible extension 150 mm 2 extensions 50/100 mm 1 adapter square drive x hexagon head | <ul style="list-style-type: none"> 1/2" 18 inserts
Sizes 10/11/12/13/14/15/16/17/18/
19/20/21/22/23/24/27/30/32 mm ○ 2 spark plug inserts Sizes 16/21 mm 1 reversible ratchet 1 cardan joint 2 extensions 125/250 mm 1 adapter 1/2 inch x 8 mm/bit adapter 1 sliding handle adapter 3/8 inner x 1/2 outer ○ bits with bit holder 8 mm: ⊖ 3 bits for slotted screws 8/10/12 mm ⊕ 2 bits for Phillips-head screws PH 3/4 ⊕ 2 bits for Phillips-head screws PZ 3/4 ⊗ 4 bits for TX® screws T 40/45/50/55 4 bits for hexagon socket screws
Sizes 8/10/12/14 mm ● 3 hex pin wrenches Sizes 1.5/2.0/2.5 mm |
|--|--|



Set contents	Design	51357	...
82 pieces	in aluminium case with removable tool insert		101

Socket wrench sets

51352

Hexagon socket wrench set



GEDORE
WERKZEUGE FÜR'S LEBEN

Design

With forged, tempered hex UD inserts and actuating tools.

Quality

Vanadium 31CrV3.

51352



Set contents	
1/4" ○ 11	hex inserts with UD profile Sizes 4/4.5/5.5/6/7/8/9/10/11/13 mm
● 4	inserts for hexagon socket screws Sizes 3/4/5/6 mm
⊖ 3	inserts for slotted screws 0.8 x 4/1.0 x 5.5/1.2 x 6.5 mm
⊕ 2	inserts for Phillips-head screws PH 1/2
2	extensions 55/97 mm
1	cardan joint
1	handle with sliding piece
1	drive handle with plastic handle
1	reversible ratchet with shift lever

1/2" ○ 12	hex inserts with UD profile Sizes 10/11/12/13/14/15/17/19/22 / 24 / 27 / 30 mm
● 5	inserts for hexagon socket screws Sizes 7/8/10/12/14 mm
⊖ 2	inserts for slotted screws 1.2 x 8/1.6 x 10 mm
⊕ 1	insert for Phillips-head screws
2	extensions 125/250 mm
1	cardan joint
1	reversible ratchet with shift lever

Set contents	Design	51352	...
50 pieces	in a sheet steel box		101

51359

Hexagon socket wrench set



BAHCO

Design

With dynamic drive profile. Matt chrome-plated
Plastic case made from impact-resistant, oil- and temperature-resistant polyethylene (HDPE), 375 x 320 x 110 mm.

Quality

Chromium vanadium.



51359



Set contents	
1/4" ○ 12	hex inserts with dynamic drive profile Sizes 4/4.5/5.5/6/7/8/9/10/11/12/13 mm
○ 10	long hex inserts with dynamic drive profile Sizes 4/5/6/7/8/9/10/11/12/13 mm
● 6	bits for hexagon socket screws Sizes 3/4/5/6/8/10 mm
⊖ 3	bits for slotted screws 4/5.5/7 mm
⊕ 5	bits for Phillips-head screws PH size 0/1/2/3/4
⊕ 3	bits for Phillips-head screws PZ Sizes 1/2/3
★ 8	bits for TX® screws T 8/10/15/20/25/27/30/40
1 of each	reversible ratchet 60 teeth, T-sliding handle (t-handle) 105 mm, drive handle
1 of each	cardan joint, extension 50/100 mm
1 of each	magnet holder, connector 1/4 inch, bit holder
1/2" ○ 13	hex inserts with dynamic drive profile Sizes 10/11/12/13/14/15/17/19/22/24/27/30/32 mm
○ 1	spark plug socket wrench insert Size 21 mm (13/16 inch)
1 of each	reversible ratchet 60 teeth, cardan joint, T-sliding adapter
1 of each	extension 125/250 mm 5/16 inch bit holder .
5/16" ★ 3	bits for TX® screws T 45/50/55
6	combination spanners Sizes 8/10/12/13/14/17 mm
4	joint socket wrenches Sizes 8x9/10x11/12x13/14x15 mm
● 3	hexagon socket Allen keys Sizes 1.5/2/2.5 mm

Set contents	Design	51359	...
92 pieces	in plastic case		201

51351

Hexagon socket wrench set



STAHLWILLE

Design

Chrome-plated.

Quality

Chrome alloy steel.

51351



Set contents	
1/4" ○ 9	hex inserts with AS drive profile Sizes 4/5/5.5/6/7/8/9/10/11 mm
● 3	inserts for hexagon socket screws Sizes 3/4/5 mm
1	reversible ratchet
1	drive handle with plastic handle
1	handle with sliding piece
2	extensions
1	cardan joint

1/2" ○ 10	hex inserts with AS drive profile Sizes 13/16/17/18/19/21/22/24/27/30 mm
● 5	inserts for hexagon socket screws Sizes 6/8/10/12/14 mm
1	reversible ratchet
1	handle with sliding piece
2	extensions 130/255 mm
1	cardan joint

Set contents	Design	51351	...
38 pieces	in a robust, stackable ABS plastic box		101

Hand tools

51355

Hexagon socket wrench set



Quality
Chromium-vanadium steel.

51355



Set contents			
Ⓣ	18 hex inserts with traction profile		
	Sizes 10/11/12/13/14/15/17/19/20/21/22/23/24/26/27/28/30/32 mm		
⬡	7 short inserts for hexagon socket screws	Sizes 5/6/7/8/10/12/14 mm	
⊕	4 bits for Phillips-head screws PH	1/2/3/4	
⊕	4 bits for Phillips-head screws PZ	1/2/3/4	
⊛	5 bits for internal TX® screws	T 27/30/40/45/50	
	1 of each connector for 3/8 inch bits, reversible ratchet, handle with sliding piece, cardan joint		
	2 extensions	123/248 mm	
Set contents	Design	51355	...
44 pieces	in Smart Case with soft foam insert		101

51340

Zyklop ratchet sets

1/2"



51340 100

Design

- Zyklop metal ratchet set with forged **solid metal ratchet** with 72 teeth for outstanding robustness over a long service life

- Ultra-slim design for work even in very tight spaces
- In a robust, foldable fabric bag for safe storage

Quality
Chrome molybdenum.



51340 100

Set contents 51340 100	
1	Zyklop metal ratchet
⊖ 10	Zyklop hex inserts Sizes 10/11/12/13/14/15/16/17/18/19 mm
1	Zyklop extension with rapid-turning sleeve 250 mm
1	Zyklop wobble extension 52 mm
⊖ ⊖ 1	Zyklop connector with quick-change chuck 5/16 inch hex x 1/2 inch square
⊕ 2	bits for Phillips-head screws PH 2/3
⊛ 8	bits for TX® screws T 20/25/27/30/40/45/50/55
⬡ 4	bits for hexagon socket screws Hex-Plus 5/6/8/10 x 30 mm



51340 101

Design

Zyklop socket wrench set in a robust, foldable fabric bag for safe storage with a Zyklop Speed ratchet. With the Zyklop Speed ratchet, you get 6 tools in one:

1. Fine-tooth ratchet
2. Jointed ratchet
3. Angled ratchet
4. Ratchet with safety lock
5. Power ratchet
6. Screwdriver.



51340 101

Set contents 51340 101	
1	Zyklop Speed ratchet
⊖ 10	Zyklop hex inserts Sizes 10/11/12/13/14/15/16/17/18/19 mm
1	Zyklop extension with rapid-turning sleeve 250 mm
1	Zyklop wobble extension 52 mm
⊖ ⊖ 1	Zyklop connector with quick-change chuck 5/16 inch hex x 1/2 inch square
⊕ 2	bits for Phillips-head screws PH 2/3
⊕ 2	bits for Phillips-head screws PZ 2/3
⊛ 6	bits for TX® screws T 20/25/30/40/45/50
⬡ 4	bits for hexagon socket screws Hex-Plus 5/6/8/10 x 30 mm



51340 102

Design

- Zyklop hybrid ratchet with reversing lever with 1/2 drive, low weight, ergonomic Kraftform

handle, slim head geometry, a long lever and extension option
- In a robust, foldable fabric bag for safe storage



51340 102

Set contents 51340 102	
1	Zyklop hybrid ratchet
⊖ 10	Zyklop hex inserts Sizes 10/11/12/13/14/15/16/17/18/19 mm
1	Zyklop hybrid extension with release pin 271 mm
1	Zyklop extension with rapid-turning sleeve 250 mm

Set contents	Design	51340	...
28 pieces	in a robust, foldable fabric bag		100
28 pieces	in a robust, foldable fabric bag		101
13 pieces	in a robust, foldable fabric bag		102



Socket wrench sets

51343

Zyklop Speed ratchet set

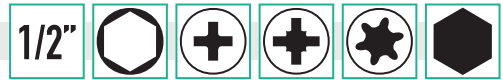

Design

- Fitting diagram and practical foam insert makes it easier to sort missing tools
- Zyklop Speed ratchet with freely movable ratchet head with 5 defined fixed positions (0°/15°/90°)
- Fine toothing with 72 teeth and 5° return angle
- 0° position can be used as a conventional screwdriver
- Socket wrench with **Take it Easy tool finder**



NEW

51343



Set contents

- 1 Zyklop Speed ratchet
- 17 Zyklop hex inserts Sizes 10/11/12/13/14/15/16/17/18/19/20/21/22/24/27/30/32 mm
- 1 Zyklop t-handle 250 mm
- 1 Zyklop wobble extension 52 mm
- 1 Zyklop cardan joint 69 mm
- 1 Zyklop connector 50 mm
- 1 Zyklop flexible-lock extension with rapid-turning sleeve, short 125 mm
- 1 Zyklop flexible-lock extension with rapid-turning sleeve, long 250 mm
- 1 bit for Phillips-head screws PH 3 x 32 mm
- 1 bit for Phillips-head screws PZ 3 x 32 mm
- 7 bits for TX® screws T 20/25/30/40/45/50/55 x 35 mm
- 4 bits for hexagon socket screws Hex-Plus 5/6/8/10 x 30 mm

Set contents Design

51343 ...

37 pieces in a sturdy tool case

100

51353 - 51354

Hex and bi-hex socket wrench sets



Design

Chrome-plated.

Quality

Chrome alloy steel.



51353 102



51354 201



Set contents 51353 102 + 51354 201

- 17 inserts with AS drive profile Sizes 8/10/11/12/13/14/15/16/17/18/19/21/22/24/27/30/32 mm
- 8 inserts for hexagon socket screws Sizes 4/5/6/7/8/10/12/14 mm
- 1 of each reversible ratchet, handle with sliding piece, cardan joint
- 3 extensions 75/130/255 mm

Set contents 51354 110

- 19 inserts with AS drive profile Sizes 8/9/10/11/12/13/14/15/16/17/18/19/21/22/24/27/30/32/34 mm
- 2 bi-hex inserts with AS drive profile Sizes 20.8 mm 13/16 inch and 16 mm 5/8 inch with rubber insert for spark plugs
- 7 inserts for hexagon socket screws Sizes 4/5/6/7/8/10/12 mm
- 13 combination spanners Sizes 10/11/12/13/14/15/16/17/18/19/21/22/24 mm
- 1 of each reversible ratchet, handle with sliding piece, 1 x cardan joint
- 3 extensions 75/130/255 mm

51354 110



Set contents	Design	Hexagon	...	Bi-Hexagon	...
31 pieces	in a robust, stackable ABS plastic box	51353	102	51354	201
47 pieces	in a robust, stackable ABS plastic box				110

59362

Hexagon socket wrench set

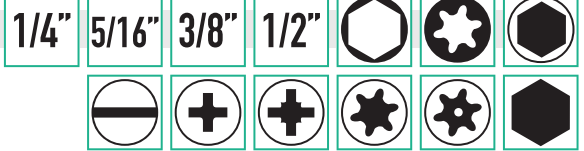

Design

- Robust plastic case protects tool from dirt
- All tools are securely held in a plastic insert
- Plastic insert prevents tools from falling out and any missing tools are noticed immediately
- Includes 3 fine-tooth reversible ratchets
- 1/4, 3/8, 1/2 inch
- All ratchets have 72 teeth and a rotation angle of 5°
- Ergonomic shape of the ratchet allows work even in confined spaces
- Plastic coating provides approximately 33% weight saving compared to conventional reversible ratchets
- The release button is used to release the socket wrench insert easily

59362 201



Hand tools

Set contents	Design	59362	...
172 pieces	in plastic case		201

Set contents 59362 201

1/4"	13	hex socket wrench inserts, length 25 mm, Sizes 4/4.5/5/5.5/6/7/8/9/10/11/12/13/14 mm
	7	hex socket wrench inserts, long, length 50 mm, Sizes 4/5/6/7/8/9/10 mm
	5	TX® socket wrench inserts, length 24.8 mm, E 4/5/6/7/8
	4	hexagon socket screwdriver bits, length 38 mm, Sizes 3/4/5/6 mm
	4	slotted screwdriver inserts, length 38 mm, Sizes 0.8 x 4/1 x 5.5/1.2 x 6.5/1.2 x 7 mm
	3	Phillips screwdriver bits, length 38 mm, PH 0/1/2
	3	Phillips screwdriver bits, length 38 mm, PZ 0/1/2
	8	TX® screwdriver bits, length 38 mm, T 8 (length 37 mm)/9/10/15/20/25/27 (length 37 mm) 30
	8	TX® screwdriver bits with hole, length 37 mm, T 8H/9H (length 38 mm)/10H/15H/20H/25H/27H/30H
	1	fine tooth reversible ratchet, 150 mm
	2	extensions, 50 mm/100 mm
	1	drive handle, 150 mm
	1	slide handle, 110 mm
	1	universal joint, 40 mm
	1	adapter 1/4 inch hex x 1/4 inch square, 30 mm
	7	Allen keys, Sizes 1.27/1.5/2/2.5/3/4/5 mm
	3	TX® sockets, T 5/6/7
	9	TX® sockets with hole, T 7H/10H/15H/20H/25H/27H/30H/40H/45H
	5	HexPlus bit inserts, R 5/6/7/8/9
	3	triple square bit inserts, M 5/6/8
5/16"	5	hex bit screwdriver bits, Sizes 7/8/10/12/14 mm
	3	slotted bit screwdriver bits, Sizes 8/10/12 mm
	2	slotted bit screwdriver bits, PH 3/4
	2	slotted bit screwdriver bits, PZ 3/4
	6	TX® bit screwdriver bits, T 40/45/50/55/60/70
	6	TX® bit screwdriver bits with hole, T 40H/45H/50H/55H/60H/70H
3/8"	10	hex socket wrench inserts, length 28 mm, Sizes 10/11/12/13/14/15/16/17 (length 30 mm)/18 (length 30 mm)/19 mm (length 30 mm)
	6	hex socket wrench inserts, long, length 63 mm, Sizes 10/11/12/13/14/15 mm
	1	hex spark plug insert, long, length 66 mm, Size 18 mm
	6	TX® socket wrench inserts, length 28 mm, E 10/11/12/14/16/18
	1	fine tooth reversible ratchet, 198 mm
	1	extension, 125 mm
	1	universal joint, 56 mm
	1	bit adapter, 5/16 inch hex x 3/8 inch square, 30 mm
1/2"	17	hex socket wrench inserts, length 38 mm, Sizes 10/11/12/13/14/15/16/17/18/19/20/21/22/24/27 (length 42 mm)/30 (length 44 mm)/32 mm (length 44 mm)
	5	hex socket wrench inserts, long, length 77 mm, Sizes 16/17/18/19/22 mm
	2	hex spark plug inserts, length 66 mm, Sizes 16/21 mm
	2	TX® screwdriver bits, length 38 mm, E 20/22
	1	fine tooth reversible ratchet, 250 mm
	2	extensions, 125 mm/250 mm
	1	sliding piece, 1/2 inch square x 3/8 inch square
	1	universal joint, 75 mm
	1	adapter, 5/16 inch hex x 1/2 inch square

Socket wrench sets | Tool cases

59362

Hexagon socket wrench set

1/4"

5/16"

3/8"

1/2"



Design

- Robust plastic case protects tool from dirt
- All tools are securely held in a plastic insert
- Plastic insert prevents tools from falling out and any missing tools are noticed immediately
- Includes 3 fine-tooth reversible ratchets 1/4, 3/8, 1/2 inch
- All ratchets have 72 teeth and a rotation angle of 5°
- Ergonomic shape of the ratchet allows work even in confined spaces
- Plastic coating provides approximately 33% weight saving compared to conventional reversible ratchets
- The release button is used to release the socket wrench insert easily
- Complete professional set including all important actuating tools, extensions, swivel joints, adapter, drive handle, etc.

59362 202



Set contents	Design	59362	...
212 pieces	in plastic case		202

Set contents 59362 202

	12	combination spanners, Sizes 8/9/10/11/12/13/14/15/16/17/18/19/22 mm
1/4"	13	hex socket wrench inserts, length 25 mm, Sizes 4/4.5/5/5.5/6/7/8/9/10/11/12/13/14 mm
	7	hex socket wrench inserts, long, length 50 mm, Sizes 4/5/6/7/8/9/10 mm
	5	TX® socket wrench inserts, length 24.8 mm, E 4/5/6/7/8
	4	hexagon socket screwdriver bits, length 38 mm, Sizes 3/4/5/6 mm
	4	slotted screwdriver bits, length 38 mm, Sizes 0.8 x 4/1 x 5.5/1.2 x 6.5/1.2 x 7 mm
	3	Phillips screwdriver bits, length 38 mm, PH 0/1/2
	3	Phillips screwdriver bits, length 38 mm, PZ 0/1/2
	8	TX® screwdriver bits, length 37 mm, T 8/9/10/15/20/25/27/30
	8	TX® screwdriver bits with hole, length 37 mm, T 8H/9H (length 38 mm)/10H/15H/20H/25H/27H/30H
	1	fine tooth reversible ratchet, 150 mm
	2	extensions, 50 mm/100 mm
	2	drive handles, 150 mm/205 mm
	1	slide handle, 110 mm
	1	universal joint, 40 mm
	1	adapter, 1/4 inch hex x 1/4 inch square, 30 mm
	7	Allen keys, Sizes 1.27/1.5/2/2.5/3/4/5 mm
	6	hexagon socket bit inserts with pin, Sizes 2/2.5/3/4/5/6 mm
	4	square socket bit inserts, Sizes 0/1/2/3 mm
	3	TX® sockets, T 5/6/7
	9	TX® sockets with hole, T 7H/10H/15H/20H/25H/27H/30H/40H/45H
	5	HexPlus bit inserts, R 5/6/7/8/9
	3	triple square bit inserts, M 5/6/8
	3	open-end bit inserts, Sizes 6/8/10 mm
	3	butterfly bit inserts, # 1/2/3
	4	TRI-WING® bit inserts, # 1/2/3/4
	4	TORQ® set bit inserts, # 4/6/8/10
5/16"	4	hexagon socket screwdriver bits Sizes 7/8/10/12 mm
	3	slotted bit screwdriver bits, Sizes 8/10/12 mm
	3	slotted bit screwdriver bits, PH 2/3/4
	3	slotted bit screwdriver bits, PZ 2/3/4
	5	TX® bit screwdriver bits, T 40/45/50/55/60
	5	TX® bit screwdriver bits with hole, T 40H/45H/50H/55H/60H
	4	HexPlus bit screwdriver bits, R 10/11/12/13
	2	triple square bit screwdriver bits, M 10/12
	1	bit screwdriver bit, Size 50 mm
3/8"	10	hex socket wrench inserts, length 28 mm, Sizes 10/11/12/13/14/15/16/17 (length 30 mm)/18 (length 30 mm)/19 mm (length 30 mm)
	6	hex socket wrench inserts, long, length 63 mm, Sizes 10/11/12/13/14/15 mm
	6	TX® socket wrench inserts, length 28 mm, E 10/11/12/14/16/18
	1	fine tooth reversible ratchet, 198 mm
	1	extension, 125 mm
	2	universal joints, 30 mm/56 mm
	1	adapter, 5/16 inch hex x 1/4 inch square, 30 mm
1/2"	14	hex socket wrench inserts, length 38 mm, Sizes 13/14/15/16/17/18/19/20/21/22/24/27 (length 42 mm)/30 (length 44 mm)/32 mm (length 44 mm)
	5	hex socket wrench inserts, long, length 77 mm, Sizes 16/17/18/19/22 mm
	3	TX® screwdriver bits, length 38 mm, E 20/22/24
	1	fine tooth reversible ratchet, 250 mm
	2	extensions, 125 mm/250 mm
	1	sliding piece, 1/2 inch square x 3/8 inch square
	1	universal joint, 75 mm
	1	adapter, 5/16 inch hex x 1/2 inch square



59362

Universal tool case



Design

- Robust plastic case protects tool from dirt
- All tools are securely held in a plastic insert
- Plastic insert prevents tools from falling out and any missing tools are noticed immediately
- Includes 2 fine-toothed reversible ratchets 1/4, 1/2 inch
- All ratchets have 72 teeth and a rotation angle of 5°
- Ergonomic shape of the ratchet allows work even in confined spaces
- Plastic coating provides approximately 33% weight saving compared to conventional reversible ratchets
- The release button is used to release the socket wrench insert easily

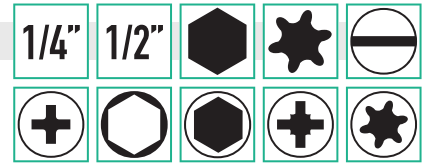

59362 203



Hand tools

Set contents	Design	59362	...
95 pieces	in plastic case		203

Set contents 59362 203

	12	combination spanners, Sizes 8/9/10/11/12/13/14/15/16/17/18/19 mm
●	9	hex Allen keys (set in the clip), 1.5/2/2.5/3/4/5/6/8/10 mm
★	9	TX® Allen keys (set in the clip), T 10/15/20/25/27/30/40/45/50
⊖	4	screwdrivers for slotted screws, 3 x 75/4 x 80/5.5 x 125/6.5 x 150 mm
⊕	3	screwdrivers for Phillips-head screws, PH 0 x 75/1 x 80/2 x 100 mm
	1	round pan pliers, length 200 mm
	1	side cutters, length 160 mm
	1	machinist's hammer, 300 g, length 300 mm
	1	universal knife
1/4" ○	12	hexagon socket wrench inserts, Sizes 4/4.5/5/5.5/6/7/8/9/10/11/12/13 mm
●	4	hexagon socket screwdriver bits, Sizes 3/4/5/6 mm
⊖	3	slotted screwdriver bits, 0.8 x 4/1 x 5.5/1.2 x 6.5 mm
⊕	3	Phillips screwdriver bits, PH 1/2 3
⊕	3	Phillips screwdriver bits, PZ 1/2 3
★	7	TX® screwdriver bits, T 10/15/20/25/27/30/40
	1	fine tooth reversible ratchet, 150 mm
	1	extension, 100 mm
	1	cardan joint, 40 mm
1/2" ○	16	hex socket wrench inserts, Sizes 10/11/12/13/14/15/16/17/19/20/21/22/24/27/30/32 mm
	1	fine tooth reversible ratchet, 250 mm
	1	extension, 125 mm
	1	cardan joint, 75 mm

51374

Connector strip, magnetic (empty)

1/2"



GEDORE
WERKZEUGE FÜR'S LEBEN

Design

Square drives suitable for socket wrench inserts nominal size 12.5 (1/2 inch). **2 additional square drive adapters for ratchets, sliding handles, extensions etc.** Strong magnet allows secure attachment of the strip to metal objects. Additional holes in the strip allow mounting on non-metallic objects and walls.

By turning through 90°, the inserts on the square are securely locked by the ball.
Turning by 90° in the opposite direction unlocks the inserts so they can be removed.

Supplied without tools.

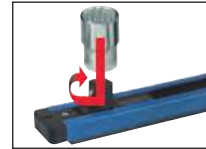
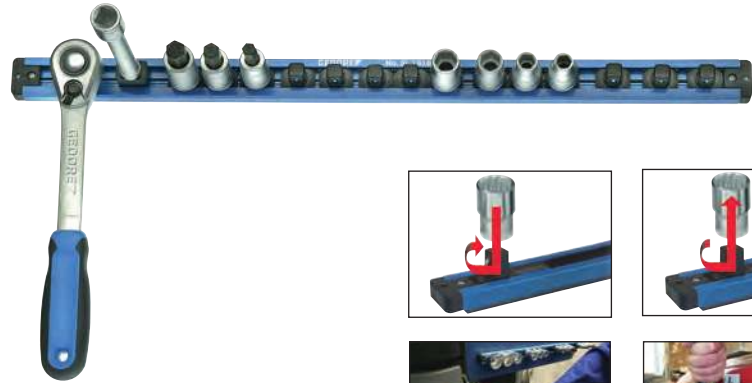

For inserts Units	Length mm	Width mm	Weight g	51374	...
16	580	33	550		101

Hand tools

51375 - 51379

Hexagon socket wrench inserts DIN 3124/ISO 2725

1/2"



Design

- Chromium-plated
- Die-forged

Quality

Chromium-vanadium steel.

51375

ATORN

- With side hole
- With energy profile

51377

GEDORE
WERKZEUGE FÜR'S LEBEN

- With UD profile

Quality

31 Cr V3.

51378

STAHLWILLE

- With AS drive profile

Quality

HPQ steel.

51379

HAZET

- With traction profile

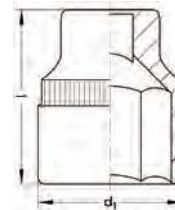

51375



51377



51378



51379



Sizes mm	l approx. mm	d ₁ approx. mm	ATORN®		GEDORE		STAHLWILLE		HAZET	
			51375	...	51377	...	51378	...	51379	...
8	36	13.0		201				101		101
9	36	14.0		202				102		102
10	38	15.0		203			103	103		103
11	38	16.5		204			104	104		104
12	38	18.0		205			105	105		105
13	38	19.0		206			106	106		106
14	38	20.5		207			107	107		107
15	38	21.5		208			108	108		108
16	38	22.5		209			109	109		109
17	38	24.0		210			110	110		110
18	38	25.5		211			111	111		111
19	38	26.5		212			112	112		112
20	38	28.0		213			113	113		113
21	38	29.0		214			114	114		114
22	41	30.5		215			115	115		115
23	41	31.5		216			116	116		116
24	41	33.0		217			117	117		117
25	41	34.0					118			118
26	41	35.5		219			119			119
27	44	36.5		220			120			120
28	44	38.0		221			121			121
29	44	39.0								122
30	44	40.5		223			123			123
32	45	42.5		225			125			125
34	45	45.5					126			126
36	44.5	48.0					127			127



51381 400 - 401

Design

- With **Take it Easy tool finder**: Colour coding by size
- With holding function to facilitate screwing by reducing the risk of dropping and losing the screw when positioning it into the workpiece

Applications

For manual and machine operation (non impact).

Quality

In brushed chromium-plated vanadium.

51381 400

Design

- **Set comprising 10 pieces**
- Compact and highly robust fabric box, low weight, low volume
- Knurling at the rear end for strong grip during manual operation



51381 400



51381 401

Design

- **Set comprising 6 pieces**
- Nut set on a robust textile belt
- Smooth rotary mechanism ensures both secure and rattle-free storage as well as easy removal of the tool
- The fleece backing and adhesive strip enable the textile belt to be attached to a wall, shelf, workshop trolley and the Wera 2go tool transport system, for example
- The robust textile belt can be fixed to belt loops or pockets using the snap hook
- The nut removal tool makes it easy to remove screw nuts from socket wrench inserts with the holding function



51381 401



Hand tools

Contents	Set contents Sizes	Design	Set 51381	...
10 pieces	10/11/12/13/14/15/16/17/18/19	with holding function	in fabric bag	400
6 pieces	10/13/15/16/17/19	with holding function	in a robust textile belt	401 NEW



Safe and easy removal

The new smooth rotary mechanism ensures both secure and rattle-free storage as well as easy removal of the tool.



Socket wrench insert with holding function for hexagon head screws

The hexagon head screw is held securely in the socket wrench insert by two spring-loaded balls and permanently elastic, high-strength heat-shrink tubing. This is protected effectively against mechanical damage by a front steel band. Especially useful in hard-to-reach areas where you cannot use your other hand to hold the screw.

without holding function

Sizes mm	l mm	d ₁ mm	51381	...
10	37	15.5	201	
11	37	16.5	202	
12	37	17.5	203	
13	37	19.0	204	
14	37	20.0	205	
15	37	21.0	206	
16	37	22.5	207	
17	37	24.0	208	
18	37	25.0	209	
19	37	26.5	210	

with holding function

Sizes mm	l mm	d ₁ mm	51381	...
10	37	17.8	301	
11	37	18.8	302	
12	37	20.4	303	
13	37	21.4	304	
14	37	22.6	305	
15	37	23.6	306	
16	37	25.0	307	
17	37	26.8	308	
18	37	28.0	309	
19	37	29.2	310	

51381 201-210 + 301-310

Design

- With ball-securing groove
- Knurling at the rear end for strong grip during manual operation
- With **Take it Easy tool finder**: Colour coding by size

Applications

For manual and machine operation (non impact). For hexagon head screws and nuts.

Quality

In brushed chromium-plated vanadium.

51381 201-210



51381 301-310



51381 201-210

Design

- Without holding function

51381 301-310

Design

- **With holding function** to facilitate screwing by reducing the risk of dropping and losing the screw when positioning it into the workpiece

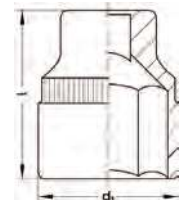

Socket wrench inserts | Screwdriver bits

51394 - 51396

Bi-hexagon socket wrench inserts DIN 3124/ISO 2725



Design
Chrome-plated, die-forged.

51394
GEDORE
With UD profile.
Quality
31 Cr V3.

51395
STAHLWILLE
With AS drive profile.
Quality
HPQ steel.

51396
HAZET
With traction profile
Quality
Chromium-vanadium steel.

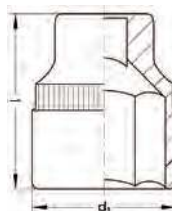

51394



51395



51396



Sizes	l mm approx.	d ₁ mm approx.	GEDORE		STAHLWILLE		HAZET	
			51394	...	51395	...	51396	...
8	38.0	13.0					101	101
9	38.0	14.0					102	102
10	38.0	15.5		103			103	103
11	38.0	16.5		104			104	104
12	38.0	18.0		105			105	105
13	38.0	19.0		106			106	106
14	38.0	20.5		107			107	107
15	38.0	21.5		108			108	108
16	38.0	22.5		109			109	109
17	38.0	24.0		110			110	110
18	38.0	25.5		111			111	111
19	38.0	26.5		112			112	112

Sizes	l mm approx.	d ₁ mm approx.	GEDORE		STAHLWILLE		HAZET	
			51394	...	51395	...	51396	...
20	38.0	28.0					113	113
21	38.0	29.0			114		114	114
22	41.5	30.5			115		115	115
23	41.5	31.5					116	116
24	41.5	33.0			117		117	117
25	41.5	34.0					118	118
26	41.5	35.5					119	119
27	44.0	36.5			120		120	120
28	44.0	38.0					121	121
30	44.0	40.5			123		123	123
32	44.0	42.5			125		125	125
34	44.0	45.0					126	126

Hand tools

51401 - 51405

Long bi-hex socket wrench inserts DIN 3124/ISO 2725

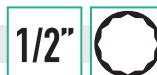

Design
Long, chrome-plated, die-forged and polished.

Applications
For deep-seated screws and protruding pins.

Quality
Chromium-vanadium steel.

51401
ATORN

With energy profile.

Note:
End no. 112 hex spark plugs insert with rubber insert for spark plugs.

51402
GEDORE
With UD profile.

51403
STAHLWILLE
With AS drive profile.
Quality
HPQ steel.

51405
HAZET
With traction profile
Note:
End no. 109 with rubber insert for spark plugs.

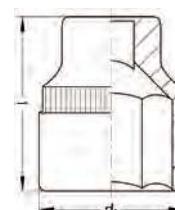

51401



51402



51403



51405



Sizes	l mm	d ₁ approx. mm	ATORN		GEDORE		STAHLWILLE		HAZET	
			51401	...	51402	...	51403	...	51405	...
10	82	15.5			101		101			101
11	82	16.5			102					117
12	82	17.5			103					102
13	82	19.0			104		103		103	103
14	82	20.0			105		104		104	104
15	82	21.5			106					118
16	82	23.0			107		105		106	105
17	82	24.0			108		106		108	106
18	82	24.5			109		107		109	107
19	82	27.0			110		108		110	108
20	82	28.0			111					
20.8	82	28.5								109
21	65	27.7			112					
21	82	28.5			113		110		113	110
22	82	30.0			114		111		114	111
23	82	31.5			115					
24	82	32.5			116		112		115	112
26	82	35.0			117					
27	82	36.5			118		113		117	113
30	82	40.0			119		114		119	114
32	82	43.0			120		115		120	
34	82	45.0					116			

51409

Bi-hex socket wrench inserts (inch) DIN 3124/ISO 2725

1/2"



Quality
Chromo extra.

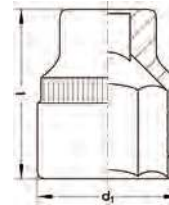

51409

Design

American inch sizes. With dynamic drive profile.
Nickel and chrome plated, mirror polished.

Width Inch	l mm	d ₁ mm	51409	...
3/8	38	14.5	101	
7/16	38	16.6	102	
1/2	38	18.8	103	
9/16	38	20.8	104	
19/32	38	21.6	105	
5/8	38	22.9	106	
11/16	38	24.7	107	
3/4	38	26.6	108	
25/32	38	27.9	109	

Sizes Inch	l mm	d ₁ mm	51409	...
13/16	39	28.7	110	
7/8	39	30.7	111	
15/16	41	32.7	112	
1.	42	34.7	113	
1.1/16	44	36.6	114	
1.1/8	46	38.6	115	
1.3/16	47	40.4	116	
1.1/4	47	42.3	117	

51410

Screwdriver bits

1/2"



Design

Chrome-plated, bronzed blades.

Quality

Vanadium special steel.

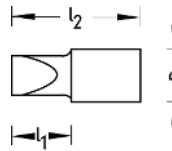

51410 102-106



51410 201-203



51410 301-303

Blade thickness x width mm	Size PH	Size PZ	l ₁ approx. mm	l ₂ approx. mm	d approx. mm	51410	...
⊖ 1.2 x 8			22	60	22.5	102	
⊖ 1.6 x 10			22	60	22.5	104	
⊖ 2.0 x 12			22	60	22.5	105	
⊖ 2.5 x 14			20	60	22.5	106	
	⊕ PH 2		22	60	22.5	201	
	⊕ PH 3		22	60	22.5	202	
	⊕ PH 4		22	60	22.5	203	
		⊕ PZ 2	22	60	22.5	301	
		⊕ PZ 3	22	60	22.5	302	
		⊕ PZ 4	22	60	22.5	303	

51414

Hexagon screwdriver set

1/2"



Quality
Chromium-vanadium steel.

Design

All tools are packed tightly so they cannot move around.

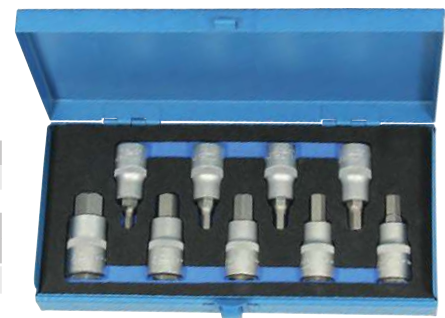

51414

Set contents		Design	51414	...
9	inserts for hexagon socket screws	Sizes 5/6/7/8/9/10/12/14/17 mm		
9 pieces		in a sheet steel box with foam insert	101	

51415 - 51416

Hexagon screwdriver sets

1/2"



Quality

Vanadium special steel.



51415

Art. no.	Kit contents	mm	inch	...
51415 101	9 Sizes 5/6/7/8/9/10/12/14/17 mm	51415	51416	
51416 101	9 Sizes 3/16/7/32/1/4/9/32/5/16/3/8/1/2/9/16/5/8 inch			
9 pieces	in a sheet steel box	101	101	

Screwdriver bits

51419

Hexagon screwdriver set

1/2"



ATORN®

Quality
Chromium-vanadium steel.

51419

Design

All tools are packed tightly so they cannot move around.



Set contents			
9	inserts for hexagon socket screws	Sizes 5/6/7/8/9/10/12/14/17 mm	
1	lever reversible ratchet, with 2-component handle	255 mm	
1	extension	250 mm	
Set contents	Design	51419	...
11 pieces	in a sheet steel box with foam insert		101

51420

Hexagon screwdriver set

1/2"



HAZET®

Quality
Chromium-vanadium steel.

51420



Set contents			
8	inserts	Sizes 5/6/8/10/12/14/17/19 mm	
1	reversible ratchet		
1	handle with sliding piece		
2	extensions	123/248 mm	
Set contents	Design	51420	...
12 pieces	in metal case		101

51424 - 51428

Hexagon screwdriver bits

1/2"



Design

Chrome-plated, die-forged.

Quality

Chromium-vanadium steel.

51424

ATORN®

51426
GEDORE®
Werkzeuge fürs Leben

51427
STAHLWILLE®

Quality
Chrome alloy steel.

51428
HAZET®
CVD-TiN-coated blade.

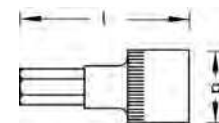

Sizes mm	ATORN®		GEDORE®		STAHLWILLE®		HAZET®		ATORN®		GEDORE®		STAHLWILLE®		HAZET®	
	l	d	l	d	l	d	l	d	l	d	l	d	l	d	l	d
mm	mm	mm	mm	mm	mm	mm	mm	mm	mm	mm	mm	mm	mm	mm	mm	mm
4	57	-	60	60	60	22.5										
5	57	60	60	60	60	22.5										
L 5	-	180	120	180	22.5											
6	57	60	60	60	60	22.5										
L 6	-	140	120	137	22.5											
7	57	60	60	60	60	22.5										
L 7	-	-	120	100	22.5											
8	57	60	60	60	60	22.5										
L 8	-	120	120	119	22.5											
10	57	60	60	60	60	23.0										
L 10	-	140	140	141	23.0											
12	57	60	60	60	60	23.5										
L 12	-	-	140	-	23.5											
14	57	60	60	60	60	25.0										
L 14	-	-	140	-	23.5											
17	57	60	60	60	60	28.0										
19	57	60	60	60	60	30.0										

51433

Zyklus hexagon screwdriver bits



51433 300

Design

- With ball catch groove
- Knurling at the rear end for strong grip during manual operation
- **With holding function** to facilitate screwing by reducing the risk of dropping and losing the screw when positioning it into the workpiece
- With **Take it Easy** tool finder colour coding by size – to help you identify the tool you need quickly and easily
- In a robust, foldable fabric bag for safe storage

Applications

For hexagon socket screws. For manual and machine operation (non impact).

Quality

Brushed chromium-plated vanadium.

51433 301

Design

- Robust textile belt in the typical Wera design with 6 hex screwdriver bits in a compact space
- **With holding function** to facilitate screwing by reducing the risk of dropping and losing the screw when positioning it into the workpiece
- With **Take it easy** tool finder colour coding by size
- Especially short, stable bit nuts with the benefits of Wera bit technology
- Snap hook for attaching to belt loops or pockets
- Smooth rotation mechanism ensures the secure fit and easy removal of nuts
- With fleece backing and adhesive strip for easy attachment to a wall, shelf, workshop trolley and the Wera 2go tool transport system, for example

Applications

For hexagon socket screws. For manual and machine operation (non impact).

Quality

Brushed chromium-plated vanadium.



51433 300



51433 301

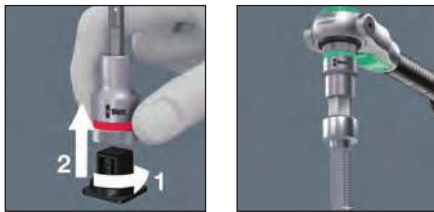

Secure hold and easy removal

The new smooth rotary mechanism ensures both secure and rattle-free storage as well as easy removal of the tool.



Contents	Set contents Sizes mm	l mm	Design	Set 51433 ...
9 pieces	4/5/6/7/8/10/12/14/17	60	in fabric bag	300
6 pieces	4/5/6/7/8/10	60	in a robust textile belt	301 NEW

Short		
Sizes mm	l mm	d mm
4	60	23.5
5	60	23.5
6	60	23.5
7	60	23.5
8	60	23.5
10	60	23.5
12	60	23.5
14	60	23.5
17	60	23.5
19	60	23.5

Long		
Sizes mm	l mm	d mm
4	140	23.5
5	140	23.5
6	140	23.5
7	140	23.5
8	140	23.5
10	140	23.5

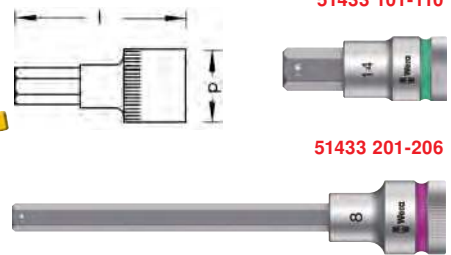

51433 101-110

51433 201-206

51431 - 51432

Long hex ball-head screwdriver bits



51431



Design

With ball retaining groove and handy circumferential knurls. Sleeve chrome plated, bronzed blade.

Applications

Total swivel angle of approx. 15–20°.

Quality

Tip made from vanadium special steel.

51432



Design

Chrome-plated sleeve, CVD-TIN coated blade.

Applications

For bolted connections in a confined space, swivel angle of 25°.

Quality

Chromium-vanadium steel, special steel blade.

Sizes mm	l mm	GEDORE		HAZET	
		51431	...	51432	...
5	140				101
6	140		101		102
7	140		102		103
8	140		103		104
10	140		104		105
12	140		105		106



51431



51432

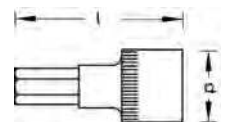

Hand tools

TX® screwdriver bits

51444 - 51447

TX® screwdriver bits



Design

Chrome-plated, die-forged, bronzed blade.

Applications

For internal TX® screws.

Quality

Chromium-vanadium steel.

Note:

TX® profile gauge, see art. no. 37930.

51444



51444

51445

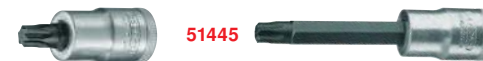

51445

51446



51446

Quality

Chrome alloy steel.

51447



51447

CVD-TiN-coated blade.

Size T	l approx. mm	d approx. mm	ATORN®		GEDORE®		STAHLWILLE®		HAZET®	
			51444	...	51445	...	51446	...	51447	...
20	55	23		101		101		101		101
L 20	100	23		102		102				
25	55	23		103		103		103		103
L 25	100	23		104		104				
27	55	23		105		105		105		105
L 27	100	23		106		106				
30	55	23		107		107		107		107
L 30	100	23		108		108				
40	55	23		109		109		109		109
L 40	100	23		110		110				
45	55	23		111		111		111		111
L 45	100	23		112		112				
50	55	23		113		113		113		113
L 50	100	23		114		114				
55	55	24.6		115		115		115		115
L 55	100	23		116		116				
60	55	24.6		117		117		117		117
L 60	100	23		118		118				
70	60	25.7						119		

51449

Zyklop-TX® screwdriver bits



Design

- With ball-securing groove
- Knurling at the rear end for strong grip during manual operation
- **With holding function** to facilitate screwing by reducing the risk of dropping and losing the screw when positioning it into the workpiece
- With **Take it easy** tool finder colour coding by size – to help you identify the tool you need quickly and easily.

Applications

For internal TX® screws.
For manual and machine operation (non impact).

Quality

Brushed chromium-plated vanadium.

Note:

TX® profile gauge, see art. no. 37930.

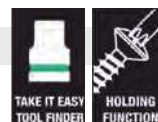

51449 100-109



Short

Size T	l mm	d mm	51449	
		
20	60	23.5	100	
25	60	23.5	102	
27	60	23.5	103	
30	60	23.5	104	
40	60	23.5	105	
45	60	23.5	106	
50	60	23.5	107	
55	60	23.5	108	
60	60	23.5	109	

51449 201-209



Long

Size T	l mm	d mm	51449	
		
20	140	23.5	201	
25	140	23.5	202	
27	140	23.5	203	
30	140	23.5	204	
40	140	23.5	205	
45	140	23.5	206	
50	140	23.5	207	
55	140	23.5	208	
60	140	23.5	209	

51451

ResisTORX® screwdriver bits

1/2"



Design

Chrome-plated sleeve, CVD-TiN coated blade.

Applications

For internal TX® screws with pin.

Quality

Chromium-vanadium steel, special steel blade.

Note:

TX® profile gauge, see art. no. 37930.



51451

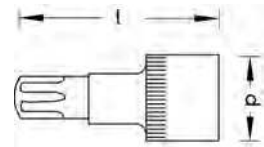

Size	l	d	51451	...
T	mm	mm		
30	55	23		101
40	55	23		102
45	55	23		103
50	55	23		104
55	56	23		105

51455

TX® set

1/2"



GEDORE

WERKZEUGE FÜR'S LEBEN

Applications

For internal and external TX® screws.

Quality

Vanadium 31CrV3.

Note:

TX® profile gauge, see art. no. 37930.



51455

Set contents		51455	...
9	inserts for internal TX® screws T20/25/27/30/40/45/50/55/60		
8	inserts for external TX® screws E10/11/12/14/16/18/20/24		
Set contents	Design	51455	...
17 pieces	in a sheet steel box		301

51436 - 51437

TX® screwdriver sets

1/2"



GEDORE

WERKZEUGE FÜR'S LEBEN

Applications

For internal TX® screws.

Quality

Vanadium special steel.

Note:

TX® profile gauge, see art. no. 37930.



51436

51437

Art. no.	Kit contents	51436	...	51437	...
51436 101	9 short format (55 mm): T 20/25/27/30/40/45/50/55/60				
51437 101	18 1 of each x short (55 mm) and long (100 mm) format: T 20/25/27/30/40/45/50/55/60				
Set contents	Design	51436	...	51437	...
9 pieces	in a sheet steel box		101		
18 pieces	in a sheet steel box				101

51441

TX® screwdriver set

1/4"

3/8"

1/2"



Design

In SmartCase 185 x 153 x 52 mm. In safety insert system, 2-component soft foam insert.

Applications

For internal TX® screws.

Quality

Chromium-vanadium steel.

CVD-TiN-coated blades.

Note:

TX® profile gauge, see art. no. 37930.



51441

Set contents		51441	...
3	inserts 1/4-inch T 8/T 10/T 15		
3	inserts 3/8-inch T 20/T 25/T 30		
4	inserts 1/2-inch T 40/T 50/T 55/T 60		
Set contents	Design	51441	...
10 pieces	in SmartCase with soft foam insert		101

51456

Zyklop-TX® screwdriver bits

1/2"



51456 100

Design

- 9 pieces, in surface-protecting, compact and highly robust fabric box
- Adhesive area for convenient mounting on walls, shelves, workshop trolley etc.
- Incl. hook and loop strips with adhesive backing
- Low volume and weight for ease of mobility
- **With holding function** to facilitate screwing by reducing the risk of dropping and losing the screw when positioning it into the workpiece
- With **Take it easy** tool finder colour coding by size – to help you identify the tool you need quickly and easily.
- In a robust, foldable fabric bag for safe storage

Applications

For internal TX® screws.

Quality

Brushed chromium-plated vanadium.

51456 101

Design

- 6 pieces, robust textile belt in the typical Wera design with 6 Zyklop TX® screwdriver bits in a compact space
- **With holding function** to facilitate screwing by reducing the risk of dropping and losing the screw when positioning it into the workpiece
- With **Take it easy** tool finder colour coding by size
- Especially short, stable bit nuts with the benefits of Wera bit technology
- Snap hook for attaching to belt loops or pockets
- Smooth rotation mechanism ensures the secure fit and easy removal of nuts
- With fleece backing and adhesive strip for easy attachment to a wall, shelf, workshop trolley and the Wera 2go tool transport system, for example

Applications

For internal TX® screws.

Quality

Brushed chromium-plated vanadium.



51456 100



51456 101

Note:

TX® profile gauge, see art. no. 37930.

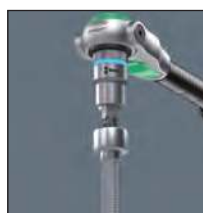

Safe and easy removal

The new smooth rotary mechanism ensures both secure and rattle-free storage as well as easy removal of the tool.

Set contents	Size	Design	51456	...
9 pieces	T 20/25/27/30/40/45/50/55/60	in fabric bag	100	
6 pieces	T 25/30/40/45/50/55	in a robust textile belt	101	NEW

51450

TX® set

1/2"



Design

All tools are packed tightly so they cannot move around.

Quality

Chromium-vanadium steel.

Note:

TX® profile gauge, see art. no. 37930.

Set contents				
9	✳	inserts for internal TX® screws T 20/25/27/30/40/45/50/55/60		
9	✳	inserts for external TX® screws E 10/11/12/14/16/18/20/22/24		
1		lever reversible ratchet, with 2-component handle 255 mm		
2		extensions 125/250 mm		

Set contents	Design	51450	...
21 pieces	in a sheet steel box with foam insert	101	



51450

51457

TX® socket wrench set



Design

Chrome-plated.

Quality

Chrome alloy steel.

Note:

TX® profile gauge, see art. no. 37930.

51457



Set contents

- 1/4" 2 inserts for internal TX® screws T8/9
- 3 inserts for external TX® screws E4/5/6
- 7 TX® bits with bore T10/15/20/25/27/30/40
- 3/8" 5 inserts for internal TX® screws T10/15/20/25/27
- 4 inserts for external TX® screws E7/8/10/12
- 1 bit holder with hexagon socket 1/4 inch
- 1/2" 6 inserts for internal TX® screws T30/40/45/50/55/60
- 6 inserts for external TX® screws E11/14/16/18/20/24
- 1 TX® guide for internal TX® screws T10–60 and external TX® screws E6–16

Set contents	Design	51457	...
35 pieces	in a robust, stackable ABS plastic box		301

51458

TX® screw tool set

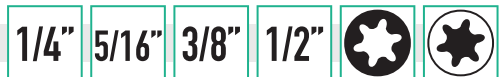

Design

In SmartCase 355 x 235 x 65 mm. In safety insert system, 2-component soft foam insert.

Quality

Chromium-vanadium steel.

Note:

TX® profile gauge, see art. no. 37930.

51458



Set contents

- 4 box wrenches for external TX® screws E6 x 8/10 x 12/14 x 18/20 x 24
- 1 connecting piece 5/16 inch x 3/8 inch
- 1 connecting piece 5/16 inch x 1/2 inch
- 1 connecting piece 1/4 inch x 1/4 inch
- 1/4" 4 socket wrench inserts for external TX® screws E5/6/7/8
- 7 bits for internal TX® screws
 - T 10/20/25/27/30 (length 26 mm)
 - T 25 (length 65 mm)
 - T 30 with hole (length 26 mm)
- 3/8" 3 bits for internal TX® screws T40/45/50
- 3/8" 3 socket wrench inserts for external TX® screws E10/12/14
- 1/2" 3 socket wrench inserts for external TX® screws E10/12/14
- 2 screwdriver bits for internal TX® screws T55/60

Set contents	Design	51458	...
29 pieces	in SmartCase with soft foam insert		101

51459

TX® screw tool set



Design

In SmartCase 355 x 235 x 65 mm. In safety insert system, 2-component soft foam insert.

Quality

Chromium-vanadium steel.

Note:

TX® profile gauge, see art. no. 37930.

51459



Set contents

- 4 box wrenches for external TX® screws E 6 x 8/10 x 12/14 x 18/20 x 24
- 10 screwdrivers for internal TX® screws T 6/7/8/9/10/15/20/25/27/30
- 11 Allen keys for internal TX® screws
 - T 6/7/8/9/10/15/20/25/27/30/40
- 1/4" 5 socket wrench inserts for external TX® screws E 4/5/6/7/8
- 12 ResisTORX® bits with hole 26 mm (T 6 without hole)
 - T 6/7/8/9/10/15/20/25/27/30/40
- 1 connecting piece 1/4 inch on 1/4 inch
- 1 connecting piece 1/4 inch on 3/8 inch
- 1 bit reversible ratchet 115 mm (20 teeth)
- 3/8" 4 socket wrench inserts for external TX® screws E 10/11/12/14
- 2 screwdriver bits for internal TX® screws T 40/45
- 1/2" 4 socket wrench inserts for external TX® screws E 16/18/20/24
- 3 screwdriver bits for internal TX® screws T 50/55/60

Set contents	Design	51459	...
58 pieces	in SmartCase with soft foam insert		101

51463

TX® socket wrench set

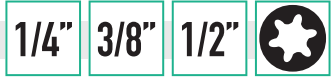

Quality
Chromium-vanadium steel.

Design

In SmartCase 185 x 153 x 52 mm. In safety insert system, 2-component soft foam insert.

Applications

For external TX® screws.

Note:

TX® profile gauge, see art. no. 37930.



Set contents			
✳	3	1/4 inch inserts, E 4/E 5/E 6	
✳	3	3/8 inch inserts, E 8/E 10/E 12	
✳	3	1/2 inch inserts, E 14/E 18/E 20	
Set contents	Design	51463	...
9 pieces	in SmartCase with soft foam insert		301

51465 - 51473

TX® socket wrench inserts



Applications

For external TX® screws.

51465



Note:

TX® profile gauge, see art. no. 37930.

51473



Design

Chrome-plated, polished.

Quality

Chromium-vanadium steel.



51465

51473

Size E	Length mm	ATORN®		HAZET®	
		51465	...	51473	...
10	38.0		101		301
11	38.0		102		302
12	38.0		103		303
14	38.0		104		304
16	38.0		105		305

Size E	Length mm	ATORN®		HAZET®	
		51465	...	51473	...
18	38.0		106		306
20	38.0		107		307
22	38.0		108		
24	38.0		109		
24	41.2				308

51476

XZN screwdriver set



Applications

For triple square socket screws (XZN).

Design

- Non-slip, knurled
- In SmartCase
- In safety insert system, 2-component soft foam insert

Quality

CVD-TiN coating for longer service life.



Set contents			
●	6	XZN short inserts M 8/10/12/14/16/18	
●	2	XZN long inserts M 8/14	
●	2	XZN extra long inserts M 10/12	
Set contents	Design	51476	...
10 pieces	in SmartCase with soft foam insert		101

51480

XZN screwdriver bits



WERKZEUGE FÜR'S LEBEN

Design

Chrome-plated, bronzed blade.

Applications

Multipoint socket screws (Allen XZN).

Quality

Chromium-vanadium steel.

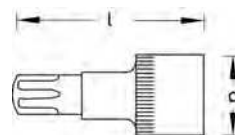

51480

51480 L



Size XZN	l mm	d mm	51480	
		
5	55	23		301
6	55	23		302
L 6	100	23		303
8	55	23		304
L 8	100	23		305

Size XZN	l mm	d mm	51480	
		
10	55	23		306
L 10	100	23		307
12	55	23		308
L 12	100	23		309



51484

RIBE CV screwdriver bits

1/2"



Design

Chrome plated, die-forged
CVD-TiN coated blade.

Applications

For internal wedge profile screws (RIBE CV).

Quality

Chromium-vanadium steel.

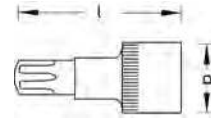

Size RIBE CV	l mm	d mm	51484	...
6	63	23		102
8	63	23		103
10	63	23		104

Size RIBE CV	l mm	d mm	51484	...
12	63	23		105
14	63	24,6		106

51542

Plug-on ratchet

1/2"



Design

Very solid construction, can be switched between
clockwise and anticlockwise rotation.

Applications

Intended as ratchet attachment for the drive
elements art. no. 51535–51541, but also
as a ratchet for torque wrenches with 1/2 inch
connecting square.

Quality

Chrome alloy steel, flake-proof with nickel
plating.

Total length mm	Ø mm	Number of teeth	51542	...
67.5	40	20		101



51503

Reversible toothed ratchet DIN 3122/ISO 3315

1/2"



WERKZEUGE FÜR'S LEBEN

Design

Fine-running and robust with double-pawl, with
push-through square.

Quality

31 Cr V3.

	Total length mm	51503	...
Ratchet	270		101
Push-through square	38		102



51503 102

51503 102
Push-through square



51506 - 51510

Reversible ratchets DIN 3122/ISO 3315

1/2"

Design

Chrome-plated, extremely robust ratchets with
rotary knob for clockwise/anti-clockwise
rotation and ergonomic plastic handle.

Quality

Chromium-vanadium steel.

51506



Finely toothed (72 teeth, 5° rotating angle),
with ball lock.

Quality

31 Cr V3.

51507



Finely toothed (60 teeth, 6° rotating angle).

Quality

Chrome alloy steel.

51508



Finely toothed (72 teeth, 5° angle of rotation),
allows even extremely obscured screwed connecti-
ons to be manipulated. Large, reversal knob on the
top makes it easier to reverse the ratchet. Deep-sea-
ted reversal knob protects against unintentional
reversal. Coated fine-cast cover plate and reversal
knob for tough operating conditions. Inductively
hardened internal toothing ensures high stress
resistance and long service life. Robust housing with
forged, ergonomic handle. Anti-slip 2-component
grip for optimal handling.

51510



Extra long ratchet 400 mm.

Finely toothed (72 teeth, 5° rotating angle).

The contact surface makes it possible to press on
the ratchet head, without having to use the switch.
Fast switching with one-handed operation.



51506



51507



51508



51510



	GEDORE	...	STAHLWILLE	...	HAZET	...	FACOM	...
Total length mm	51506		51507		51508		51510	
245							101	
265					201			
270		101						
XL 400								102

Reversible ratchets

51515 - 51520

Reversible ratchets DIN 3122/ISO 3315

1/2"

Design

- Chromium-plated
- Extremely robust ratchet with switchable clockwise/anti-clockwise rotation
- Ergonomic plastic handle

Quality

Chromium-vanadium steel.

51515 201



- With lever reverse
- With quick release pushbutton
- Finely toothed
- 72 teeth
- Anti-slip 2-component handle with hanging hole

51517 101



- Particularly suitable for robust use in industry and for commercial vehicles
- Design in accordance with DIN 3122, ISO 3315
- With lowered reversing lever
- With pushbutton release
- 7.5° return angle
- Anti-slip 2-component handle with hanging hole
- Ratchet lock in centre position. When switching, the lever automatically locks in for clockwise or anticlockwise turning
- For hand-operated socket wrench inserts and connectors with square drive in accordance with DIN 3120 C- 12.5, ISO 1174, with ball lock

Quality

GEDORE vanadium steel 31CrV3, chrome-plated.

51518 101



- With lever reverse
- 36 teeth

Quality

Chrome alloy steel.

51518 102



- With lever reverse
- With QuickRelease safety lock
- With 2-component handle
- 80 teeth
- 6° working angle ideal for working in confined spaces

Quality

Chrome alloy steel.

51519 200



- The lever snap-in function guards against accidental switching
- Use of the latest lubricants increases the service life
- Strict manufacturing tolerances guarantee protection against invasive contamination
- HAZET internal quality standards guarantee durability far beyond standard VPA tested, static torque in accordance with DIN 3122: 1000 Nm

- Chrome-plated surface is easy to clean, corrosion-resistant
- Integrated hanging option in the handle
- HAZET 2-component handle

Applications

- Angle of 4°/90 teeth allows use in the tightest spaces, for example, on engines, in mechanical engineering, agricultural vehicles and equipment, renewable energy (solar, wind turbines)

Quality

Chromium-vanadium steel.

51519 201



- With lever reverse
- Polished
- 32 teeth

51519 202



- With lever reverse
- Polished
- 32 teeth
- With safety connection
- With quick release pushbutton

51519 204



- With lever reverse
- 32 teeth
- 12° angle of rotation
- Shank Ø 15 mm
- Minimal effort required thanks to longer lever
- Slip-proof 2-component handle

Applications

Particularly suitable for commercial vehicles and agricultural machines and industrial plants.

Quality

Hardened and tempered special steel.

51520 201



- With lever reverse
- Nickel-plated and chrome-plated
- Rounded and highly-polished surfaces without any sharp edges
- 80 teeth
- 4.5° return angle
- 2 claws that retain 7 teeth in contact with the gear at all times for maximum strength
- Exceeds the torque requirements pursuant to ISO and ASME
- With warm, comfortable 2-component handle, slip-resistant and with larger grip width.

Quality

Vanadium extra, precision forged and heat treated.



	ATORN	GEDORE	STAHLWILLE	HAZET	BAHCO					
Total length mm	51515	...	51517	...	51518	...	51519	...	51520	...
255	201									
265.5						101				
265.5						102				
270			101							201
275							200	NEW		
275							201			
275							202			
389							204			

Hand tools

51512

Reversible ratchet DIN 3122/ISO 3315

1/2"

GEDORE
WERKZEUGE FÜR'S LEBEN

Design

With lever reverse.

Finely toothed, 6° angle of rotation, slip-resistant
2-component handle with hanging hole.
Ball locking mechanism, with pushbutton release.

Quality

Vanadium steel 31CrV3

51512



Total length	51512	...
mm		
270		101

51522

One-handed reversible ratchet DIN 3120/ISO 1174

1/2"

BAHCO

Design

Nickel and chrome plated, mirror polished. Smooth
one-handed switching ring on the ratchet handle
changes the direction of rotation with a short turn
(clockwise/anti-clockwise). Integrated quick-action
rotary disc on the square makes it easier to loosen

and tighten screw connections. Unlocking device of
the ball catch ensures easier and faster changing of
socket wrench inserts at the push of a button
without effort. **Small tooth pitch (60 teeth)**, 6°
return angle. Plastic handle with hanging hole.

Quality

Vanadium extra.

51522



Total length	51522	...
mm		
260		301



51523

Removable reversible ratchet

1/2"

ATORN[®]

Design

- Ratcheting/clamping function
- Finely toothed, 72 teeth
- 5° return angle for confined spaces
- Anti-clockwise/clockwise direction switching using
lever with pushbutton release

Applications

Lever reversible ratchet for manually operated
socket wrench inserts and connectors.

Quality

**Chromium-vanadium steel, matt chromium-
plated.**

NEW

51523



Adjustment range	51523	...
mm		
305 - 445		301
457-600		302

51524

Removable reversible ratchet

1/2"

HAZET[®]

Design

- Infinitely extendable from 410 to 590 mm
- Minimal effort required thanks to longer lever
- Maximum torque of 600 Nm
- Easy fixing with non-slip locking ring
- Ratchet wheel with 32 teeth
- Surface: chrome-plated, polished heads.

Applications

Particularly suitable in commercial
vehicles and agricultural
machinery areas as well
as in industrial plants.

Quality

Chromium vanadium.

51524

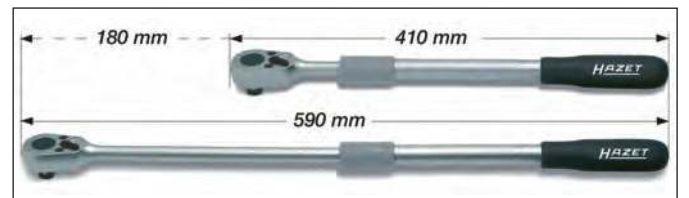

Adjustment range	51524	...
mm		
410 - 590		101

51527

Jointed reversible ratchet

1/2"

HAZET[®]

Design

With lever reverse.

Chrome-plated and polished.

Extremely robust ratchet with switchable
clockwise and anti-clockwise rotation, movable
ratchet head and ergonomic plastic handle.

Quality

Chromium-vanadium steel.

51527



Total length	51527	...
mm		
270		201

51534

Zyklop metal ratchet

1/2"



Design

- Forged **solid metal ratchet** (chromium-molybdenum) for extremely high robustness over a long service life
- With ball lock
- Slim design for work even in very tight spaces
- Fine toothing with 72 teeth for a return angle of just 5°
- Reversing lever for easy switching of direction
- With secure nut locking function



Extremely slim.
Long lever.



The finely toothed reversible ratchet with 72 teeth has a small return angle of just 5°. The small stroke enables fast and precise working in all installation positions.



The ball locking mechanism ensures the nuts and accessories fit securely, thus ensuring reliable safety during screwing.



Thanks to the reversing lever, it is possible to change direction quickly and easily.

51534 100



Total length	51534	...
mm		
281		100

51534

Zyklop Speed ratchet



1/2"



Design

- Flywheel mass design and handy rapid-turning sleeve for high working speed
- Freely tilting ratchet head
- Defined position at 0°, 90° to the left and right as well as 15° from 90° inwards
- Can be used in 0° position like a conventional screwdriver
- Pushbutton release
- Anti-clockwise/clockwise switch
- Finely toothed
- Small return angle of 5°
- Multi-component power grip for effortless work



The ratchet head can be swivelled freely and can be unlocked in any position using the slide switch on both sides.



The nut locking accelerates the insertion or removal of the inserts and extensions. The ball locking mechanism ensures the nuts and accessories fit securely, thus ensuring reliable safety during screwing. A short press on the release button and the tool can be moved to all defined positions.



The flywheel mass construction speeds up the screwing process.



The Zyklop ratchet can be switched quickly and easily to left/right motion in any position using the knurling wheel.

51534 101



Total length	51534	...
mm		
277		101

51534

Zyklop hybrid ratchet set (with extension)

1/2"



Design

- With ball lock
- Fine toothing with 72 teeth for a return angle of just 5°
- Reversing lever for easy switching of direction
- With secure nut locking function
- Multi-component Kraftform handle for optimum pressure and tensile load
- Mount for Zyklop hybrid extension on handle end
- Total length of extension 271 mm



The finely toothed reversible ratchet with 72 teeth has a small return hollow angle of just 5°. The small stroke enables fast and precise working in all installation positions.



The ball locking mechanism ensures the nuts and accessories fit securely, thus ensuring reliable safety during screwing. A short press on the release button and the tool can be moved to all defined positions.

51534 102



Total length	51534	...
mm		
281		102

51535 - 51541

Drive elements

1/2"

Design
Chrome-plated, die-forged.
Quality
Chromium-vanadium steel.



51537
DBGM
GEDORE

Design
Ground. Simple locking and unlocking by turning the handle.
Applications
Protection against unintentional loosening.

51538
GEDORE

51538 202
GEDORE
Crank
Design
With rotatable, ergonomic handle.

51539
STAHLWILLE
Quality
Chrome alloy steel.

51540
STAHLWILLE
Design
With quick release safety lock.
Quality
Chrome alloy steel.

51541
HAZET



	51535	...	51537	...	51538	...	51539	...	51540	...	51541	...
Handle with sliding piece	201		101		201		101		101		201	
Crank					202							
Cardan joint	203				203		103		103		203	
1/2 inch adapter <input type="checkbox"/> 3/8 inch <input type="checkbox"/>	204				204		104				204	
1/2 inch adapter <input type="checkbox"/> 3/4 inch <input type="checkbox"/>	205				205		105				205	
FixGRIP adapter 1/2 inch <input type="checkbox"/> 3/4 inch <input type="checkbox"/>							106					

51550 - 51560

Extensions

1/2"

Design
Chrome-plated, die-forged.
Quality
Chromium-vanadium steel.



51551
GEDORE

With release button. Safety ring to prevent unintentional loosening of the socket wrench insert.

51552
GEDORE

51553
STAHLWILLE

Quality
Chrome alloy steel.

51554
HAZET

51556
FACOM

51560
STAHLWILLE
With quick release safety lock.
Quality
Chrome alloy steel.



Length approx. mm	51550	...	51551	...	51552	...	51553	...	51554	...	51556	...	51560	...
52							300							101
75	101					201	301		201					
125	102		101		202		302		202		202			
130														102
250	103		102		203		303		203		203			
255														103
500											204			

Hand tools

51562

Swivel extensions

1/2"



Quality
Chromium-vanadium steel.



Design
Chrome-plated, polished.
Applications
With ball-shaped, conical square drive. Allows a swivel angle of 12.5° to each side.

51562 201



51562 202



51562 203



Length mm	51562	...
46		201
123		202
248		203

51565

Adapter set

1/4" 3/8" 1/2" 3/4"



Quality
Chromium-vanadium steel.

Design
In SmartCase 185 x 153 x 52 mm, safety insert system, 2-component soft foam insert.

Set contents

1/4 inch	<input type="checkbox"/>	x 3/8 inch	<input checked="" type="checkbox"/>
3/8 inch	<input type="checkbox"/>	x 1/4 inch	<input checked="" type="checkbox"/>
3/8 inch	<input type="checkbox"/>	x 1/2 inch	<input checked="" type="checkbox"/>
1/2 inch	<input type="checkbox"/>	x 3/8 inch	<input checked="" type="checkbox"/>
1/2 inch	<input type="checkbox"/>	x 3/4 inch	<input checked="" type="checkbox"/>
3/4 inch	<input type="checkbox"/>	x 1/2 inch	<input checked="" type="checkbox"/>



51565

Set contents	Design	51565	...
6 pieces	in SmartCase with soft foam insert		201

51568

Open bi-hex box wrench (crowfoot wrench)

1/2"



Quality
Chromium-vanadium steel.

Design
Chrome-plated, with square drive.
Applications
Specially designed for working in hard-to-reach places.



51568

Size mm	51568	...	Size mm	51568	...
30		101	41		104
32		102	46		105
36		103			

51569

Hexagon socket wrench set

3/4"

ATORN®
Quality
Chromium-vanadium steel.
Design

Inserts with energy profile, hole and knurling.

Set contents

- | | | |
|------|---------------------------------|--|
| ○ 12 | hex inserts with energy profile | Sizes 22/24/27/30/32/36/38/41/46/50/55/60 mm |
| 1 | reversible ratchet | 2000 Nm torque |
| 1 | handle with sliding piece | 500 mm |
| 2 | extensions | 200/400 mm |

Set contents	Design	51569	...
16 pieces	in a sheet steel box		101



51569

51570

Hexagon socket wrench set

3/4"

GEDORE®
WERKZEUGE FÜR'S LEBEN

Quality
Vanadium 31CrV3.
Design

Chrome-plated, hot forged, with pin locking device.

Set contents

- | | | |
|------|-----------------------------|--|
| ○ 10 | hex inserts with UD-profile | Sizes 22/24/27/30/32/36/38/41/46/50 mm |
| 1 | reversible ratchet | |
| 1 | handle with sliding piece | |
| 2 | extensions | 200/400 mm |

Set contents	Design	51570	...
14 pieces	in a sheet steel box		201



51570

51571

Hexagon socket wrench set

3/4"

STAHLWILLE®
Quality
HPQ steel.
Design

Chrome-plated.

With AS drive profile and quick-release system (single-handed safety lock).

Set contents

- | | | |
|-----|-----------------------------------|-------------------------------------|
| ○ 9 | hex inserts with AS drive profile | Sizes 32/34/36/38/41/46/50/55/60 mm |
| 1 | reversible ratchet | |
| 1 | handle | |
| 1 | sliding piece | |
| 1 | angle joint | |
| 2 | extensions | 200/400 mm |

Set contents	Design	51571	...
15 pieces	in a sheet steel box		202



51571

Hand tools

51573 - 51575 Hexagon socket wrench inserts DIN 3124/ISO 2725



Design
Chrome-plated, die-forged.



51573
With UD profile, circumferential knurls and pin lock.
Quality
31 Cr V3.

51575
 With AS drive profile.
Quality
HPQ steel.

51574
 Quality
Chromium-vanadium steel.



Size mm	l approx. mm	d ₁ approx. mm	51573	...	51575	...	51574	...
19	50	28.0					302	
21	51	28.0					303	303
22	51	33.0	304		304		304	304
24	51	35.0	305		305		305	305
27	55	39.0	306		306		306	306
30	59	42.5	308		308		308	308
32	59	45.0	309		309		309	309
34	59	48.0	311		311		311	311

Size mm	l approx. mm	d ₁ approx. mm	51573	...	51575	...	51574	...
36	62	50.0	313				313	313
38	62	52.5	314					314
41	68	56.5	315				315	315
46	73	63.0	317				317	317
50	75	68.0	318				318	318
55	82	74.0	319				319	319
60	88	80.5	320					320

51577 Bi-hexagon socket wrench inserts DIN 3124/ISO 2725



Design
With UD profile. Chrome-plated, die-forged.
Quality
Chromium-vanadium steel.

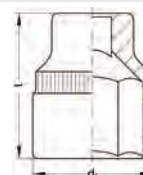

Size mm	l mm	d ₁ mm	51577	...
21	51.5	32.0		203
22	51.5	33.3		204
24	51.5	35.8		206
27	54.5	39.6		209
30	57.5	43.3		212

Size mm	l mm	d ₁ mm	51577	...
32	57.5	45.8		213
36	59.5	50.8		217
41	62.5	57.1		219
46	65.5	63.3		221
50	68.5	68.3		222

51581 - 51582 Hexagon screwdriver bits



Applications
For hexagon socket screws, for high load, tight tolerances.



51581
Design
Chrome-plated, bronzed tips, with knurled grip.
Quality
Vanadium special steel.

51582
 Design
Chrome-plated.
Quality
Chrome alloy steel.

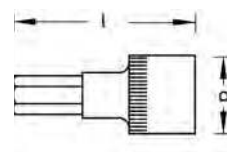

Size mm	l mm	d approx. mm	51581	...	51582	...
14	80	36	201		101	
17	80	36	202		102	

Size mm	l mm	d approx. mm	51581	...	51582	...
19	80	36	203		103	
22	80	39	204		104	

51583 TX® screwdriver bits



Applications
For internal TX® screws.

Quality
CVD-TiN coating for longer service life.

Note:
TX® profile gauge, see art. no. 37930.



Size T	Length mm	51583	...
60	80		101
70	80		102
80	80		103

Size T	Length mm	51583	...
90	80		104
100	80		105

51584

Reversible toothed ratchet DIN 3122/ISO 3315

3/4"

GEDORE
WERKZEUGE FÜR'S LEBEN

Design

Chrome-plated, with pin protection and internal gearing (10° angle of rotation). With push-through square.

Quality

Vanadium 31CrV3.

51584 201



	Total length mm	51584	...
Ratchet	510.0	201	
Push-through square	51.5	202	

51584 202
Push-through square

51584 202



51586

Reversible ratchet DIN 3122/ISO 3315

3/4"

GEDORE
WERKZEUGE FÜR'S LEBEN

Design

Chrome-plated, extremely robust ratchet with rotary head for clockwise/anti-clockwise rotation, pin retention and inner splines (7.2° angle of rotation).

Quality

Vanadium 31CrV3.

51586

	Total length mm	51586	...
	510	201	



51588 - 51589

Reversible ratchets DIN 3122/ISO 3315

3/4"

Design

Chrome-plated, extremely robust ratchet with switchable clockwise/anti-clockwise rotation and pin locking device.

Quality

Chromium-vanadium steel.

51588

GEDORE
WERKZEUGE FÜR'S LEBEN

Design

With a rotary head.

Finely toothed (5° angle of rotation).

51588



51589

HAZET

Design

With lever reverse. Ratchet (32 teeth) with pin locking device. Shaft with release pin for pin locking device.

51589



	Total length mm	51588	...	51589	...
	620	201		101	

51587

Removable reversible ratchet

3/4"

Design

- With lever reverse

- Extra-wide corded handle

- Length can be adjusted to 6 positions (610/690/770/850/930/1010 mm).



51587

	Adjustment range mm	Max. load capacity Nm	51587	...
	615 - 1015	1800	101	

51592 - 51595

Drive elements

3/4"

Design

Chrome-plated, die-forged.

Quality

Chromium-vanadium steel.

51592

GEDORE
WERKZEUGE FÜR'S LEBEN

51595

STAHLWILLE

Quality

Chrome alloy steel.

51592 102

51593

HAZET

		51592	...	51593	...	51595	...
Handle with sliding piece				101			
Cardan joint		102					
3/4 inch adapter <input type="checkbox"/> x 1/2 inch <input type="checkbox"/>		103		103		203	
3/4 inch adapter <input type="checkbox"/> x 1 inch <input type="checkbox"/>		104				204	



51593 101

51595 203



51596 - 51598

Extensions

3/4"

Design

Chrome-plated, die-forged.

Quality

Chromium-vanadium steel.

51596

GEDORE
WERKZEUGE FÜR'S LEBEN

51598

STAHLWILLE

Quality

Chrome alloy steel.

51596

51597

HAZET

51597

	Total length mm	51596	...	51597	...	51598	...
	200	101		101		102	
	400	102		102		103	



51598

51600

Bi-hexagon socket wrench set



GEDORE

WERKZEUGE FÜR'S LEBEN
Quality
Vanadium 31CrV3.

51600



Set contents

- 10 bi-hex inserts with UD profile Sizes 36/41/46/50/55/60/65/70/75/80 mm
- 1 reversible ratchet
- 1 handle bar
- 1 sliding piece
- 2 extensions 200/400 mm

Set contents	Design	51600	...
15 pieces	in a sheet steel box		101

51603

Bi-hexagon socket wrench inserts DIN 3124/ISO 2725



GEDORE

WERKZEUGE FÜR'S LEBEN
Design
With UD profile. Chrome-plated, die-forged, with pin lock.

Quality
Vanadium 31CrV3.

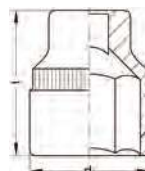

51603

Sizes mm	l mm	d ₁ mm	51603	...
36	70	53.9		203
41	70	60.1		204
46	75	66.4		205
50	75	71.4		206
55	78	77.6		207

Width mm	l mm	d ₁ mm	51603	...
60	83	83.9		208
65	86	90.1		209
70	90	96.4		210
75	93	102.6		211
80	95	108.9		212

51606

Reversible ratchet with handle bar DIN 3124/ISO 2725



GEDORE

WERKZEUGE FÜR'S LEBEN
Design
Chrome-plated, head finely sanded. Extremely robust ratchet with lever reverse for clockwise/anti-clockwise rotation, pin lock and locking in a central position. Angle of rotation 11.25°.

Quality
Vanadium 31CrV3.



51606

Total length mm	51606	...
810		201

51609

Drive elements



GEDORE

WERKZEUGE FÜR'S LEBEN
Design
Chrome-plated, die-forged.
Quality
Vanadium 31CrV3.

51609 101
Handle bar with sliding piece
Sliding piece with retaining ball.



51609 101

	Length mm	51609	...
Handle bar	700		101
1 inch adapter □ x 3/4 inch ■	75		102

51609 102



51612

Extensions



GEDORE

WERKZEUGE FÜR'S LEBEN
Design
Chrome-plated, die-forged.

Quality
Vanadium 31CrV3.

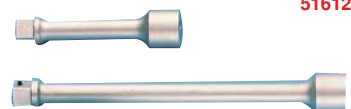

51612

Total length mm	51612	...
200		101
400		102

51614

Hexagon power screwdriver bits

1/4"



ASW

Design

Drive: 1/4 inch square DIN 3121 – G 6.3
Output: Hexagon socket DIN 475/2.

Quality

Made of chrome-vanadium special steel.

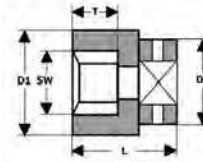

51614



Sizes mm	L mm	D ₁ mm	D ₂ mm	T min. mm	51614	...
6	23	10.0	13	2.4		106
7	23	11.3	13	2.8		107
8	23	12.5	13	3.5		108
10	23	15.0	13	4.2		110

Sizes mm	L mm	D ₁ mm	D ₂ mm	T min. mm	51614	...
11	23	16.3	13	4.9		111
12	23	17.0	13	5.6		112
13	23	18.8	13	5.6		113

51616

Hex power screwdriver inserts, with magnet

1/4"



ASW

Design

With strong permanent magnet.
Drive: 1/4 inch square DIN 3121 – G 6.3
Output: Hexagon socket DIN 475/2.

Quality

Made of chrome-vanadium special steel.

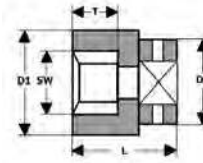

51616



Sizes mm	L mm	D ₁ mm	D ₂ mm	T min. mm	51616	...
5	23	8.8	13	1.7		101
5.5	23	9.5	13	2.1		102
6	23	10.0	13	2.4		103
7	23	11.3	13	2.8		104
8	23	12.5	13	3.5		105

Sizes mm	L mm	D ₁ mm	D ₂ mm	T min. mm	51616	...
9	23	13.8	13	3.5		106
10	23	15.0	13	4.2		107
11	23	16.3	13	4.9		108
13	23	18.8	13	5.6		109

51617

Hex power screwdriver inserts, long with magnet

1/4"



ASW

Design

Long design, with sprung magnet.
Drive: 1/4 inch square DIN 3121 – G 6.3
Output: Hexagon socket DIN 475/2

Quality

Made of chrome-vanadium special steel.

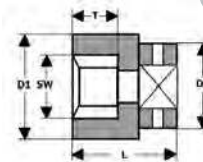

51617



Sizes mm	L mm	D ₁ mm	D ₂ mm	T min. mm	51617	...
7	50	11.3	13	2.8		101
8	50	12.5	13	3.5		102
10	50	15.0	13	4.2		103
13	50	18.8	13	5.6		104

51613

Power screwdriver joining tools

1/4"



ASW

Quality

Made of chrome-vanadium special steel.

51613 401

Design

With strong permanent magnet.
Drive: 1/4 inch square DIN 3121 – G
Output: 1/4 inch hexagon socket
DIN 3126 – D 6.3.

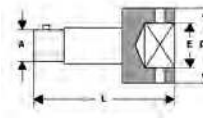

51613 301-302



51613 301-302

Design

Drive: 1/4 inch square DIN 3121 – G 6.3
Output: 1/4-inch square drive DIN 3121 – E – with
spring-loaded pin.

	E Inch	A Inch	D ₂ mm	L mm	51613	...
Extension	1/4	1/4	13	50		301
Extension	1/4	1/4	13	150		302
Bit holder	1/4	D 6.3	13	62		401

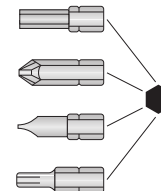

51613 401



51627

Power screwdriver connector

1/4"

ASW

Design

With quick-change holder.
Drive: 1/4 inch square DIN 3121 – G 6.3, Output:
Square drive DIN 3121 – with ball lock.

Quality

Made of chrome-vanadium special steel.

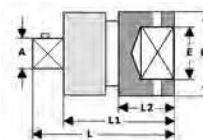

51627



E Inch	A Inch	D ₂ mm	L mm	L ₁ mm	L ₂ mm	51627	...
1/4	1/4	13	35	28	10		101

Power screwdriver tools

51615

Hexagon power screwdriver bits

3/8"



ASW

Design

Drive: 3/8 inch square DIN 3121 – G 10

Output: Hexagon socket DIN 475/2.

Quality

Made of chrome-vanadium special steel.

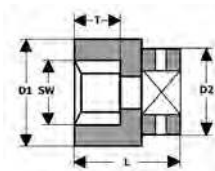

51615

Sizes mm	L mm	D ₁ mm	D ₂ mm	T min. mm	51615	...
8	30	14.0	19	3.5		203
10	30	16.0	19	4.2		205
11	30	17.5	19	4.9		206
12	30	19.0	19	5.6		207
13	30	20.0	22	5.6		208

Sizes mm	L mm	D ₁ mm	D ₂ mm	T min. mm	51615	...
14	30	21.0	22	7.0		209
15	30	22.0	22	7.0		210
16	30	24.0	22	7.0		211
17	30	25.0	22	7.0		212

51619

Hex power screwdriver inserts, with magnet

3/8"



ASW

Design

With strong permanent magnet.

Drive: 3/8 inch square DIN 3121 – G 10

Output: Hexagon socket DIN 475/2.

Quality

Made of chrome-vanadium special steel.

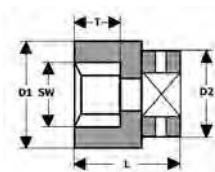

51619

Sizes mm	L mm	D ₁ mm	D ₂ mm	T min. mm	51619	...
8	30	14.0	19	3.0		101
9	30	15.0	19	3.5		102
10	30	16.0	19	4.2		103
11	30	17.5	19	4.9		104
13	30	20.0	22	5.6		106

Sizes mm	L mm	D ₁ mm	D ₂ mm	T min. mm	51619	...
14	30	21.0	22	6.0		107
15	30	22.0	22	6.0		108
16	30	24.0	22	6.0		109
17	30	25.0	22	6.0		110

51620

Hexagon socket power screwdriver bits

3/8"



ASW

Design

Drive: 3/8 inch square DIN 3121 – G 10

Output: Hexagon head DIN/ISO 2963

Quality

Made of chrome-vanadium special steel.

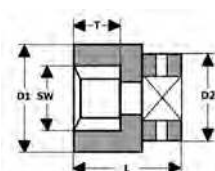

51620

Size mm	L mm	D ₂ mm	51620	...
5	50	19		101
6	50	19		102
8	50	19		103

Size mm	L mm	D ₂ mm	51620	...
10	50	19		104
12	50	19		105
14	50	19		106

51628

Internal TX® power screwdriver inserts

3/8"



ASW

Design

Drive: 3/8 inch square DIN 3121 – G 10

Output: TX for internal TX® screws.

Quality

Made of chrome-vanadium special steel.

Note:

TX® profile gauge, see art. no. 37930.

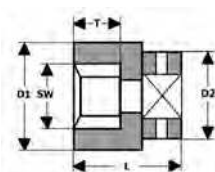

51628

Size T	L mm	D ₂ mm	51628	...
20	50	19		101
25	50	19		102
27	50	19		103

Size T	L mm	D ₂ mm	51628	...
30	50	19		104
40	50	19		105

51618

External TX® power screwdriver inserts



ASW

Design

Drive: 3/8 inch square DIN 3121 – G 10

Output: E-profile for all external TX® screws.

Quality

Made of chrome-vanadium special steel.

Note:

TX® profile gauge, see art. no. 37930.

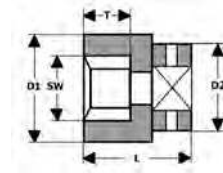

51618

Size	L	D ₁	D ₂	T	51618	...
E	mm	mm	mm	mm		
5	32	9.0	19	4.0		201
6	32	10.2	19	4.0		202
7	32	10.2	19	5.0		203
8	32	10.5	19	5.0		204

Size	L	D ₁	D ₂	T	51618	...
E	mm	mm	mm	mm		
10	32	12.5	19	6.0		205
12	32	14.9	19	8.0		206
14	32	17.2	19	9.0		207

51621

Power screwdriver joining tools



ASW

Quality

Made of chrome-vanadium special steel.

51621 101-302

Design

Drive: 3/8 inch square, DIN 3121 – G 10

Output: Square drive, DIN 3121 – E – with spring-loaded pin.

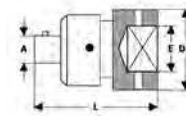

51621 101

51621 303

Design

Drive: 3/8 inch square, DIN 3121 – G 10

Output: 5/16 inch hexagon socket DIN 3126 – D 8.

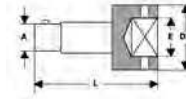

51621 201-203

51621 304

Design

Drive: 3/8 inch square, DIN 3121 – G 10

Output: 1/4 inch hexagon socket DIN 3126 – D 6.3.

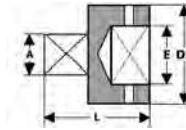

51621 301-302

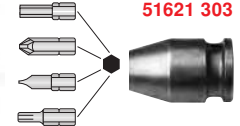
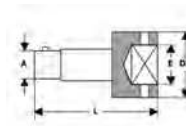

51621 303

	E	A	D ₂	L		51621	...
	Inch	Inch	mm	mm			
Ball joint	3/8	3/8	22	60			101
Extension	3/8	3/8	19	75	-		201
Extension	3/8	3/8	19	150	-		202
Extension	3/8	3/8	22	300	-		203
Adapter	3/8	1/4	19	32	-		301
Adapter	3/8	1/2	22	36	-		302
Bit holder	3/8	D 8	19	38	-		303
Bit holder with quick-change chuck	3/8	1/4	19	45	-		304
Rubber ring	-	-	19	-	10 pcs.		401
Rubber ring	-	-	22	-	10 pcs.		402
Locking pin	-	-	19	-	10 pcs.		501
Locking pin	-	-	22	-	10 pcs.		502



51621 304



51621 401-402



51621 501-502

51622

Power screwdriver connector



ASW

Design

With quick-change holder.

Drive: 3/8 inch square DIN 3121 – G 10,

Output: Square drive, DIN 3121 – with ball lock.

Quality

Made of chrome-vanadium special steel.

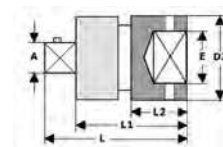

51622

E	A	D ₂	L	L ₁	L ₂	51622	...
Inch	Inch	mm	mm	mm	mm		
3/8	3/8	20	46	35	17		101

Power screwdriver tools

51623

Hex power screwdriver inserts, plastic-coated

1/2"



Design

Plastic-coated to prevent damage when working on aluminium rims.

Plastic sleeve can be removed if necessary (small distance between wheel nut or bolt and rim bore).

The different colours enables rapid differentiation of the width across flats.

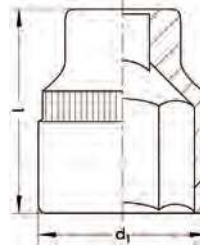

51623 101

Set contents	Size mm	Design	51623	...
3 pieces	17/19/21	in plastic box		101

Size mm	d ₁ mm	l mm	Torque max. Nm	Colour	51623	...
17	27	85	450	blue		201
19	29	85	550	yellow		202
21	31	85	550	red		203

51623 201



51623 202



51623 203



51623

Hex power screwdriver insert set, plastic-coated

1/2"



Design

- With plastic insert to protect the surfaces of the wheel bolts
- Plastic sleeve (replaceable) on the outside to protect the rims when attaching the wheel bolts
- Plastic sleeves are colour coded, for quick identification of the wrench size
- Long design
- With hole for locking pin or locking spring and groove for O-rings

Applications

Specially designed for wheel assembly and disassembly of aluminium rims.



51623 301

Set contents	Size mm	51623	...
3 pieces	17/19/21		301

Info

Pneumatic tools

Suitable pneumatic tools can be found starting on page 9.143



51624 - 51626

Hexagon power screwdriver bits



Drive: 1/2 inch square DIN 3121 – G 12.5
Output: Hexagon socket, DIN/ISO 691

Quality
Made of chrome-vanadium special steel.

51624 300

51626 400

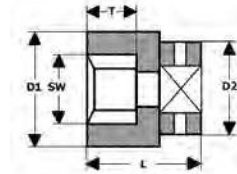

51624 203-220

51626 103-120

Hand tools

Set contents 51624 300	
○ 10	short hex inserts Sizes 9/10/11/13/14/17/19/22/24/27 mm
1	extension 1/2 inch x 175 mm
1	ball joint 1/2 inch x 74 mm

Set contents 51626 400	
○ 11	short hex inserts Sizes 10/13/14/16/17/18/19/21/22/24/27 mm
○ 9	long hex inserts Sizes 13/16/17/18/19/21/22/24/27 mm
1	wobble extension 1/2 inch x 150 mm

Set contents	Design	51624	...	51626	...
12 pieces	in plastic case			300	
21 pieces	in plastic case				400

Sizes mm	L mm	D ₁ mm	D ₂ mm	T min. mm	Short	
					51624	...
10	38	17.0	25	4.2		203
11	38	18.5	25	4.9		204
12	38	19.5	25	5.6		205
13	38	21.0	25	5.6		206
14	38	22.0	25	7.0		207
15	38	23.5	30	7.0		208
16	38	25.0	30	7.0		209
17	38	26.0	30	7.0		210
18	38	27.0	30	8.4		212
19	38	28.0	30	8.4		213
21	38	31.0	30	9.8		216
22	38	32.5	30	9.8		217
24	45	35.0	30	11.2		219
27	50	39.0	30	12.6		220

Sizes mm	L mm	D ₁ mm	D ₂ mm	T min. mm	Long	
					51626	...
10	78	17.5	25	4.2		103
13	78	21.0	25	5.6		106
14	78	22.5	25	7.0		107
15	78	23.5	30	7.0		108
16	78	25.0	30	7.0		109
17	78	26.0	30	7.0		110
18	78	27.5	30	8.4		112
19	78	28.7	30	8.4		113
21	78	31.0	30	9.8		116
22	78	32.0	30	9.8		117
24	78	35.0	30	11.2		119
27	78	38.5	30	12.6		120

51629

Hexagon socket power screwdriver bits



Drive: 1/2 inch square DIN 3121 – G 12.5
Output: Hexagon head DIN/ISO 2963

Quality
Made of chrome-vanadium special steel.

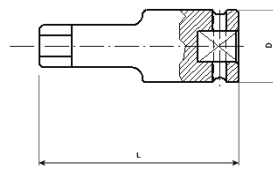

51629

Size mm	L mm	D ₂ mm	51629	...
5	55	25		101
6	55	25		102
8	55	25		103
10	55	25		104

Size mm	L mm	D ₂ mm	51629	...
12	55	25		105
14	55	25		106
17	55	25		107

51632

Internal TX® power screwdriver inserts



Drive: 1/2 inch square DIN 3121 – G 12.5
Output: TX for internal TX® screws.

Quality
Made of chrome-vanadium special steel.

Note:
TX® profile gauge, see art. no. 37930.

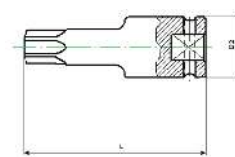

51632

Size T	L mm	D ₂ mm	51632	...
30	55	25		201
40	55	25		202
50	55	25		203

Size T	L mm	D ₂ mm	51632	...
55	55	25		204
60	55	25		205

Power screwdriver tools

51635

TX® power screwdriver inserts

1/2"



ASW
Design

Drive: 1/2 inch square DIN 3121 – G 12.5
Output: E-profile for external TX® screws.

Quality
Made of chrome-vanadium special steel.

Note:
TX® profile gauge, see art. no. 37930.

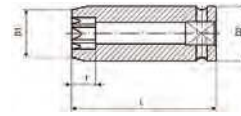

Size E	L mm	D ₁ mm	D ₂ mm	T mm	51635 ...
10	38	15.0	25	7.0	101
12	38	16.0	25	8.0	102
14	38	18.5	25	9.0	103
16	38	20.0	25	10.0	104

Size E	L mm	D ₁ mm	D ₂ mm	T mm	51635 ...
18	38	22.0	25	11.0	105
20	38	25.0	30	12.5	106
24	45	30.0	30	14.0	107

51638

Power screwdriver joining tools

1/2"

ASW
Quality

Made of chrome-vanadium special steel.

51638 201-304

Design
Drive: 1/2 inch square, DIN 3121 – G 12.5
Output: Square drive, DIN 3121 – E – with spring-loaded pin.

51638 401

Design
Drive: 1/2 inch square, DIN 3121 – G 12.5
Output: 1/4 inch hexagon socket DIN 3126 – D 6.3.

51638 402

Design
Drive: 1/2 inch square, DIN 3121 – G 12.5
Output: 5/16 inch hexagon socket DIN 3126 – D 8.

51638 403

Design
Drive: 1/2 inch square, DIN 3121 – G 12.5
Output: Square drive, DIN 3121 – E – with spring-loaded pin.

51638 404

Design
Drive: 1/2 inch square, DIN 3121 – G 12.5
Drive: Square drive, DIN 3121 – F – with full length pin hole.

	E Inch	A Inch	D ₂ mm	L mm		51638 ...
Ball joint	1/2	1/2	25	68	-	201
Extension	1/2	1/2	25	75	-	301
Extension	1/2	1/2	25	125	-	302
Extension	1/2	1/2	25	250	-	304
Bit holder	1/2	D 6.3	25	40	-	401
Bit holder	1/2	D 8	25	40	-	402
Adapter	1/2	3/8	25	38	-	403
Adapter	1/2	3/4	30	48	-	404
Rubber ring	-	-	25	-	10 pcs.	501
Rubber ring	-	-	30	-	10 pcs.	502
Locking pin	-	-	25	-	10 pcs.	601
Locking pin	-	-	30	-	10 pcs.	602

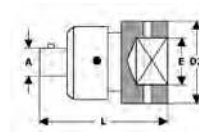

51638 201

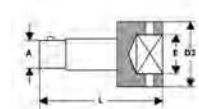

51638 301-304

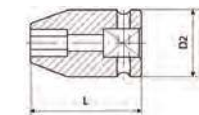

51638 401-402

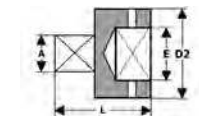
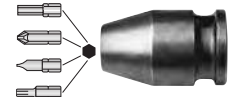

51638 403-404



51638 501-502



51638 601-602



51639

Power screwdriver connector

1/2"

ASW
Design

With quick-change holder
Drive: 1/2 inch square, DIN 3121 – G 12.5
Output: Square drive, DIN 3121 – with ball lock.

Quality
Made of chrome-vanadium special steel.

E Inch	A Inch	D ₂ mm	L mm	L ₁ mm	L ₂ mm	51639 ...
1/2	1/2	25	60	44	24	101

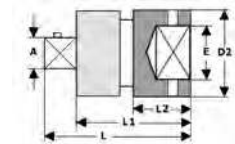

51641 - 51643

Hexagon power screwdriver bits



ASW
Design

Drive: 3/4 inch square DIN 3121 – H 20
Output: Hexagon socket, DIN/ISO 691

Quality
Made of chrome-vanadium special steel.

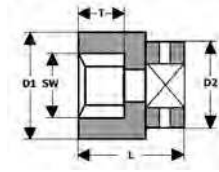

Sizes mm	L mm	D ₁ mm	D ₂ mm	T min. mm	Short	
					51641	...
17	50	31.0	44	7.0		202
18	50	32.0	44	8.4		203
19	50	33.0	44	8.4		204
22	50	37.0	44	9.8		207
24	50	39.0	44	11.2		209
27	54	43.0	44	12.6		212
30	54	47.0	44	14.0		215
32	56	49.0	44	15.4		216
33	56	51.0	44	15.4		217
34	56	52.0	44	15.4		218
36	56	54.0	44	16.8		220
38	58	57.0	44	18.9		221
41	58	60.0	44	18.9		223
46	63	67.0	44	21.0		224

Sizes mm	L mm	D ₁ mm	D ₂ mm	T min. mm	Long	
					51643	...
17	95	31	44	7.0		102
18	95	32	44	8.4		103
19	95	33	44	8.4		104
22	95	37	44	9.8		107
24	95	39	44	11.2		109
27	95	43	44	12.6		112
30	95	47	44	14.0		115
32	95	49	44	15.4		116
33	95	51	44	15.4		117
34	95	52	44	15.4		118
36	95	54	44	16.8		120

51644

Hexagon socket power screwdriver bits



ASW
Design

Drive: 3/4 inch square DIN 3121 – H 20
Output: Hexagon head DIN/ISO 2963

Quality
Made of chrome-vanadium special steel.

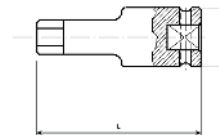

Size mm	L mm	D ₂ mm	51644	...
14	62	44		101
17	62	44		102
19	62	44		103

Size mm	L mm	D ₂ mm	51644	...
22	62	44		104
24	62	44		105
27	62	44		106

51646

Power screwdriver joining tools



ASW
Design

Drive: 3/4 inch square, DIN 3121 – H 20
Output: Square drive, DIN 3121 – F – with full length pin hole.

Quality
Made of chrome-vanadium special steel.

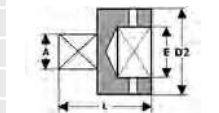
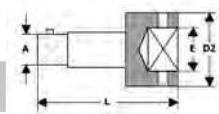
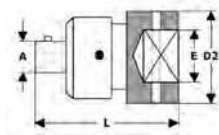

	E Inch	A Inch	D ₂ mm	L mm		51646	...
Ball joint	3/4	3/4	44	90	-		201
Extension	3/4	3/4	44	175	-		301
Extension	3/4	3/4	44	250	-		302
Extension	3/4	3/4	44	330	-		303
Adapter	3/4	1/2	44	57	-		401
Adapter	3/4	1	44	63	-		403
Rubber ring	-	-	44	-	10 pcs.		501
Locking pin	-	-	44	-	10 pcs.		601

51647

Power screwdriver connector



ASW
Design

With quick-change holder.
Drive: 3/4 inch square DIN 3121 – H 20,
Output: Square drive DIN 3121 – with ball lock.

Quality
Made of chrome-vanadium special steel.

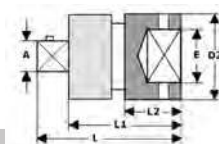

E Inch	A Inch	D ₂ mm	L mm	L ₁ mm	L ₂ mm	51647	...
3/4	3/4	44	78	56	30		101

Hand tools

51649 - 51651 Hexagon power screwdriver bits



ASW
Design

Drive: 1 inch square DIN 3121 – H 25
Output: Hexagon socket, DIN/ISO 691

Quality
Made of chrome-vanadium special steel.

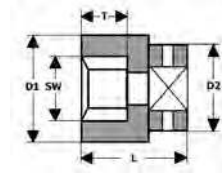

51649



51651



Long

51651

Sizes mm	L mm	D ₁ mm	D ₂ mm	T min. mm	Short	
					51649	...
22	58	40	54	9.8		103
24	58	42	54	11.2		105
27	58	46	54	12.6		106
30	60	50	54	14.0		109
32	60	52	54	15.4		110
33	60	53	54	15.4		111
34	62	55	54	15.4		112
36	65	56	54	16.8		113
38	65	59	54	18.9		114
41	67	63	54	18.9		116
46	74	69.5	54	21.0		118
50	80	74	54	23.1		119
55	84	81	54	25.2		120
60	87	87	54	27.3		121
65	90	93	54	29.4		122
70	96	100	54	31.5		123
75	98	104	86	33.6		124
80	100	109	86	36.4		125

Sizes mm	L mm	D ₁ mm	D ₂ mm	T min. mm	Long	
					51651	...
22	100	40	54	9.8		103
24	100	42	54	11.2		105
27	100	46	54	12.6		106
30	100	50	54	14.0		109
32	100	52	54	15.4		110
33	100	53	54	15.4		111
34	100	55	54	15.4		112
36	100	57	54	16.8		113
38	100	59.5	54	18.9		114
41	100	64	54	18.9		116
46	100	69.5	54	21.0		118

51652 Power screwdriver joining tools



ASW
Design

Drive: 1 inch square, DIN 3121 – H 25
Output: Square drive, DIN 3121 – F – with full length pin hole.

Quality
Made of chrome-vanadium special steel.

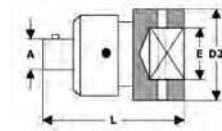

51652 101



51652 201-203

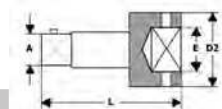

51652 301

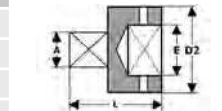

51652 401



51652 501



	E Inch	A Inch	D ₂ mm	L mm		51652	...
Ball joint	1	1	54	110	-		101
Extension	1	1	54	175	-		201
Extension	1	1	54	250	-		202
Extension	1	1	54	330	-		203
Adapter	1	3/4	54	75	-		301
Rubber ring	-	-	54	-	10 pcs.		401
Locking pin	-	-	54	-	10 pcs.		501

51653 Power screwdriver connector



ASW
Design

With quick-change holder.
Drive: 1 inch square DIN 3121 – H 25,
Output: Square drive DIN 3121 – with ball lock.

Quality
Made of chrome-vanadium special steel.

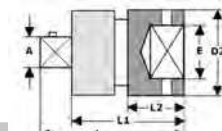

51653



E Inch	A Inch	D ₂ mm	L mm	L ₁ mm	L ₂ mm	51653	...
1	1	54	100	74	40		101

Info

Special tools according to drawings, samples or sketches

ASW

ASW offers one of the most extensive ranges of impact socket wrenches in Europe. It also offers special solutions for special customer requirements. These are also produced by ASW in very small quantities according to drawings, samples or sketches.

- ASW represents
- Excellent quality
 - Long service life
 - Excellent value for money



ASW – Driven by Quality