

21864

Coolant tubes

DIN
69893**ATORN®****Applications**

To optimise central coolant supply in hollow shank tapers in accordance with DIN 69893-HSK-A/E.

HSK	D	d	L	21864	...
		mm	mm		
32	M10 x 1	6	25.7		201
40	M12 x 1	8	29.2		202
50	M16 x 1	10	32.7		203
63	M18 x 1	12	36.2		204
80	M20 x 1.5	14	39.7		205
100	M24 x 1.5	16	43.6		206

NEW



21864

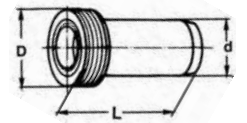

21865

Key for coolant tubes

DIN
69893**ATORN®****Applications**

For coolant tube art. no. 21864.

HSK	L	21865	...
	mm		
32	115		201
40	115		202
50	115		203
63	122		204
80	136		205
100	141		206

NEW



21865

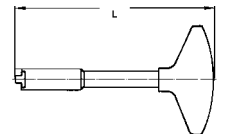

Info

Multi-spindle heads for drilling, thread cutting, countersinking, reaming, milling, turning etc.

Multi-spindle drilling heads with a fixed drill pattern for machining centres with or without automatic tool changes. For the use of solid carbide tools with speeds up to 12,000 rpm with or without coolant supply.

**Type SMSK 6/15**

With 6 spindles and a maximum drilling capacity of 15 mm per spindle. Spindle head in accordance with DIN 55058 for adjustment sleeve size 20. Special holder with collet chuck holder for high rotation speeds when using solid-carbide drills or solid-carbide tools. Multi-spindle head mount, steep taper 50 with grip lock for machining centres.

Type SMSK 2/15

Steep taper mount 40 with continuous coolant supply, tapping chuck with length compensation under compression and tension.

Type KE

Characterised by simple and quick adjustment. Very sturdy construction, large adjustment range, narrowest spindle intervals, low weight, long service life, also suitable for smaller series in a medium tolerance range. Multi-spindle heads with drill patterns adjustable by replacing the spindle mount plate (matrix).

Type SMSK 4/15

Drilling performance of 15 mm per spindle or thread cutting performance of M 12. Spindle head in accordance with DIN 55058 for adjustment sleeve size 20. Quick-change thread-cutting chuck with tension and compression length compensation and spring-mounted countersink sleeve for chamfering the bore. Multi-spindle head mount, steep taper 50 with grip lock for machining centres. Multi-spindle head, easily adjustable, deliverable with two, three or four spindles, max. drilling performance per spindle of 3 mm to 32 mm depending on type.

Type KR

Featuring jointed spindles with high concentricity, good bearing stability and minimal spindle intervals. Simple alteration of drilling patterns and absolute dimensional accuracy thanks to spindle mount plates (matrices) produced in the co-ordinate system, large adjustment range of individual types up to 530 mm, max drilling capacity up to 40 mm in steel.

Please contact us! For the best possible advice, please add a dimensioned drawing of the drilling patterns.