



# PNEUMATIC SUPER HI-PRESSURE VISE

## Model: HBV-4"G, 5"G, 6"G



- High-Force Cylinders hardly malfunction
- Fixed Height so several vises can be used together

### STANDARD ACCESSORIES:

- 2 pcs of Alignment Wedge
- 4 pcs of Clamp
- 1 pc of Wrench



- Special **High-Force Cylinders** are designed to enhance clamping force of 0-6000kg and can be adjusted depends on the material of work-piece.
- Vise body is made of Ductile Iron above FCD 60 grade for high precision and durability.
- Slide ways are **HARDENED** to **HRC 50°** to further increase durability and maintain positioning height over long use.
- The special **ANGLE-LOCK SYSTEM** with compact design for high rigidity automatically pulls the work-piece down to the accurate position.
- **High-Force Cylinders** hardly malfunction.
- Special **safety device** to ensure the vise holds clamping force 20 minutes if the air supply is cut.
- Safety range is **4-4.5 mm**.



Pneumatic power source 6kg/cm²

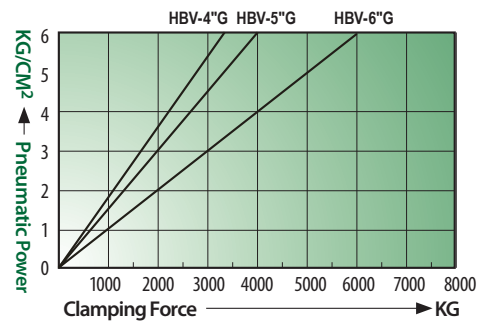

## DIMENSIONS

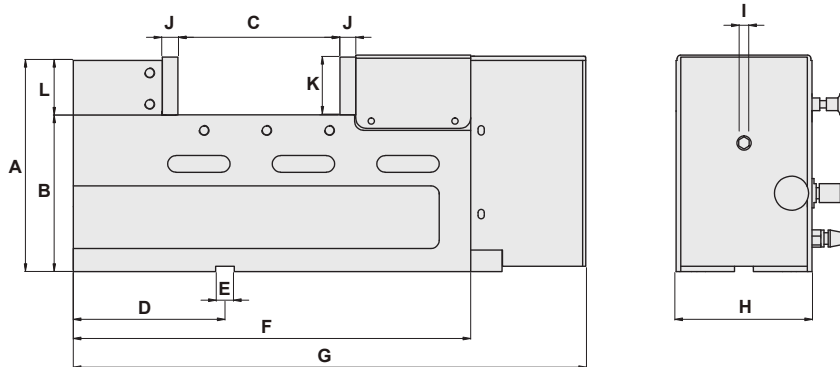

## SPECIFICATIONS (Material: FCD 60 ductile Iron. Hardness: HRC50°)

Unit: mm

Model	A	B	C	D	E	F	G	H	I
HBV-4''G	195	150±0.01	0 - 105	145	18	325	435	102	10
HBV-5''G	202	150±0.01	0 - 185	145	18	390	490	130	10
HBV-6''G	205	150±0.01	0 - 220	145	18	440	550	161	10
Model	J	K	L	Max. Clamping Force		Safety Range		Weight (kg)	
HBV-4''G	15	48	45	0-3000 kg		4 mm		37	
HBV-5''G	15	55	52	0-4000 kg		4 mm		50	
HBV-6''G	15	58	55	0-4000 kg		4 mm		70	



# PNEUMATIC DOUBLE SUPER HI-PRESSURE VISE

## Model: ND-4"G, 5"G



- High-Force Cylinders hardly malfunction
- Fixed Height so several vises can be used together

### STANDARD ACCESSORIES:

- 2 pcs of Alignment Wedge
- 4 pcs of Clamp
- 1 pc of Wrench

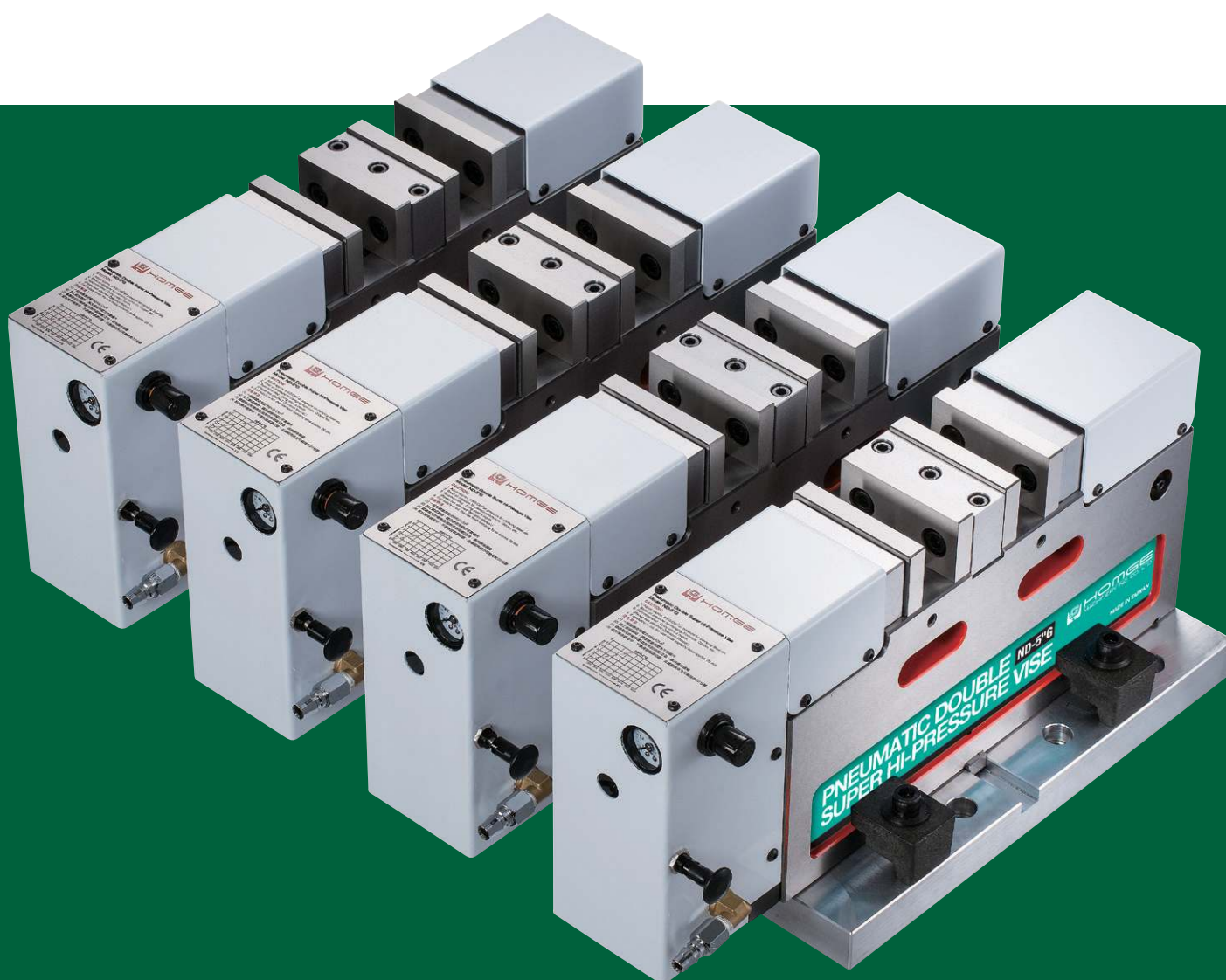

- The vise can hold 2 workpieces of different sizes. Allows an extra tolerance of up to 2 mm in workpieces.
- Special High-Force Cylinders are designed to enhance clamping force of 0-4000kg and can be adjusted depends on the material of work-piece.
- Vise body is made of Ductile Iron above FCD 60 grade for high precision and durability. Slide ways are HARDENED to HRC 50° to further increase durability and maintain positioning height over long use.
- Pressure Adjusting Knob: for quick operations.
- High-Force Cylinders hardly malfunction.
- Special safety device to ensure the vise holds clamping force 20 minutes if the air supply is cut.
- Safety range is 4 mm.



Pneumatic power source 6kg/cm²

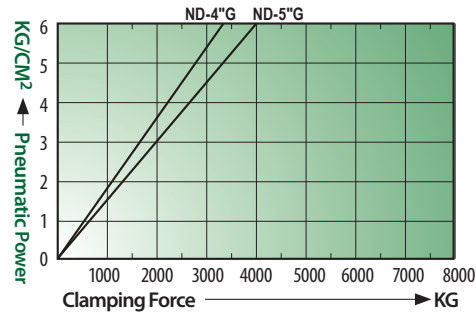

## DIMENSIONS

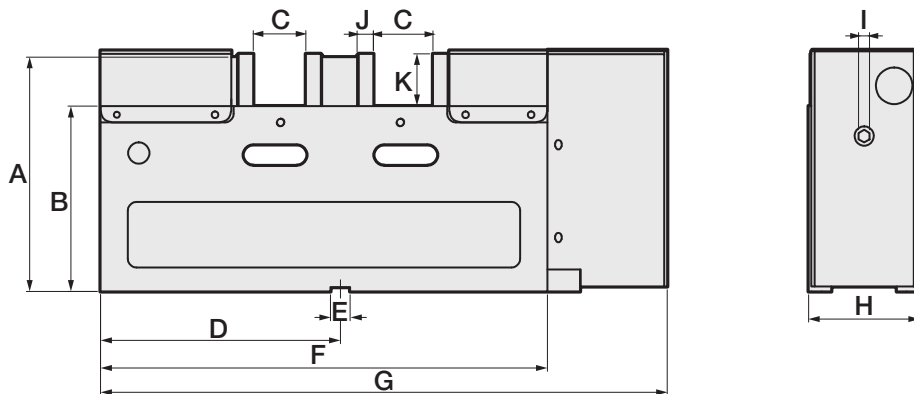

## SPECIFICATIONS (Material: FCD 60 ductile Iron. Hardness: HRC50°)

Unit: mm

Model	A	B	C	D	E	F	G	H	I
ND-4"G	195	150±0.01	0-50	220±0.02	18	410	520	102	10
ND-5"G	202	150±0.01	0-115	280±0.02	18	530	630	130	10
Model	J	K	Max. Clamping Force			Safety Range		Weight (kg)	
ND-4"G	15	48	0-3300 kg			4 mm		45	
ND-5"G	15	55	0-4000 kg			4 mm		65	